



Quick Reference Guide

Last updated May 10, 2012 | For additional information please contact the resort directly

Four Seasons Palm Beach
2800 South Ocean Boulevard, Palm Beach, Florida, 33480, U.S.A.
Tel 1.561.582.2800 | Fax 1.561.547.1557

www.fourseasons.com/palmbeach

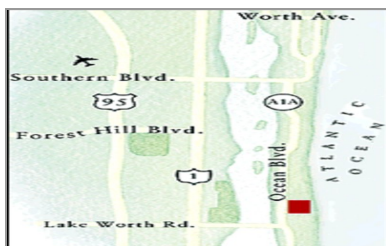

2800 South Ocean Boulevard
Palm Beach, Florida 33480, U.S.A.
Tel 1.561.582.2800
Fax 1.561.547.1557

AIRPORT

- Palm Beach International Airport,
West Palm Beach (PBI): 20 minutes
(10 miles/16 kilometres)

TABLE OF CONTENTS

- 2 *Introduction*
- 4 *Destination*
- 9 *Conference Facilities*
- 19 *Guest rooms, Suites and
Private Residences*
- 25 *Dining*
- 26 *Recreational Facilities*
- 28 *Incentive Activities*
- 30 *Appendix: Conference Chart*
Appendix: Golf Scorecard

On South Florida's finest sweep of sun-splashed beach, Four Seasons offers a haven of easy tropical elegance – graced by silken sand, gently swaying palms and the sparkling Atlantic. Moments away are challenging golf courses, one of the world's most dazzling shopping streets and all the cultural delights of Palm Beach society.



The ultimate in comfortable chic, Four Seasons Resort Palm Beach is one of the most celebrated gathering spots in this fabled Florida community.

Set on 6 acres (2.4 hectares) of prime oceanfront property, dense with tropical gardens, the Resort offers an ambience of soft, understated sophistication. In the lobby, stately columns of textured stone rise above cream and tan marble floors, exquisite furnishings and artefacts from around the world.

All of the 210 oversized guest rooms and suites open to private balconies. Dining choices include one of the finest restaurants in Florida. For social or business gatherings – from 25 to 400 guests – settings are both dramatic and versatile. When it's time to relax, recreation amenities include tennis, swimming, a motivating fitness centre and an expansive full-service spa.

Whether the occasion calls for a secretary or a babysitter, resourceful Four Seasons Concierge staff are always on hand to provide solutions.

TRANSPORTATION

Palm Beach International Airport is about 15 minutes from the Resort and is serviced by Air Canada (seasonal), American Airlines, Bahamasair, Com-Air, Continental, Delta, Jet Blue, AirTran, Song, Northwest, Southwest, Spirit, United, and US Airways.

The Fort Lauderdale and Miami International Airports are also nearby. All major car rental firms operate at the airports, and taxi and limousine service are also available, with easy access to major highways and the Florida Turnpike.

WEATHER CHART

Month	°F		°C	
	Highs/Lows	Highs/Lows	Highs/Lows	Highs/Lows
January	80	/ 70	26	/ 21
February	80	/ 65	26	/ 18
March	80	/ 70	26	/ 21
April	85	/ 75	30	/ 24
May	85	/ 75	30	/ 24
June	90	/ 75	32	/ 24
July	95	/ 80	35	/ 26
August	95	/ 80	35	/ 26
September	95	/ 80	35	/ 26
October	85	/ 75	30	/ 24
November	80	/ 75	26	/ 24
December	80	/ 70	26	/ 21

DESTINATION

Palm Beach is the destination of choice for many of the world's elite, and all of the community's most alluring incentives are within minutes of Four Seasons.

The Town of Palm Beach is set on a narrow island nestled between the Atlantic Ocean and the Intracoastal Waterway. The town covers an area 14 miles (22 kilometres) long and only half a mile (less than a kilometre) wide.

Palm Beach history dates back to the early 1890s, when Henry Morrison Flagler – a partner in Standard Oil with John D. Rockefeller – visited the sandy island and decided to build a great hotel. To make it easily accessible, he committed to extending his Florida East Coast Railroad south to Lake Worth. The town quickly became established as a luxury residential and resort enclave – with a population that now varies from 19,000 to 40,000, depending on the season.

The focal point is Worth Avenue – lined with designer boutiques, restaurants and galleries, and known as one of world's most prestigious shopping streets.

Beyond beautiful year-round weather, Palm Beach attractions include distinctive architecture; a winter social season; spectator sports such as jai alai, polo and spring-training baseball; and inspiring settings for golf and tennis.

WEATHER

Palm Beach enjoys a tropical climate with long, warm summers and short, mild winters with lots of sunshine.

LOCAL ATTRACTIONS AND ACTIVITIES

At Four Seasons, you enjoy a unique vantage point from which to explore the sights, sounds and experiences around you. We hope the highlights of local attractions below help simplify your planning. Please let us know how else we can assist you.

Within a 5-minute drive of the Resort

Florida Stage:

- Features plays that are thought-provoking, issue-oriented and enormously theatrical, in an intimate setting.

Within a 15-minute drive of the Resort

Palm Beach Zoo at Dreher Park:

- The Palm Beach Zoo at Dreher Park is a 22-acre (9-hectare) tropical zoological garden, home to more than 500 animals. The park includes a nature trail and tropical gardens.

Worth Avenue:

- Worth Avenue comprises four blocks of 200 exclusive shops including Gucci, Chanel, Salvatore Ferragamo, Fendi, Calvin Klein, Saks Fifth Avenue, Tiffany & Co., Giorgio Armani and more. The Avenue also boasts gourmet restaurants and renowned art galleries in a Mediterranean-style setting.

Wally Findlay Galleries:

- Features 19th- and 20th-century masters, as well as contemporary artists.

Gasiunasen Galleries:

- Features the works of modern and contemporary masters, including Botero, Dine and Warhol.

Phillips Galleries:

- Specialising in original paintings and lithographs by contemporary French artists.

Russeck Gallery:

- Features works by Appel, Botero, Chagall, Lichtenstein, Magritte, Matisse, Miro, Picasso and Warhol.

Antique Row:

- This district offers a selection of antique stores ranging from classic to retro design.

Within a 20-minute drive of the Resort

Raymond F. Kravis Center for the Performing Arts:

- Palm Beach's premiere centre for the performing arts. Performances include opera, ballet and comedy, by some of the most famous artists in the world. Also features Cafeteatro, the Kravis's own restaurant.

Henry Morrison Flagler Museum (Whitehall Mansion):

- Whitehall, the winter estate of Henry Morrison and Mary Lily Flagler, is a National Historic Landmark and one of America's great Gilded Age houses. The Beaux Arts-style mansion, completed in 1902, features original furnishings and artwork in its period rooms. Special exhibits highlight the history of the Flaglers and the Gilded Age. Visitors can also tour the Flaglers' private rail car on the site. The museum offers an annual series of special programs, including lectures, concerts and holiday events.

Norton Museum of Art:

- The Norton Museum of Art is one of the finest art museums in the country, with a permanent collection of French Impressionist and Post-Impressionist works, American art and a Chinese collection.

Palm Beach Kennel Club:

- The Palm Beach Kennel Club offers greyhound racing.

The Society of the Four Arts:

- The Society of the Four Arts was founded in 1936 by a group of Palm Beach residents. Its objective is to encourage an appreciation of art, music, drama and literature. The original building on Four Arts Plaza houses The Four Arts Library. The Gallery building contains galleries and an auditorium to accommodate art exhibitions, concerts, lectures and films. Horticultural gardens and the Philip Hulitar Sculpture Garden are also part of the lakeside complex.

Palm Beach Opera:

- The Palm Beach Opera performs three grand opera productions each season at the Raymond F. Kravis Center for the Performing Arts.

CityPlace:

- Cityplace features Macy's, Barnes and Noble, Cheesecake Factory and Legal Seafood, as well as many other specialty stores, boutiques and restaurants.

Improv Comedy Club:

- Comic club and café featuring movie, television and stage headline performers.

Cuillo Centre for the Arts:

- Intimate 360-seat stage theatre located in the centre of downtown West Palm Beach.

Within a 25-minute drive of the Resort

Delray Beach Tennis Center:

- Delray Beach Tennis Center hosts the Woman's Legends Tour in December and the Men's Nuveen Tour in February/March.

Within a 30-minute drive of the Resort

Town Center at Boca Raton:

- The Town Center at Boca Raton features Nordstrom and Neiman Marcus, Bloomingdale's, Saks Fifth Avenue and Macy's.

Boca Raton Museum of Art:

- The Boca Raton Museum of Art hosts national and international exhibitions, which change every four to six weeks.

Scuba Diving:

- Reefs, crevices, ledges and wrecks line the area beaches, perfect for scuba diving. Water temperatures range from 78 to 84°F (26 to 29°C) in the summer and 70 to 78°F (21 to 26°C) in the winter. There are numerous dive companies in the area, about 20–30 minutes away from the Resort.

Deep Sea Fishing:

- Marinas, ranging from 5 to 30 minutes from the Resort, offer fishing or sightseeing boating tours.

Lion Country Safari:

- See more than 1,200 wild animals from around the world, some of which are considered endangered.

Rapids Water Park:

- Open from mid-March through mid-October, the park is fully staffed with lifeguards to ensure safe fun for everyone. Height and weight restrictions apply to certain rides.

Boomer's Family Recreation Center:

- Go-karts, miniature golf, pool table, snack bar, air hockey, indoor rock-climbing and laser tag.

International Polo Club Palm Beach:

- International Polo Club Palm Beach is located in the heart of South Florida's horse country, and is the world headquarters for polo. Polo players and fans gather together for the love of the sport and the lifestyle.

Cruzan Amphitheatre:

- Offers both lawn and covered seating for popular touring music acts; 20,000 capacity.

Morikami Museum and Japanese Gardens:

- Celebrate Japanese culture at the Morikami Museum and Japanese Gardens, featuring rotating exhibitions, educational outreach programs for local schools and organisations and monthly tea ceremonies in the Seishin-an tea house.

Within a 35-minute drive of the Resort

The Gardens:

- The Garden's Mall features Saks Fifth Avenue, Bloomingdales and Macys.

Within a 45-minute drive of the Resort

Jupiter Inlet Lighthouse:

- Built on an ancient Native American mound of oyster shells, the distinctive red tower is one of the most recognised sights on the Florida coast. Although the beacon is now fully automated, the original lens is still in place. Jupiter Inlet Lighthouse has been placed on the National Register of Historic Sites.

Roger Dean Stadium:

- Spring training venue for Major League Baseball's Florida Marlins and St. Louis Cardinals.

Dania Jai-Alai:

- The 220,000-square-foot (20,440-square-metre) jai-alai fronton has comfortable seating for 5,600, as well as a poker room, simulcast betting facility, restaurants, banquet facilities, bars and snack bars.

Within a 1-hour drive of the Resort

Loxahatchee Everglades Tour:

- Loxahatchee Everglades Tour leads an airboat ride through the Everglades.

Bank Atlantic Center:

- Home of the National Hockey League's Florida Panthers.

Gulfstream Park:

- Gulfstream Park offers horse racing from January through March.

Within a 1.5-hour drive of the Resort

Dolphin Stadium:

- Home of the National Football League's Miami Dolphins and Major League Baseball's Florida Marlins.

American Airlines Arena:

- Home of the National Basketball Association's Miami Heat.

Eagle Nest Tours:

- An intimate and personalised airboat tour of the Everglades.

CONFERENCE FACILITIES OVERVIEW

Total Space	22,012 sq.ft. 2,043 m ²
Largest Ballroom	6,000 sq.ft. 557 m ²
Meet and Feed (max. capacity)	165
Breakouts	10
Banquet (max. capacity)	380
Outdoor Banquet (max. capacity)	250
Private Dining (max. capacity)	12

CONFERENCE FACILITIES

An exclusive oceanfront meeting place, Four Seasons offers relaxed Palm Beach elegance and flawless service. Ideal for gatherings of 25 to 600 guests, the Resort includes 22,012 square feet (2,043 square metres) of function facilities set apart in a private, distraction-free environment on the second floor.

Two 6,000-square-foot (557-square-metre) ballrooms each feature sunlit pre-function space. Versatility is a key characteristic of the ballrooms: The Royal Poinciana is divisible into thirds, while the Flagler can be divided into six distinct salons or breakout rooms.

For smaller gatherings, the Resort features four function rooms and an executive boardroom – supported by state-of-the-art audiovisual systems and an on-site technical team.

Conference level one

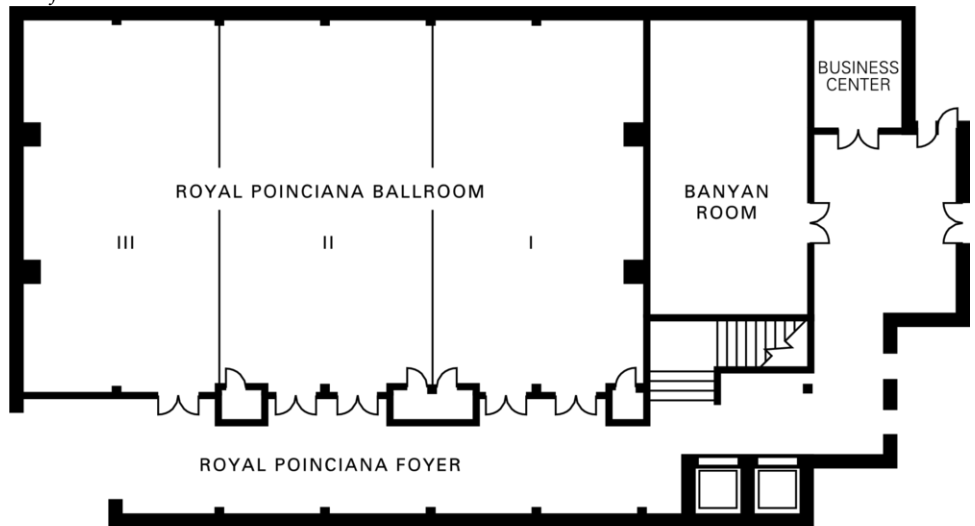

Conference level two

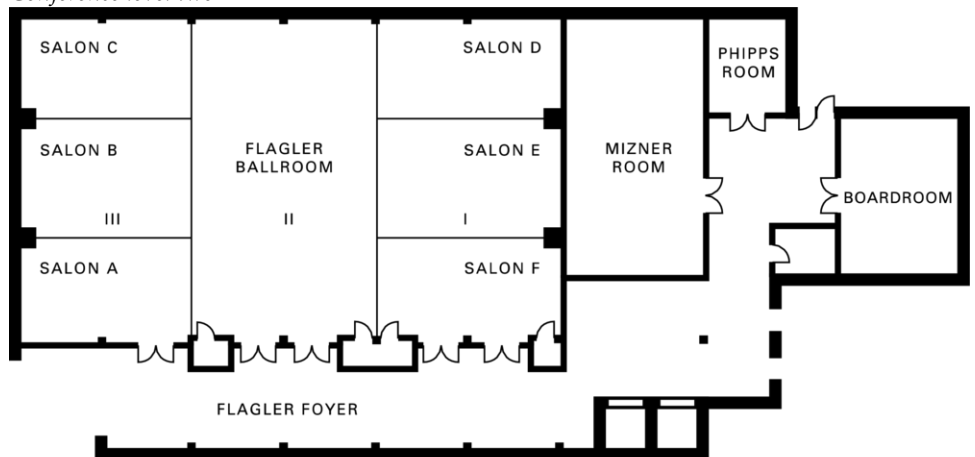

TECHNICAL ASSISTANCE

State-of-the-art audiovisual equipment includes:

- Lecterns with light and sound control
- Overhead projectors, data projector, slide projectors
- Multi-image dissolve units and programmers
- Screens and drape kits
- Video and audio equipment
- Microphones, mixers, amplifiers
- Audio cassette players, CD players, reel-to-reel players
- Stands, carts, easels, flipcharts, laser pointer, speaker timer
- Walkie-talkies
- Wired or wireless Internet access in meeting rooms

MUSIC AND ENTERTAINMENT

Our Conference Service Manager will be happy to assist with setting up any type of music or entertainment for your meeting.

RECEIVING AND MAINTENANCE

The Resort features a full-service shipping and receiving office. All packages should be sent to the attention of a group's name and its Conference Service Manager. They will be stored in a separate conference storage area. Limited space is available for the storage of large items. Please time shipping to the date of your arrival.

Receiving dock

Please contact the Receiving Department or your Conference Service Manager to arrange for delivery of oversized packages or environmentally sensitive equipment.

Post-conference shipping

Shipping of post-conference materials may be co-ordinated through your Conference Service Manager.

Maintenance

The Engineering Department is available 24 hours a day for general assistance with lighting, room temperature control and minor repairs.

BUSINESS SERVICES

Set the agenda for a successful event in Palm Beach, with the support of experienced, intuitive service dedicated to your every need.

- 24-hour business services
- Audiovisual equipment
- Computers
- Wired or wireless Internet access in meeting rooms

SPOUSE PROGRAMMES

Four Seasons Resort Palm Beach has a number of activities to interest spouses of meeting participants:

- Outings to local points of interest
- Sight-seeing cruise
- Spouse orientation
- Worth Avenue fashion show
- Henry M. Flagler Museum tour

- Palm Beach art tour
- Hotel kitchen and herb garden tour
- Chef's private cooking demonstration
- Fitness/spa treatments
- Tour of Palm Beach
- Everglades tour
- Shopping excursion

CHILDRENS AND FAMILY PROGRAMMES

We would be pleased to help arrange appropriate activities for visiting families.

Some activities may include (reservations and applicable fees may apply):

- Fishing
- On Command interactive television
- Pay-per-view movie rentals
- Sea turtle watching
- Tennis
- Water-sport activities

ROYAL POINCIANA BALLROOM

Dimensions	100 x 60 ft
	30.5 x 18.3 m
Size	6,000 sq.ft.
	557 m ²
Height	11.7 ft
	3.6 m

Capacities

Classroom	312
Hollow square	120
U Shape	84
Theatre	396
Reception	396
Banquet Rounds	370

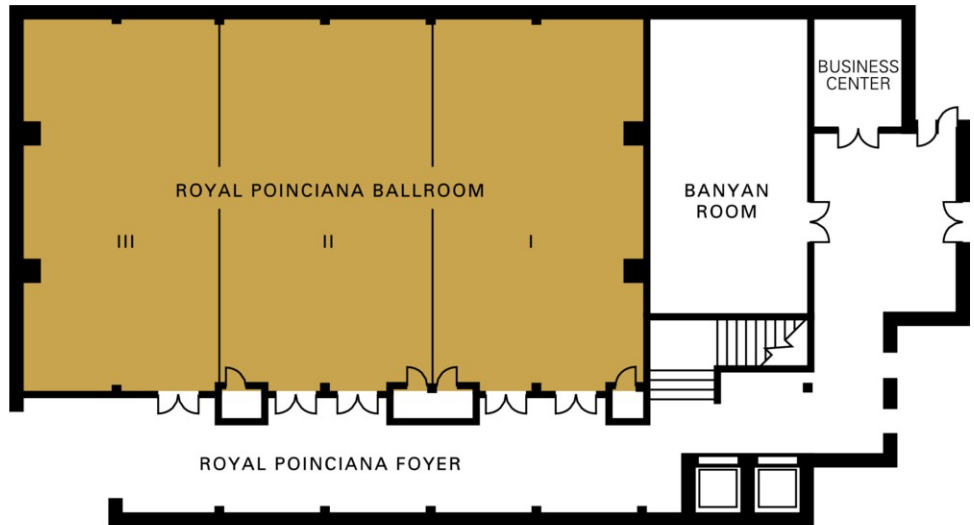

ROYAL POINCIANA BALLROOM I

Dimensions	60 x 33 ft
	18.3 x 10.1 m
Size	1,980 sq.ft.
	184 m ²
Height	11.7 ft
	3.6 m

Capacities

Classroom	96
Hollow square	60
U Shape	48
Theatre	132
Reception	175
Banquet Rounds	120

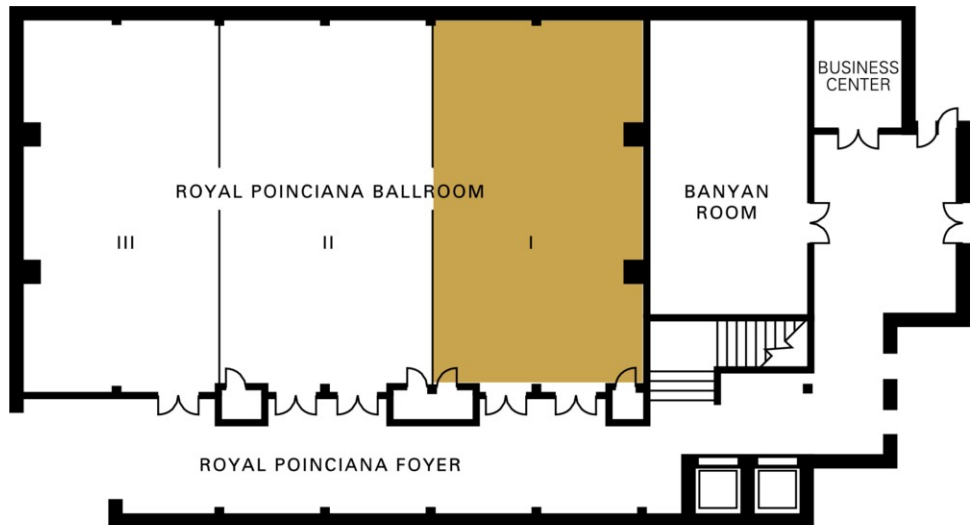

ROYAL POINCIANA BALLROOM II

Dimensions	60 x 33 ft
	18.3 x 10.1 m
Size	1,980 sq.ft.
	184 m ²
Height	11.7 ft
	3.6 m

Capacities

Classroom	96
Hollow square	60
U Shape	48
Theatre	132
Reception	175
Banquet Rounds	120

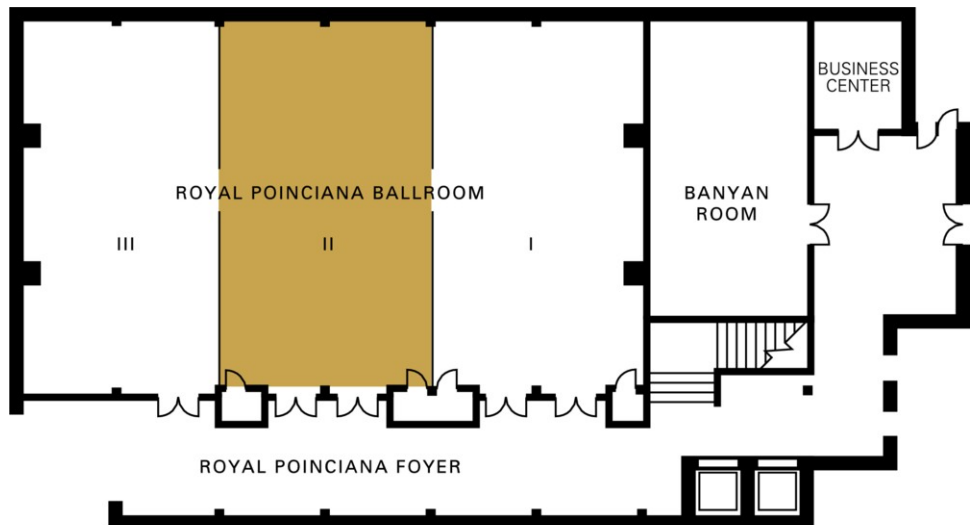

ROYAL POINCIANA BALLROOM III

Dimensions	60 x 33 ft
	18.3 x 10.1 m
Size	1,980 sq.ft.
	184 m ²
Height	11.7 ft
	3.6 m

Capacities

Classroom	96
Hollow square	60
U Shape	48
Theatre	132
Reception	175
Banquet Rounds	130

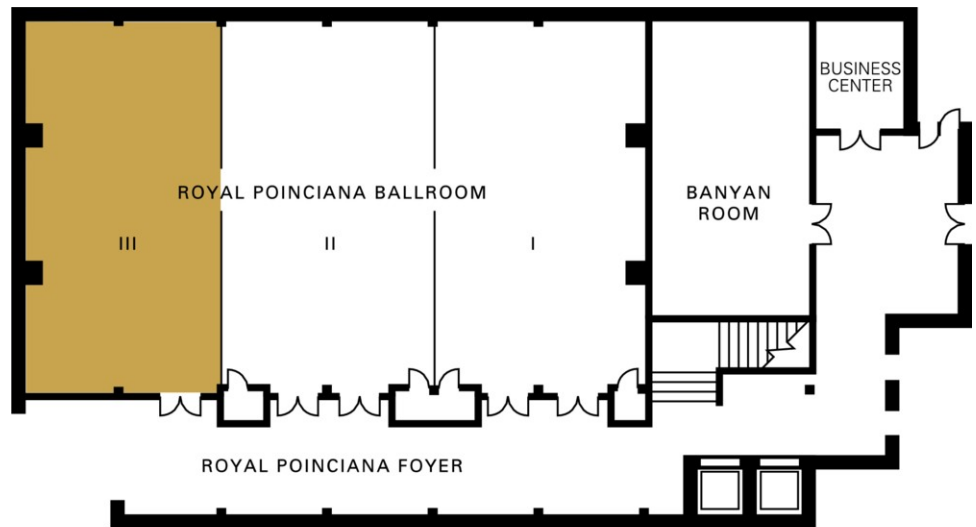

ROYAL POINCIANA FOYER

Dimensions	80 x 20 ft
	24.3 x 6.1 m
Size	1,600 sq.ft.
	149 m ²
Height	11.7 ft
	3.6 m

Capacities

Reception	300
-----------	-----

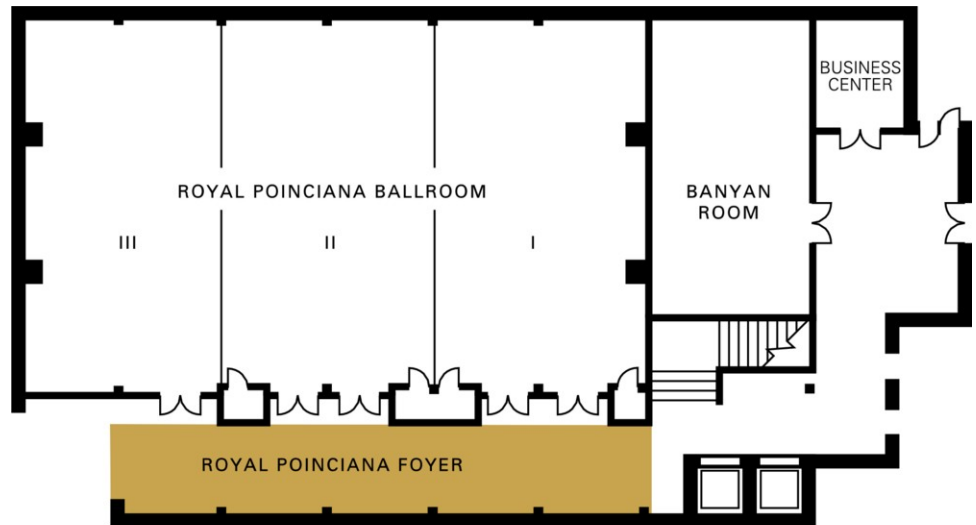

BANYAN ROOM

Dimensions	24 x 40 ft
	7.3 x 12.2 m
Size	960 sq.ft.
	89 m ²
Height	11.6 ft
	3.5 m

Capacities

Classroom	45
Hollow square	36
U Shape	30
Theatre	64
Reception	64
Banquet Rounds	50

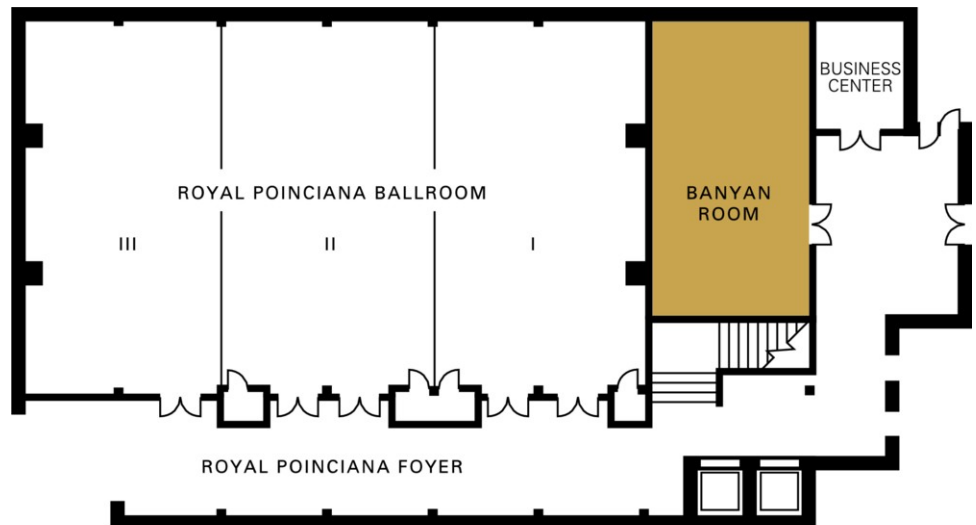

FLAGLER BALLROOM

Dimensions	100 x 60 ft 30.5 x 18.3 m
Size	6,000 sq.ft. 557 m ²
Height	13 ft 4 m

Capacities

Classroom	292
Theatre	396
Reception	396
Banquet Rounds	380

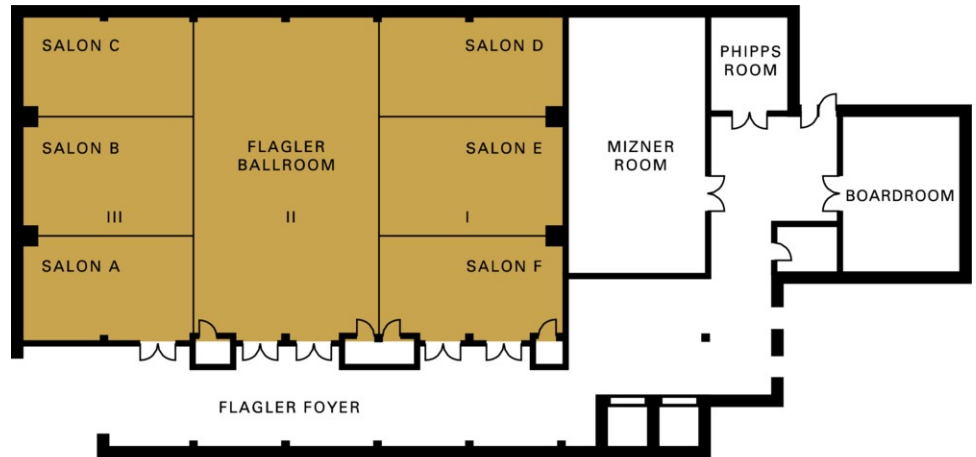

FLAGLER BALLROOM I

Dimensions	60 x 33 ft 18.3 x 10.1 m
Size	1,980 sq.ft. 184 m ²
Height	13 ft 4 m

Capacities

Classroom	96
Hollow square	48
U Shape	42
Theatre	132
Reception	175
Banquet Rounds	110

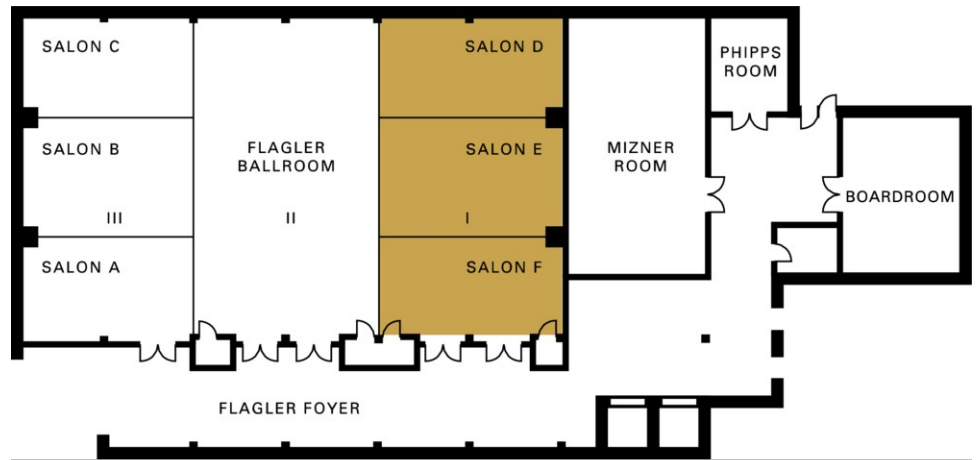

FLAGLER BALLROOM II

Dimensions	60 x 33 ft 18.3 x 10.1 m
Size	1,980 sq.ft. 184 m ²
Height	13 ft 4 m

Capacities

Classroom	96
Hollow square	48
U Shape	42
Theatre	132
Reception	175
Banquet Rounds	110

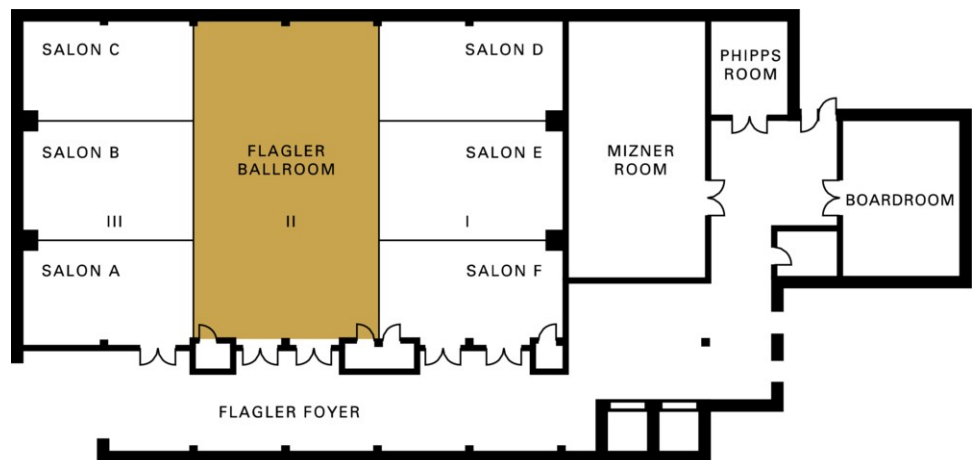

FLAGLER BALLROOM III

Dimensions	60 x 33 ft 18.3 x 10.1 m
Size	1,980 sq.ft. 184 m ²
Height	13 ft 4 m

Capacities

Classroom	96
Hollow square	48
U Shape	42
Theatre	132
Reception	175
Banquet Rounds	110

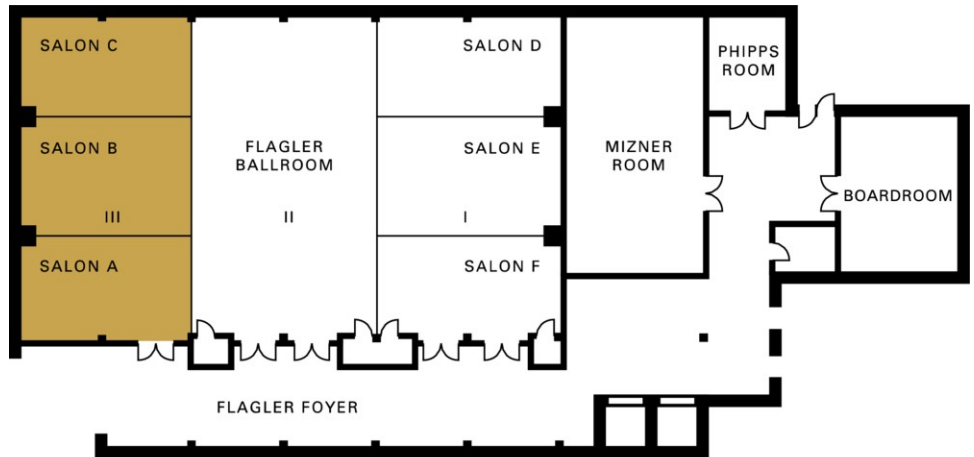

FLAGLER SALON A

Dimensions	31 x 20 ft 9.5 x 6.1 m
Size	620 sq.ft. 58 m ²
Height	13 ft 4 m

Capacities

Classroom	36
Hollow square	24
U Shape	21
Theatre	70
Reception	70
Banquet Rounds	40

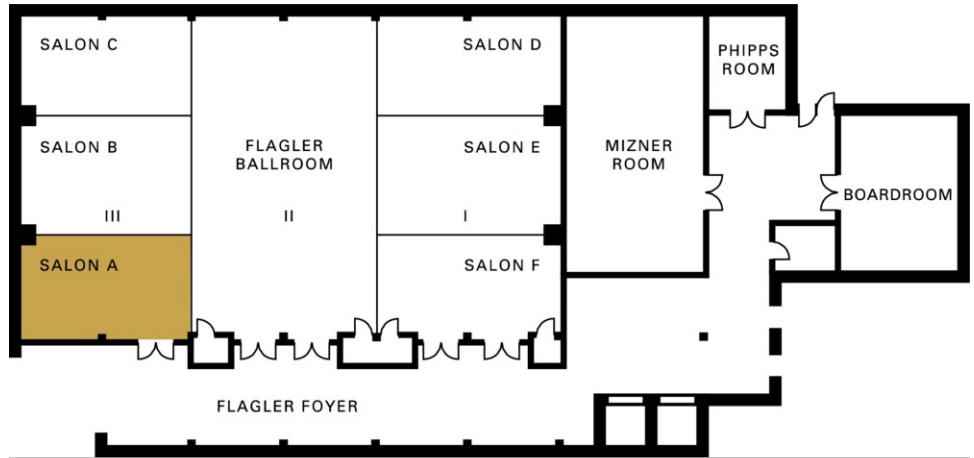

FLAGLER SALON B

Dimensions	31 x 20 ft 9.5 x 6.1 m
Size	620 sq.ft. 58 m ²
Height	13 ft 4 m

Capacities

Classroom	24
Hollow square	24
U Shape	21
Theatre	32
Reception	40
Banquet Rounds	30

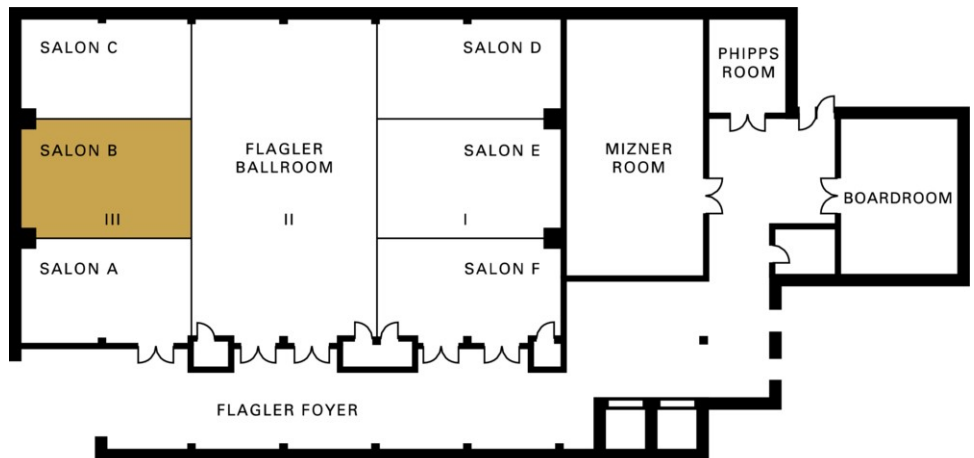

FLAGLER SALON C

Dimensions 31 x 20 ft
9.5 x 6.1 m
Size 620 sq.ft.
58 m²
Height 13 ft
4 m

Capacities

Classroom 24
Hollow square 24
U Shape 21
Theatre 32
Reception 40
Banquet Rounds 30

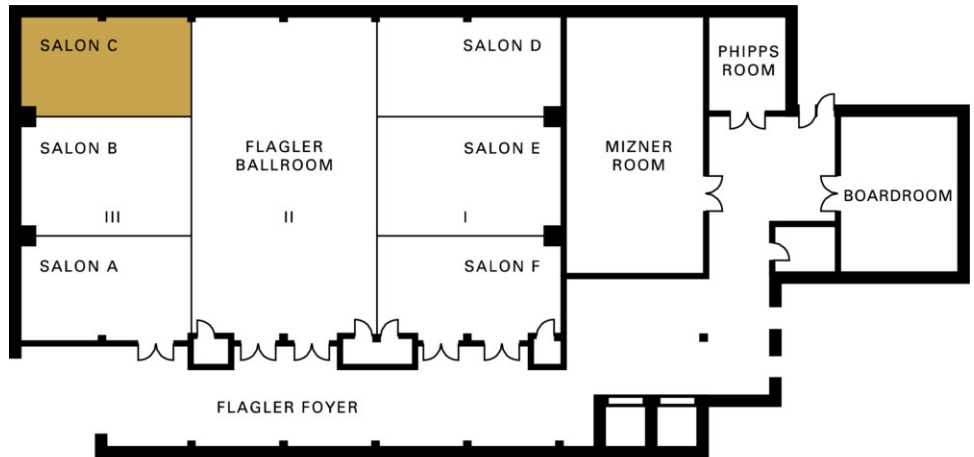

FLAGLER SALON D

Dimensions 31 x 20 ft
9.5 x 6.1 m
Size 620 sq.ft.
58 m²
Height 13 ft
4 m

Capacities

Classroom 24
Hollow square 24
U Shape 21
Theatre 32
Reception 40
Banquet Rounds 30



FLAGLER SALON E

Dimensions 31 x 20 ft
9.5 x 6.1 m
Size 620 sq.ft.
58 m²
Height 13 ft
4 m

Capacities

Classroom 24
Hollow square 24
U Shape 21
Theatre 32
Reception 40
Banquet Rounds 30

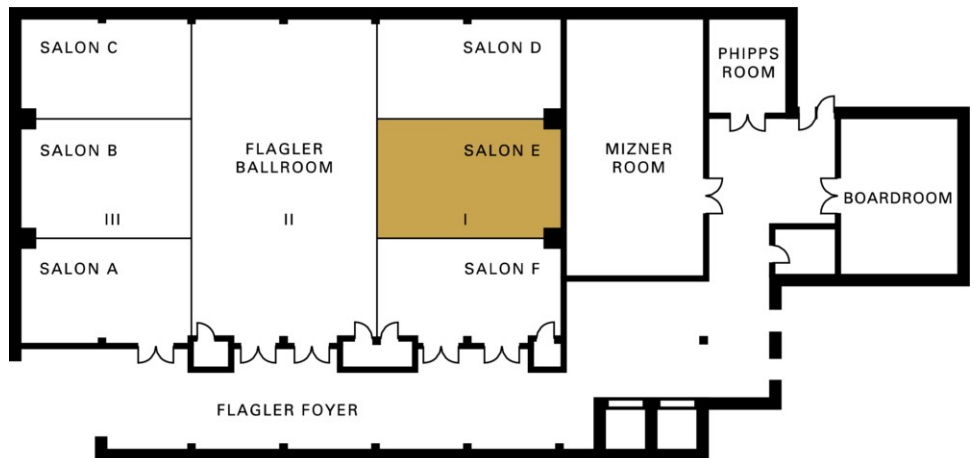

FLAGLER SALON F

Dimensions	31 x 20 ft 9.5 x 6.1 m
Size	620 sq.ft. 58 m ²
Height	13 ft 4 m

Capacities

Classroom	24
Hollow square	24
U Shape	21
Theatre	32
Reception	40
Banquet Rounds	30

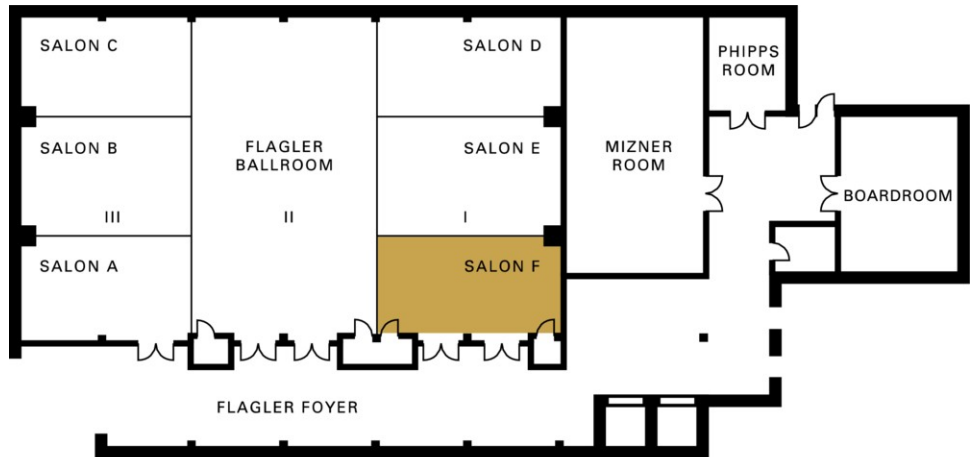

FLAGLER FOYER

Dimensions	87 x 28 ft 26.5 x 8.5 m
Size	2,436 sq.ft. 226 m ²
Height	13.5 ft 4.1 m

Capacities

Reception	300
-----------	-----

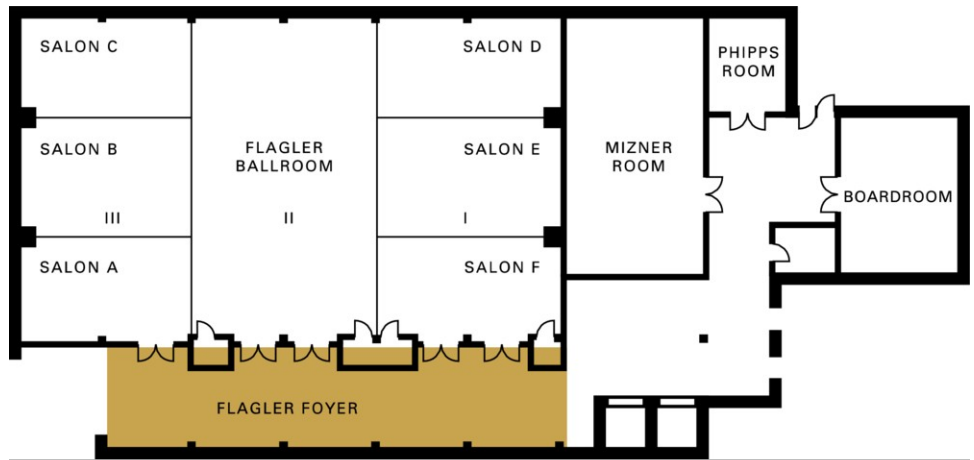

MIZNER ROOM

Dimensions	24 x 46 ft 7.3 x 14.0 m
Size	1,104 sq.ft. 103 m ²
Height	13.2 ft 4 m

Capacities

Classroom	63
Hollow square	42
U Shape	36
Theatre	64
Reception	64
Banquet Rounds	60

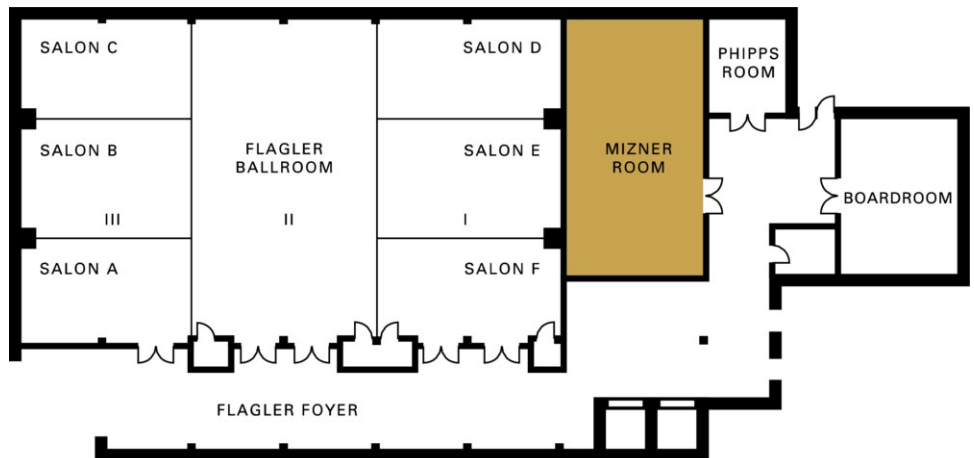

PHIPPS ROOM

Dimensions 15 x 18 ft
4.6 x 5.5 m
Size 270 sq.ft.
25 m²
Height 11 ft
3.4 m

Capacities

Hollow square 18
U Shape 15
Theatre 18
Banquet Rounds 10

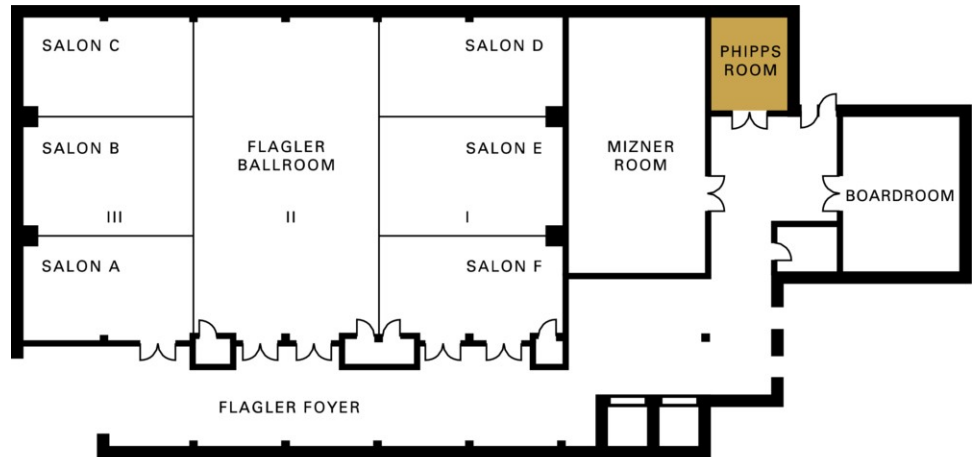

EXECUTIVE BOARDROOM

Dimensions 22 x 29 ft
6.7 x 8.8 m
Size 638 sq.ft.
59 m²
Height 12.3 ft
3.8 m

Capacities

Boardroom 14

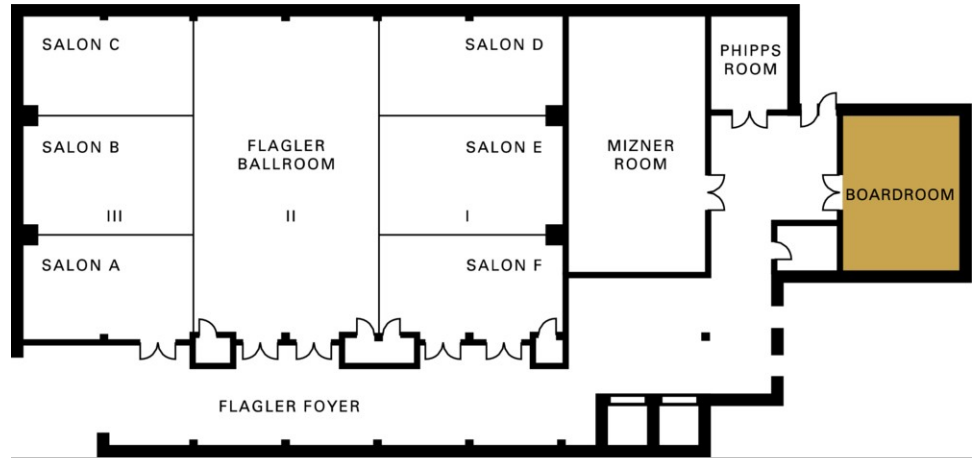

GUEST ROOMS, SUITES AND PRIVATE RESIDENCES OVERVIEW

Four Seasons Resort Palm Beach encompasses 210 exceptionally spacious newly designed guest rooms, including 13 suites.

Immersed in tropical gardens, the oceanfront Resort is a U-shaped, four-storey complex including north and south buildings on either side of a magnificent swimming pool.

All accommodations feature private furnished balconies with views of the ocean or the gardens and pool area. Restful residential comfort is complemented by convenient amenities, such as three telephones, wireless Internet access and flat-screen high definition televisions. Marble bathrooms feature a bathtub and shower combination, lighted make-up mirror, terry robes, hair dryer and a selection of premium toiletries.

<i>Room Category</i>	<i>#</i>	<i>Beds</i>	<i>Size</i>		<i>View</i>
			<i>(sq ft)</i>	<i>(m²)</i>	
- Premier Ocean-View Room	32	1 King or 2 double	546	51	Atlantic Ocean and Resort pool
- Ocean-View Room	70	1 King or 2 double	393	37	Atlantic Ocean
- Partial Ocean-View Room	50	1 King or 2 double	393	37	Resort gardens with partially obstructed view of ocean
- Garden-View Room	40	1 King or 2 double	393	37	Resort gardens
- Limited-View Room	5	1 King or 2 double	393	37	Limited views of the Resort's landscaped gardens
- Partial Ocean-View Accessible Room		2 double	393	37	Resort gardens with partially obstructed view of ocean
- Garden-View Accessible Room		1 King or 2 double	393	37	Resort gardens
- Deluxe Oceanfront Two-Bedroom Suite	3	2 King	1,370	127	Ocean
- Oceanfront Two-Bedroom Suite	1	2 King, or 1 King and 2 twin	1,370	127	Ocean
- Premier Ocean-View Suite	1	1 King	1,265	117	Ocean and Resort pool
- Oceanfront Suite	8	1 King	685	64	Ocean
- Premier Ocean-View Accessible Suite		1 King	1,265	117	Ocean and Resort pool

Guest Room Overview

Four Seasons guest rooms inspire relaxation within hearing of the waves. Garden-View Rooms feature north- or south-facing views of the Resort's tropical gardens. Partial Ocean-View Rooms combine angled views of the gardens with limited views of the ocean and pool. Ocean-View Rooms feature angled north- or south-facing views of the Atlantic Ocean, while Premier Ocean-View Rooms feature direct views of the Atlantic.

Suites Overview

Four Seasons Resort Palm Beach includes a collection of 13 spacious balconied suites that feature sleeping quarters secluded from large living areas. Several suites offer upgraded bathrooms with deep soaking tub and separate shower.

The one-bedroom Oceanfront Suites – only two per floor – each provide a full ocean

view, while the second-floor Magnolia Suite offers views of both ocean and pool.

The two-bedroom Jasmine Suite, on the first floor of the south building, features a spacious living room and oceanfront views.

Set on the first and fourth floors, the two-bedroom Orchid Suite, Gardenia Suite and Hibiscus Suite each have two furnished balconies with panoramic Atlantic views. Marble-floored living areas include a dining table for four; the Orchid Suite also includes a baby grand piano. These suites may be configured with three or four bedrooms.

PREMIER OCEAN-VIEW ROOM

Number 32
Beds King or two double beds
Size 546 sq ft
51 m²

Location

Main building, 2nd to 4th floors

View

Atlantic Ocean and Resort pool

Special features

One full marble bathroom

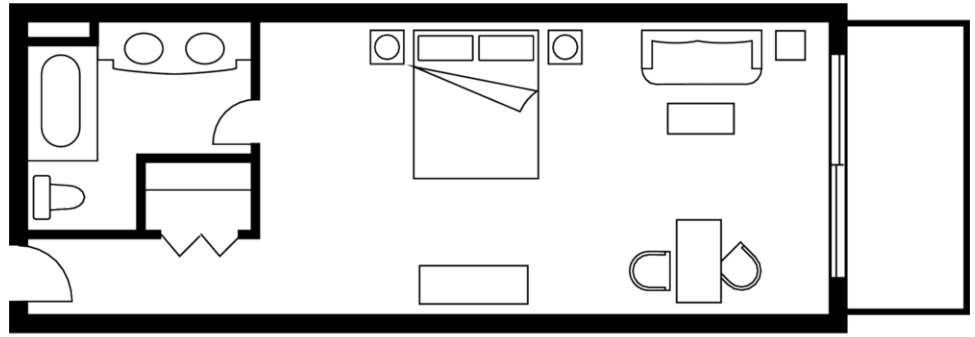

PARTIAL OCEAN-VIEW ROOM

Number 50
Beds King or two double beds
Size 393 sq ft
37 m²

Location

North and south buildings

View

Resort gardens with partially
obstructed view of ocean

Special features

One full marble bathroom

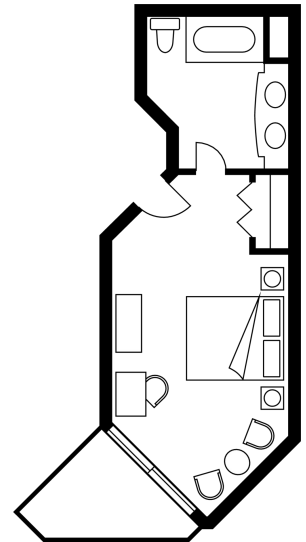

OCEAN-VIEW ROOM

Number 70
Beds King or two double beds
Size 393 sq ft
37 m²

Location

North and south buildings

View

Atlantic Ocean

Special features

One full marble bathroom

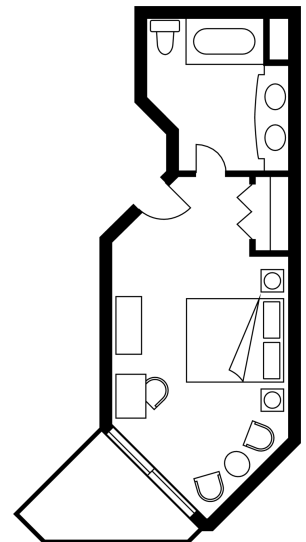

GARDEN-VIEW ROOM

Number 40
Beds King or two double beds
Size 393 sq ft
37 m²

Location

North and south buildings, 1st and 2nd floors

View

Resort gardens

Special features

One full marble bathroom

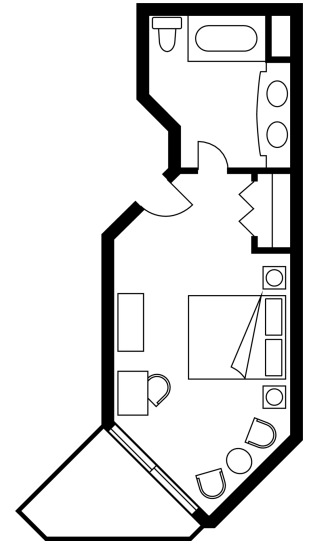

LIMITED-VIEW ROOM

Number 5
Beds King or two double beds
Size 393 sq ft
37 m²

Location

First floor, south building

View

Limited views of the Resort's landscaped gardens

Special features

One full marble bathroom

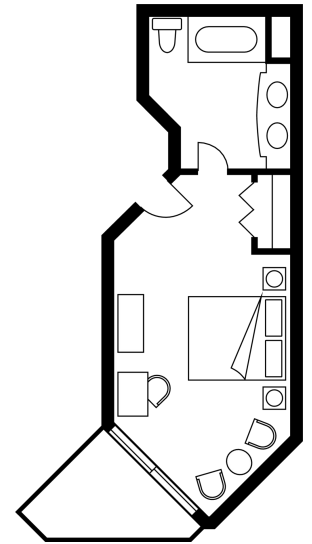

DELUXE OCEANFRONT TWO-BEDROOM SUITE

Number 3
Beds Two king beds
Size 1,370 sq ft
127 m²

Location

4th floor

View

Ocean

Special features

One full marble bathroom per bedroom, plus guest powder room

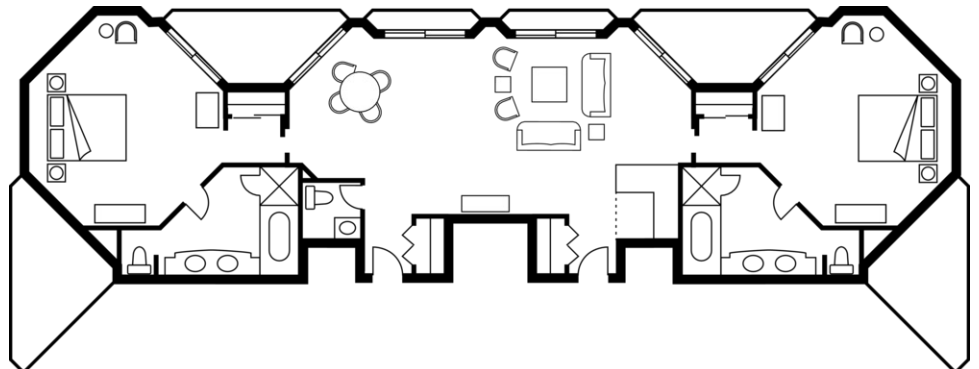

OCEANFRONT TWO-BEDROOM SUITE

Number 1
Beds Two king beds, or one king and two twin beds
Size 1,370 sq ft
127 m²

Location

1st floor

View

Ocean

Special features

One full marble bathroom per bedroom, plus guest powder room

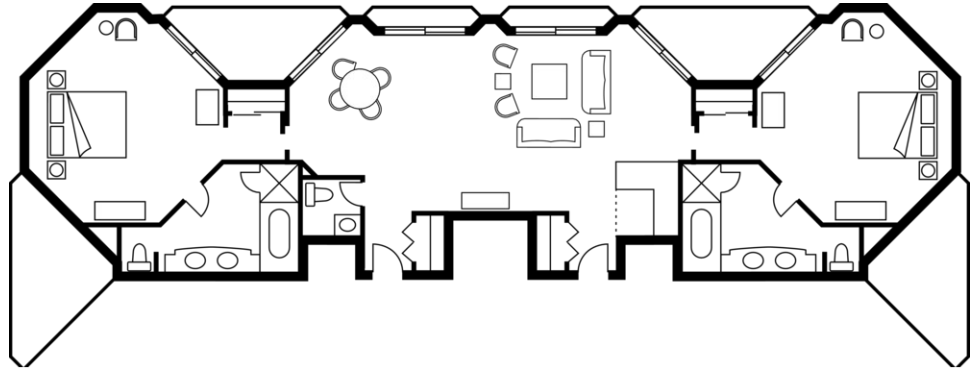

OCEANFRONT SUITE

Number 8
Beds King bed
Size 685 sq ft
64 m²

Location

North and south buildings, 2nd and 3rd floors

View

Ocean

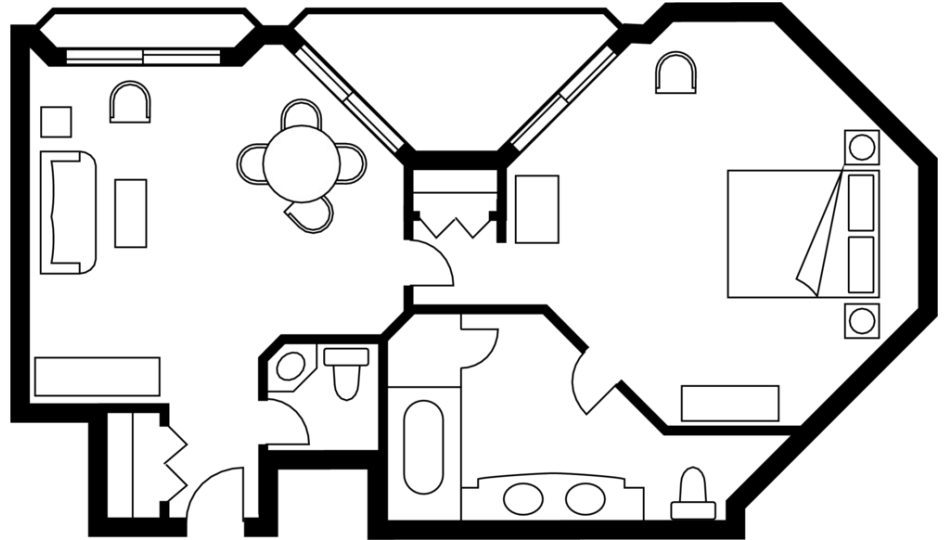

AMENITIES

- All news cable network
- Clock radio
- Complimentary newspaper with breakfast
- Down pillows
- Fax machine on request
- Hair dryer
- Hypo-allergenic pillows on request
- In-room safe
- iPod docking station
- Multi-line telephone(s) with voicemail
- Plasma/LCD screen television
- Refrigerated private bar
- Thick terry bathrobes
- Twice-daily housekeeping service
- Wired or wireless Internet access

GUEST SERVICES

- 24-hour In-Room Dining
- 24-hour laundry/dry-cleaning/pressing
- 24-hour multilingual Concierge
- Car rental desk
- Complimentary overnight shoeshine
- Gift shop
- Non-smoking rooms
- One-hour pressing
- Salon services
- Services and amenities for younger guests
- Umbrellas
- Valet parking

VIP GIFTS AND WELCOME AMENITY

Special arrangements can be made for clients to purchase themed gift items as welcome amenities for their VIP guests. A standard amenity is sent to all VIP guests by the General Manager, but customised VIP amenities are also available upon request.

DINING HOURS OF OPERATION

The Ocean Bistro

Breakfast

Every day 7:00 am - 11:30 am

Lunch

Every day 11:30 am - 2:30 pm

Dinner

Every day 5:30 pm - 10:00 pm

Atlantic Bar & Grill

Lunch

Every day 11:30 am - 4:30 pm

Bubbles and bites

Monday to Friday 4:30 pm - Dusk

The Restaurant

Dinner

Every day 6:00 pm - 10:00 pm

Beverage service

Every day 4:30 pm - 11:00 pm

The Restaurant Bar and Lounge

Every day 4:30 pm - 10:00 pm

In-Room Dining

Breakfast

Every day 6:00 am - 11:30 am

Children's menu

Every day 6:00 am - 10:00 pm

All-day dining

Every day 11:30 am - 10:00 pm

Night owl menu

Every day 10:00 pm - 6:00 am

DINING

With its ocean-side location, Four Seasons Resort Palm Beach specialises in fresh seafood and tropically influenced regional cuisine. Highlighting the dining experience is The Restaurant at Four Seasons, acclaimed and awarded as one of the finest restaurants in all Florida.

RESTAURANTS

The Ocean Bistro

During breakfast on the canopied terrace of the Resort's poolside Ocean Bistro, take in views of tropical gardens and beautiful sunrises over the Atlantic. Inside, find an airy setting for lunch, with sunlight streaming through myriad windows and wrought-iron lanterns hanging from pillars.

- Cuisine: Bistro-inspired with a twist
- Indoor seating: 75
- Outdoor seating: 72

Atlantic Bar & Grill

As street fare and food carts gain culinary street credibility, Atlantic Bar and Grill at Four Seasons Resort Palm Beach offers a menu inspired by beach favourites from both coasts. Try our signature Ahi tuna and Atlantic salmon chirasi from China Beach, our seafood ceviche from South Beach, softshell crab from Cape Cod, or our Baja fish tacos from Manhattan Beach.

- Outdoor seating: 68; 12 at the bar

The Restaurant

With a casual yet refined ambience, The Restaurant is the premier dining venue at Four Seasons Palm Beach. Enjoy Atlantic seafood in contemporary settings complemented by innovative cocktails.

- Cuisine: Atlantic seafood and chef's specialities

LOUNGES

The Restaurant Bar and Lounge

Toast the sunset from the canopied terrace of the Restaurant Bar and Lounge. Patio furnishings with plush and plump cushions provide a comfortable setting that's enhanced by light from votive candles.

Savour classic cocktails and artistic concoctions, impeccably crafted with native nectars, herbs and organic ingredients. Consider our signature Herb Garden Mojito, crafted with home-grown basil and mint.

- Cuisine: Grilled Atlantic seafood and American favourites

RECREATION FACILITIES

A self-contained world of relaxation, Four Seasons Palm Beach is the ultimate resort destination, offering endless diversions framed by sun and sea. From swimming and spa services to tennis and three nearby golf courses, there are abundant ways to custom-design an unforgettable Palm Beach experience.

SPA SERVICES

In the chic sanctuary of relaxation that is Four Seasons Resort Palm Beach, attune your mood to the natural ocean rhythms as you experience our carefully chosen results-oriented Amala and Kate Somerville products and treatments offered by the most skilled, sought-after practitioners.

- Products: Amala and Kate Somerville

FITNESS FACILITIES

The 24-hour Fitness Centre features cardiovascular and weight-training equipment. A personal trainer is available by appointment.

- Size: 6,000 sq ft / 557 m²

POOL

A stone's throw from the ocean, the Resort's lovely outdoor pool is set in an ample pool deck, surrounded by palms and gardens. This freshwater pool is heated and 6 feet (1.8 metres) deep. A whirlpool is nearby. Pool attendants are on duty with towels, lemon water, chilled face cloths, Evian spritz and fresh-cut fruit from 7:00 am to 6:00 pm. Pool cabanas are available for use upon request.

GOLF

Atlantis Golf Club

One of the few modern clubs offering old Florida charm and ambience, Atlantis Golf Club is state-of-the-art in every respect. Restored in 2003, the course offers Tiff Eagle greens and new tees and bunkers.

Recognised as one of the best-conditioned courses in the area, Atlantis is a private-club that offers amenities and services such as PGA Professional staff, group and individual lessons and golf schools. Guest of Four Seasons Resort Palm Beach enjoy exclusive rights to play Atlantis Golf Club alongside its private membership group.

Atlantis Golf Club also features a restaurant and a bar and grill on site.

- Designer: Bill Mitchell
- Par: 72
- Yardage: 6,837

Par 3 Golf Course

This world-renowned golf course is located close to Four Seasons in beautiful Palm Beach. It offers guests the unique and memorable experience of golfing on the ocean, with 18 stunning holes situated between the Intracoastal Waterway and the Atlantic Ocean.

- Designer: Originally designed by Dick Wilson, 1960 - Redesigned by Raymond Floyd, 2009
- Number of holes: 18
- Par: 54
- Yardage: 2,672

TENNIS

Tennis professional on staff with a full-service pro shop on property. Private tennis lessons and group clinics are available. Various single/doubles tournament games can be arranged. One ball machine is located on the courts. Racquet re-stringing service available. Racquet rentals are available, and tennis balls can be purchased.

WATER SPORTS

A full range of water-sport activities and instruction is available in Palm Beach. These include:

- Windsurfing
- Kayaking
- Sailing
- Boating on a wide variety of boats, including luxury liners, catamarans, motor and sailing yachts and upscale sightseeing and dining yachts
- Scuba diving
- Snorkelling
- Sea turtle watching (seasonal)
- Deep sea saltwater fishing for dolphin, wahoo, tuna, billfish, sailfish, tarpon, amberjack, blue marlin and snook

INCENTIVE ACTIVITIES

Sample Itinerary

Four Seasons can help customise an itinerary for your group or party. Palm Beach is one of the premier destinations on the East Coast, providing a wide range of activities for visitors. Your group can take full advantage of Palm Beach's diversity. Events can be planned to take place on the beach or the Intracoastal Waterway, aboard private yachts, in mansions or in the elegant surroundings of the town of Palm Beach. Please let us know how else we can assist you.

Day 1 **Arrival at Resort** Following your arrival, spend the afternoon at leisure:

- Bicycling
- Health spa
- Tennis
- Pool
- Beach

Evening Enjoy a welcome reception poolside. Possible themes include:

- Palm Beach al fresco - with jazz, an artist and Palm Beach street scenes
- Tropical sensation - with reggae, limbo, jugglers and mermaids
- Shipwreck - with calypso, tiki huts and pirates
- Seasons yacht club - with contemporary music and nautical décor

Day 2 **Day** Breakfast in private at leisure, then experience your choice of sport and surf activities:

- Golf
- Tennis
- Deep sea fishing
- Windsurfing
- Snorkelling
- Sailing
- Hobie Cats
- Jet skiing
- Catamaran

Evening Enjoy an off-site formal dinner. Possible venues include:

- Private yacht
- Flagler Mansion/Museum
- Kravis Center for the Performing Arts
- Polo Grounds
- Dine-around
- Norton Gallery of Art
- Private mansion
- Norton Sculpture Gardens

Day 3 **Day** Breakfast in private at leisure, then experience your choice of:

- Art and antique tours
- Everglades tour
- Lion country safari
- Polo demonstration
- Private mansion tour

- Helicopter tour

Evening Enjoy an on-site casual dinner event. Possible themes include:

- Tropical rock café
 - Big six sports challenge
 - Millennium three
 - Twist and shout
 - Legendary links
 - Down home barbecue
 - Clam bake
 - Sebastian Inlet beach party
-

Day 4

Day Breakfast in private at leisure, then experience your choice of:

- Beach olympics
- Palm Beach road rally
- Pirate's treasure hunt
- Polaroid scavenger hunt
- Raft building

Evening Enjoy a casual dinner off-site. Possibilities include:

- Rock and bowl
 - Ragtops
 - Intracoastal cruise
 - Jai alai
 - Peanut Island
 - Bonnett Lodge
-

Day 5

Day Breakfast in private at leisure, then experience your choice of:

- Worth Avenue shopping
- Palm Beach tour
- Culinary demonstration
- Spa treatments
- Wellness seminar
- Shop till you drop

Evening End your stay with an on-site gala dinner event. Possible themes include:

- Royal palm casino
 - Palm Beach film festival
 - Club Four Seasons
 - Palm Beach fantasy
-

www.fourseasons.com/palmbeach

Rooms	Dimensions		Size		Height		Classroom	Hollow square	U-shape	Theatre	Reception	Banquet rounds	Conference/ boardroom
	(ft)	(m)	(sq ft)	(m2)	(ft)	(m)							
- The Living Room	-	-	-	-	-	-	-	-	-	-	180	60	-
- The Living Room Patio	-	-	-	-	-	-	-	-	-	-	-	-	-
- Royal Poinciana Ballroom	100 x 60	30.5 x 18.3	6,000	557	11.7	3.6	312	120	84	396	396	370	-
- Royal Poinciana Ballroom I	60 x 33	18.3 x 10.1	1,980	184	11.7	3.6	96	60	48	132	175	120	48
- Royal Poinciana Ballroom II	60 x 33	18.3 x 10.1	1,980	184	11.7	3.6	96	60	48	132	175	120	48
- Royal Poinciana Ballroom III	60 x 33	18.3 x 10.1	1,980	184	11.7	3.6	96	60	48	132	175	130	48
- Royal Poinciana Foyer	80 x 20	24.3 x 6.1	1,600	149	11.7	3.6	-	-	-	-	300	-	-
- Banyan Room	24 x 40	7.3 x 12.2	960	89	11.6	3.5	45	36	30	64	64	50	28
- Flagler Ballroom	100 x 60	30.5 x 18.3	6,000	557	13	4	292	-	-	396	396	380	-
- Flagler Ballroom I	60 x 33	18.3 x 10.1	1,980	184	13	4	96	48	42	132	175	110	40
- Flagler Ballroom II	60 x 33	18.3 x 10.1	1,980	184	13	4	96	48	42	132	175	110	40
- Flagler Ballroom III	60 x 33	18.3 x 10.1	1,980	184	13	4	96	48	42	132	175	110	40
- Flagler Salon A	31 x 20	9.5 x 6.1	620	58	13	4	36	24	21	70	70	40	24
- Flagler Salon B	31 x 20	9.5 x 6.1	620	58	13	4	24	24	21	32	40	30	22
- Flagler Salon C	31 x 20	9.5 x 6.1	620	58	13	4	24	24	21	32	40	30	22
- Flagler Salon D	31 x 20	9.5 x 6.1	620	58	13	4	24	24	21	32	40	30	22
- Flagler Salon E	31 x 20	9.5 x 6.1	620	58	13	4	24	24	21	32	40	30	22
- Flagler Salon F	31 x 20	9.5 x 6.1	620	58	13	4	24	24	21	32	40	30	22
- Flagler Foyer	87 x 28	26.5 x 8.5	2,436	226	13.5	4.1	-	-	-	-	300	-	-
- Mizner Room	24 x 46	7.3 x 14.0	1,104	103	13.2	4	63	42	36	64	64	60	34
- Phipps Room	15 x 18	4.6 x 5.5	270	25	11	3.4	-	18	15	18	-	10	-
- Executive Boardroom	22 x 29	6.7 x 8.8	638	59	12.3	3.8	-	-	-	-	-	-	14