



Quick Reference Guide

Last updated May 3, 2012 | For additional information please contact the hotel directly

Four Seasons Hotel México, D.F.

Paseo de la Reforma #500, Colonia Juárez, Mexico, D.F., 06600, Mexico

Tel 52.55.5230.1818 | Fax 52.55.5230.1808 | Res 52.55.5230.1818

or.52.55.5230.1809

www.fourseasons.com/mexico



Situated on Paseo de la Reforma, near Chapultepec Park, the National Museum of Anthropology and leading business, shopping and residential areas, Four Seasons is a soothing oasis from which to explore one of the world's largest and most dynamic capitals.

Paseo de la Reforma #500, Colonia Juárez
Mexico, D.F. 06600, Mexico
Tel 52.55.5230.1818
Fax 52.55.5230.1808
Res 52.55.5230.1818
or.52.55.5230.1809

AIRPORT

- Benito Juárez International Airport (MEX): 30 minutes (17 kilometres/10 miles)

TABLE OF CONTENTS

- 2 *Introduction*
- 3 *Destination*
- 5 *Conference Facilities*
- 12 *Guest rooms, Suites and Private Residences*
- 16 *Dining*
- 17 *Recreational Facilities*
- 18 *Appendix: Conference Chart*



Four Seasons is home to 240 exceptionally spacious guest rooms, including 40 suites, arranged around a tranquil and private garden courtyard. Classical European and Mexican architecture blend to reflect the character of colonial Mexico yet with thoroughly modern comforts and amenities for business or leisure.

From a confidential meeting to a gala reception for up to 500, Four Seasons accommodates a wide array of business and social occasions.

TRANSPORTATION

Airlines serving Benito Juárez International Airport include Aero California, Aerolineas Argentinas, Aeromar, Aeroméxico, Air Canada, Air France, Alaska Airlines, American Airlines, America West, Aviacsa, Avianca, Click Mexicana, Copa, Air Cubana, Delta Airlines, Iberia, Japan Airlines, KLM, Lacsá, Lan Chile, Lan Peru, Lufthansa, United Airlines, US Airways, Magnicharter, Mexicana, Northwest Airlines and Taca Airlines.

WEATHER CHART

| Month | °C | | °F | |
|-----------|------------|------------|------------|------------|
| | Highs/Lows | Highs/Lows | Highs/Lows | Highs/Lows |
| January | 22 | / 8 | 72 | / 46 |
| February | 25 | / 10 | 77 | / 50 |
| March | 27 | / 12 | 81 | / 54 |
| April | 26 | / 12 | 79 | / 54 |
| May | 31 | / 11 | 88 | / 52 |
| June | 25 | / 12 | 77 | / 54 |
| July | 25 | / 12 | 77 | / 54 |
| August | 24 | / 12 | 75 | / 54 |
| September | 23 | / 12 | 73 | / 54 |
| October | 24 | / 13 | 75 | / 55 |
| November | 24 | / 11 | 75 | / 52 |
| December | 23 | / 10 | 73 | / 50 |

DESTINATION

Mexico City is the focus of Mexico's political, cultural and economic life. The nation's capital and its largest metropolis, it has a population of over 25 million and covers an area of 1,547 square kilometres (597 square miles). Its wide boulevards are lined by both modern glass and steel structures and the colonial architecture of the past.

With its diverse heritage, the city offers 75 museums and 10 archaeological zones. Mexico City's historical centre is a 668-block area around the Zócalo (main square) that has been designated a World Cultural Heritage Site by UNESCO. The district encompasses more than 1,400 historic structures, including the Templo Mayor (Great Temple of the Aztecs), as well as private mansions and civic and religious buildings.

WEATHER

In its valley setting, Mexico City offers a temperate climate with cooler temperatures than coastal regions. The city enjoys warm weather, year round. Winter temperatures, chilly at dawn and dusk, are reminiscent of spring.

LOCAL ATTRACTIONS AND ACTIVITIES

At Four Seasons Hotel México, D.F., you enjoy a unique vantage point from which to explore the sights, sounds and experiences around you. We hope the highlights of local attractions below help simplify the planning for your next Mexico City hotel experience. Please let us know how else we can assist you.

Within a 5-minute walk of the Hotel

Bosque de Chapultepec (Chapultepec Park):

- The oldest natural park in North America, Chapultepec Park is the largest and most varied city park in the world. Covering 840 hectares (2,100 acres) of the city, the park includes areas of greenery, a zoo, gardens, lakes, museums, playgrounds, bridle paths and monuments.

Within a 10-minute walk of the Hotel

Angel de la Independencia (Angel of Independence):

- Angel of Independence is a 45-metre (150-foot) column, surmounted by a winged Victory, constructed between 1901 and 1910 to commemorate the first century of Mexico's independence from Spain.

Within a 15-minute walk of the Hotel

National Museum of Anthropology and History:

- The National Museum of Anthropology and History is one of the world's finest museums. Radiating from the main patio are 12 exhibition halls devoted to Mexico's early civilizations. Filled with priceless relics, such as a 30-ton Aztec stone calendar and life-size replicas of Monte Alban, the museum features the cultures of the Maya, Toltec, Zapotec and Aztec Indians and cultures from the Gulf of Mexico.

Museo Nacional de Historia (National Museum of History):

- The National Museum of History is housed in a building in the Castillo de Chapultepec dating from the 18th century. The former residence of Emperor

Maximilian and Empress Carlota, it contains furniture, weapons and paintings dating from the conquest to the Revolution.

Within a 15-minute drive of the Hotel

Museo del Palacio de Bellas Artes (Fine Arts Palace):

- Museo del Palacio de Bellas Artes houses murals painted by Rivera, Orozco and Siqueiros. It hosts national and international exhibitions.

Ballet Folklórico de México (Folkloric Ballet of Mexico) :

- A spectacular presentation of traditional music, dance and costumes from all corners of the country at the Palace of Fine Arts. Performances vary, depending on the season.

Within a 30-minute drive of the Hotel

Museo del Templo Mayor (The Great Temple of the Aztecs):

- The Great Temple of the Aztecs (Templo Mayor) was discovered in 1978 during the construction of the subway. The 60-metre-high (200-foot) temple served as the religious and political centre of the Aztec empire. The Museo del Templo Mayor houses 7,000 items that were recovered from the temple, including a large-scale model of the sacred centre of the Aztec capital, Tenochtitlan.

Museo Nacional de Arte (National Museum of Art):

- The National Museum of Art is housed in a magnificent building from the early 20th century and showcases Mexican art from the early 15th century to the 1950s.

Museo de San Idelfonso (San Idelfonso Museum):

- The San Idelfonso Museum is in an 18th-century building and displays the early murals of such artists as Orozco, Rivera, Siqueiros, Charlot, Leal, Revueltas and Alva de Canal.

Catedral (National Cathedral):

- National Cathedral is a richly ornamented edifice which contains marble altars, statuary, silver railings and priceless tapestries.

San Angel, Coyoacán and Xochimilco:

- The southern part of the city includes San Angel, Coyoacán and Xochimilco, which are well preserved examples of colonial-style towns. San Angel is the site of the Bazar del Sábado (Saturday Bazaar), one of the most typical craft-markets. Xochimilco is best known for its floating gardens, living examples of the pre-Hispanic agricultural system. Coyoacán is a 45 minute drive from the Hotel and Xochimilco is a one hour drive.

Within a 1-hour drive of the Hotel

Museo Dolores Olmedo (Dolores Olmedo Museum):

- Dolores Olmedo Museum has the most representative collection of works by Diego Rivera and Frida Kahlo displayed in a beautiful, rambling estate-turned-museum.

CONFERENCE FACILITIES OVERVIEW

| | |
|------------------------------------|---------------------------------------|
| Total Space | 1,122 m ² 12,084 sq.ft. |
| Largest Ballroom | 393 m ² 4,230 sq.ft. |
| Meet and Feed (max. capacity) | 500 |
| Breakouts | 12 |
| Banquet (max. capacity) | 320 |
| Outdoor Banquet (max. capacity) | - |
| Private Dining (max. capacity) | 20 |

CONFERENCE FACILITIES

Set on the celebrated Paseo de la Reforma, Mexico City's most prestigious meeting place combines Four Seasons service and impeccably modern amenities overlooking a fountain courtyard. Four Seasons offers venues for gala banquets, private receptions and meetings in an array of sizes and can host everything from creatively themed events to conventions to elaborate formal receptions and dinners.

Approximately 1,200 square metres (13,000 square feet) of meeting space is available in 13 function rooms. Room capacities range from an executive conference for 10 to a banquet for 320 dinner guests or 500 for a reception.

Our elegant facilities are complemented by expert support, fine cuisine and meticulous Four Seasons service to ensure that every event unfolds memorably and successfully. Multilingual assistance is on call around the clock.

Second floor

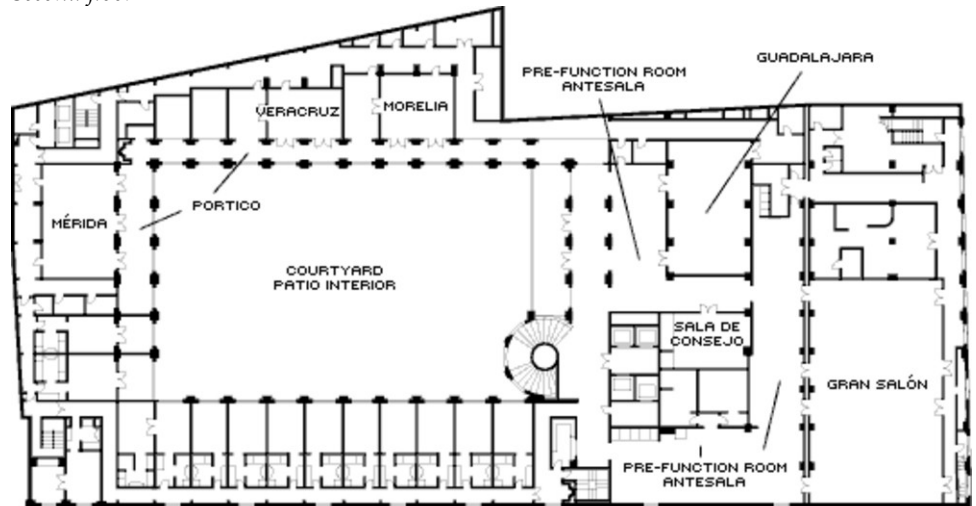

Ground and third floor

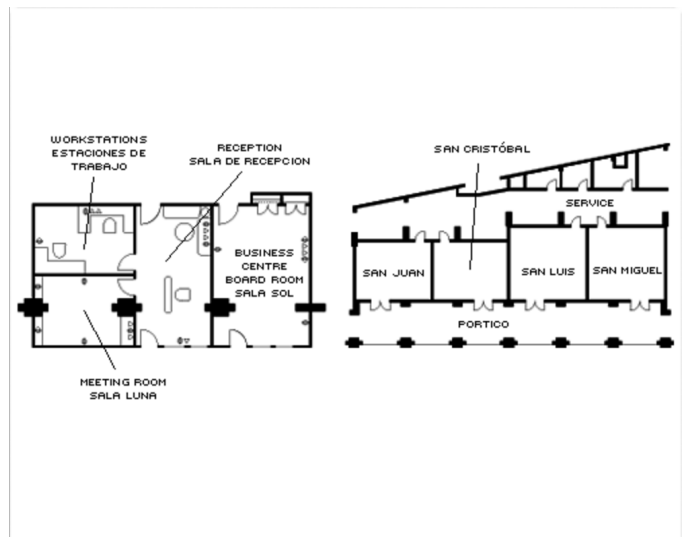

TECHNICAL ASSISTANCE

An audiovisual company maintains a relationship with the Hotel to supply equipment and technicians. They and your Four Seasons Meeting Services Manager ensure a flawless presentation.

State-of-the-art equipment includes:

- Video/data, overhead and slide projectors, laser pointers
- Sound systems, audio cassette recorders and microphones
- Video cameras
- All format video players/recorders (PAL, SECAM, NTSC, 3/4")
- Multi-image dissolve units and programmers
- Personal computers and printers
- Dedicated telephone lines (on request)
- Video conference (at the present time, we are the only hotel in Mexico City to offer this service – special telephone lines provide it with clear audio and video reception)
- Wired or wireless Internet access in meeting rooms

MUSIC AND ENTERTAINMENT

Our Meeting Services Manager will be happy to assist with setting up any type of music, flower arrangements or entertainment for your meeting.

RECEIVING AND MAINTENANCE

All packages should be sent to the attention of a group's name and its meeting planner. They will be stored in a separate conference storage area. Limited space is available for the storage of large items. Please time shipping to the dates of your arrival. Please request special shipping instructions for clearing customs without unnecessary delays.

Receiving dock

Our Meeting Services Manager can make special arrangements for delivery of oversized packages or environmentally sensitive equipment.

Post-conference shipping

Shipping of post-conference materials may be co-ordinated through our Meeting Services Manager.

Maintenance

The Engineering Department is available 24 hours a day for general assistance with lighting, room temperature control and minor repairs.

SPOUSE PROGRAMMES

Spouse programmes such as cultural tours and shopping adventures can be arranged.

CHILDRENS AND FAMILY PROGRAMMES

We would be pleased to help arrange appropriate activities for visiting families. Please contact our Concierge.

SAN JUAN

| | |
|------------|-----------------------------------|
| Dimensions | 6.6 x 5.2 m 21.6 x 17 ft |
| Size | 34.3 m ² 369 sq.ft. |
| Height | 2.8 m 9.2 ft |

Capacities

| | |
|----------------|----|
| Classroom | 15 |
| Hollow square | 15 |
| U Shape | 12 |
| Theatre | 25 |
| Reception | 20 |
| Banquet Rounds | 20 |

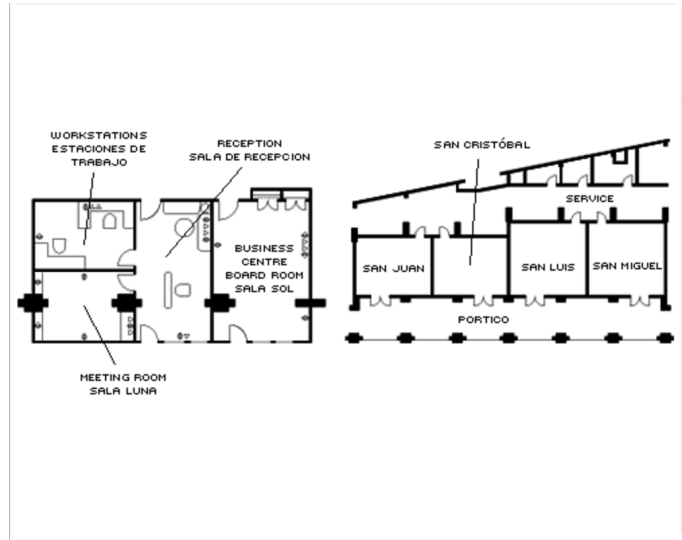

SAN CRISTOBAL

| | |
|------------|-----------------------------------|
| Dimensions | 6.6 x 5.2 m 21.6 x 17 ft |
| Size | 34.3 m ² 369 sq.ft. |
| Height | 2.8 m 9.2 ft |

Capacities

| | |
|----------------|----|
| Classroom | 15 |
| Hollow square | 15 |
| U Shape | 12 |
| Theatre | 25 |
| Reception | 20 |
| Banquet Rounds | 20 |

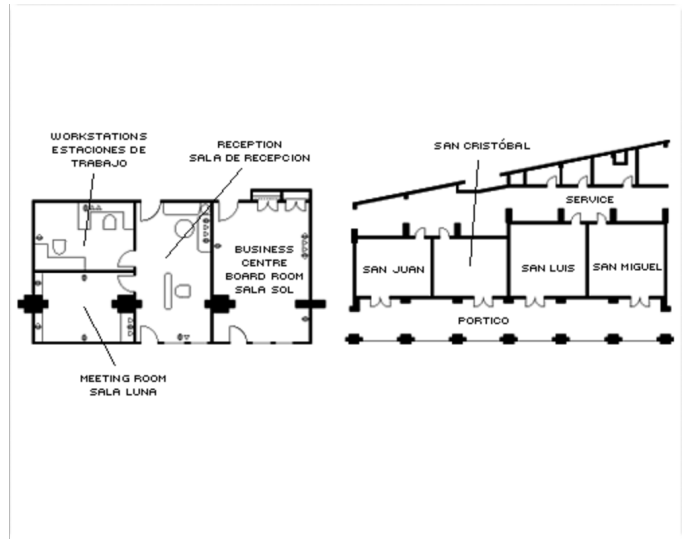

SAN LUIS

| | |
|------------|-----------------------------------|
| Dimensions | 6.6 x 6.5 m 21.6 x 21.3 ft |
| Size | 42.9 m ² 462 sq.ft. |
| Height | 2.8 m 9.2 ft |

Capacities

| | |
|----------------|----|
| Classroom | 20 |
| Hollow square | 18 |
| U Shape | 15 |
| Theatre | 30 |
| Reception | 30 |
| Banquet Rounds | 30 |

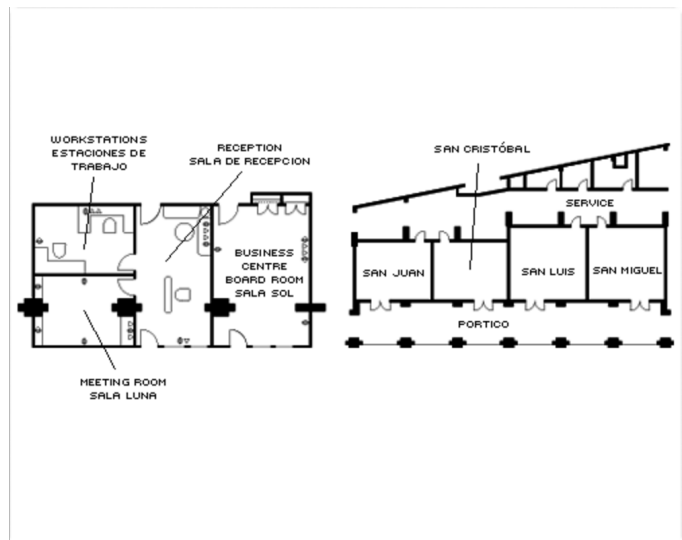

SAN MIGUEL

| | |
|------------|---------------------|
| Dimensions | 6.6 x 6.5 m |
| | 21.6 x 21.3 ft |
| Size | 42.9 m ² |
| | 462 sq.ft. |
| Height | 2.8 m |
| | 9.2 ft |

Capacities

| | |
|----------------|----|
| Classroom | 20 |
| Hollow square | 18 |
| U Shape | 15 |
| Theatre | 30 |
| Reception | 30 |
| Banquet Rounds | 30 |

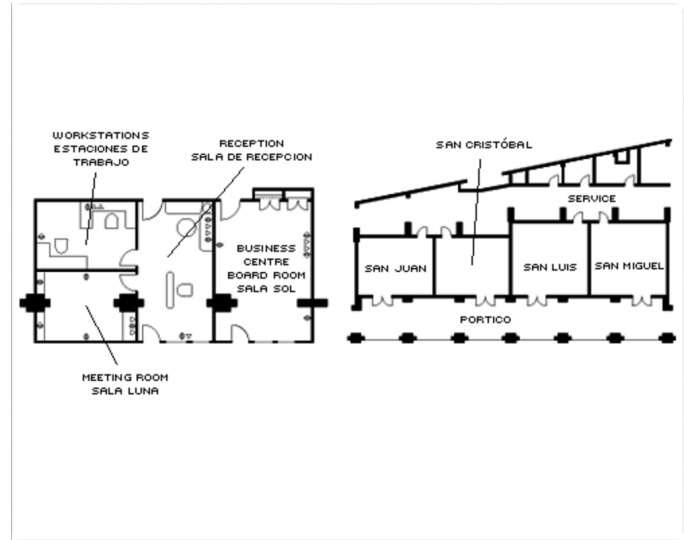

GRAN SALÓN

| | |
|------------|--------------------|
| Dimensions | 26.2 x 15 m |
| | 86 x 49.2 ft |
| Size | 393 m ² |
| | 4,229 sq.ft. |
| Height | 4.3 m |
| | 14 ft |

Capacities

| | |
|----------------|-----|
| Classroom | 250 |
| Hollow square | 150 |
| U Shape | 120 |
| Theatre | 450 |
| Reception | 500 |
| Banquet Rounds | 320 |

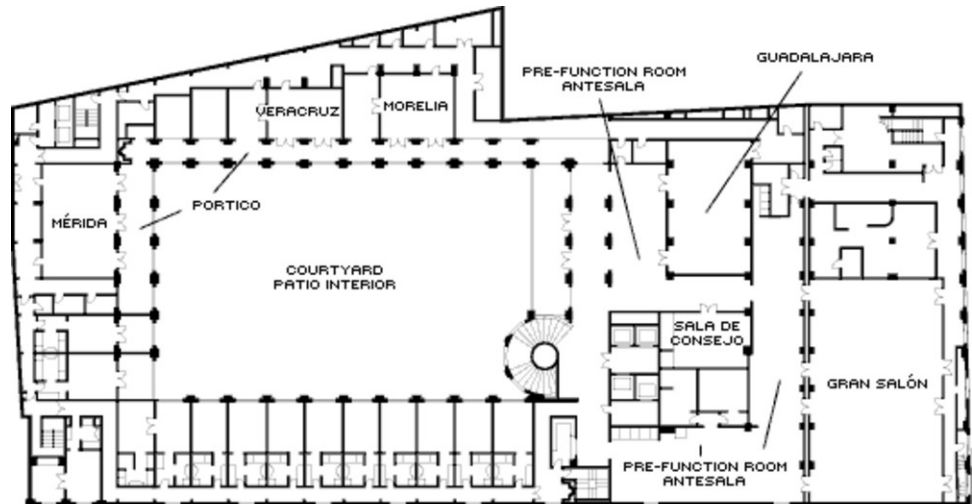

GRAN SALÓN A

| | |
|------------|----------------------|
| Dimensions | 13.1 x 15 m |
| | 43 x 49.2 ft |
| Size | 196.5 m ² |
| | 2,115 sq.ft. |
| Height | 4.3 m |
| | 14.1 ft |

Capacities

| | |
|----------------|-----|
| Classroom | 120 |
| Hollow square | 60 |
| U Shape | 50 |
| Theatre | 210 |
| Reception | 180 |
| Banquet Rounds | 160 |

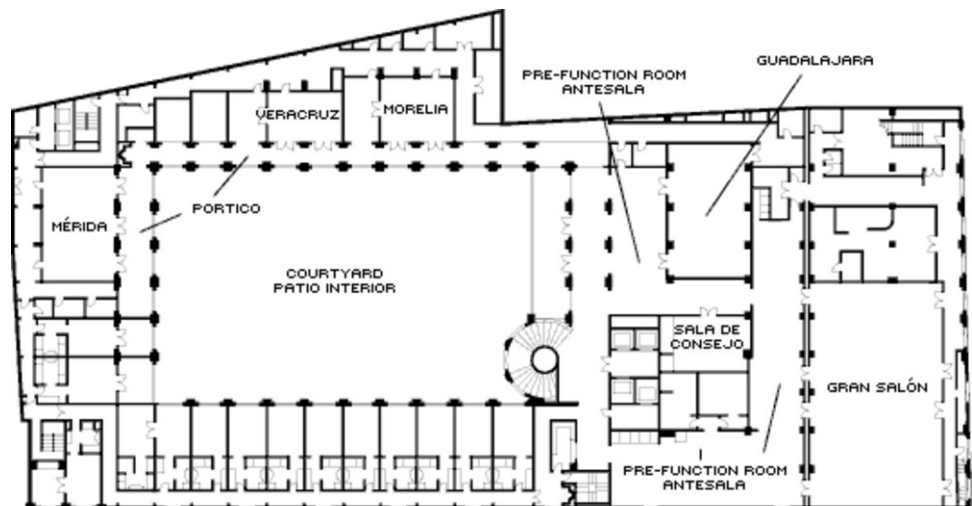

GRAN SALÓN B

| | |
|------------|----------------------|
| Dimensions | 13.1 x 15 m |
| | 43 x 49.2 ft |
| Size | 196.5 m ² |
| | 2,115 sq.ft. |
| Height | 4.3 m |
| | 14.1 ft |

Capacities

| | |
|----------------|-----|
| Classroom | 120 |
| Hollow square | 60 |
| U Shape | 50 |
| Theatre | 210 |
| Reception | 180 |
| Banquet Rounds | 160 |

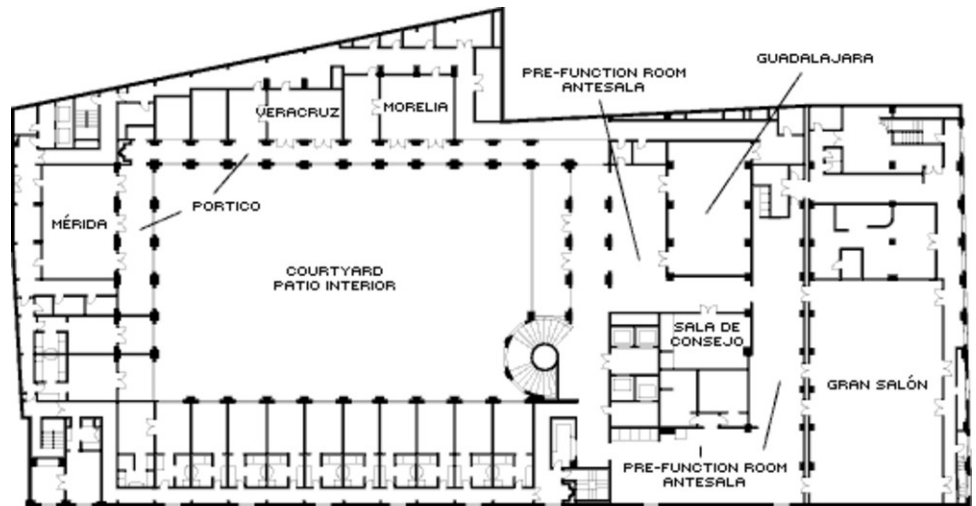

GUADALAJARA

| | |
|------------|----------------------|
| Dimensions | 16.2 x 9.8 m |
| | 53 x 32 ft |
| Size | 158.8 m ² |
| | 1,709 sq.ft. |
| Height | 3.1 m |
| | 10.2 ft |

Capacities

| | |
|----------------|-----|
| Classroom | 80 |
| Hollow square | 60 |
| U Shape | 50 |
| Theatre | 150 |
| Reception | 150 |
| Banquet Rounds | 120 |

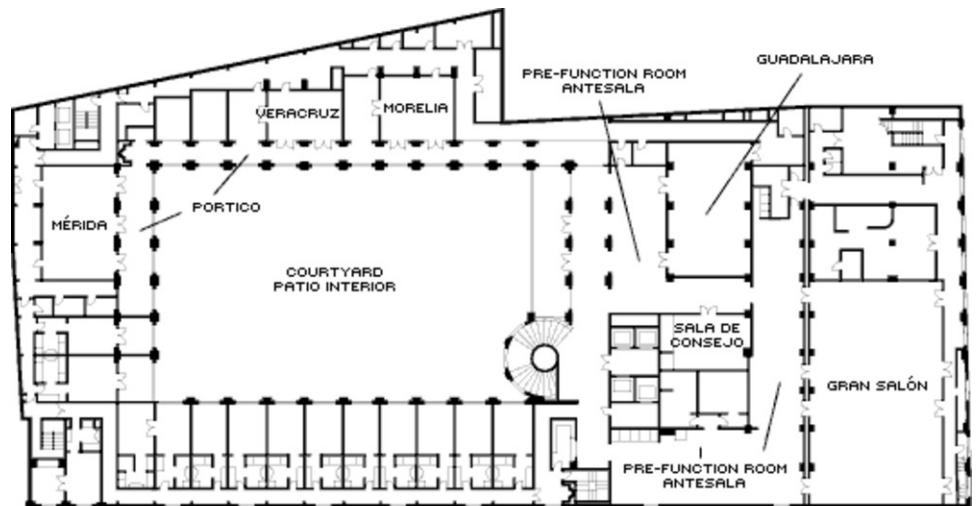

MORELIA

| | |
|------------|---------------------|
| Dimensions | 8.8 x 7.3 m |
| | 28.9 x 23.9 ft |
| Size | 64.2 m ² |
| | 691 sq.ft. |
| Height | 2.8 m |
| | 9.2 ft |

Capacities

| | |
|----------------|----|
| Classroom | 30 |
| Hollow square | 32 |
| U Shape | 25 |
| Theatre | 50 |
| Reception | 60 |
| Banquet Rounds | 50 |

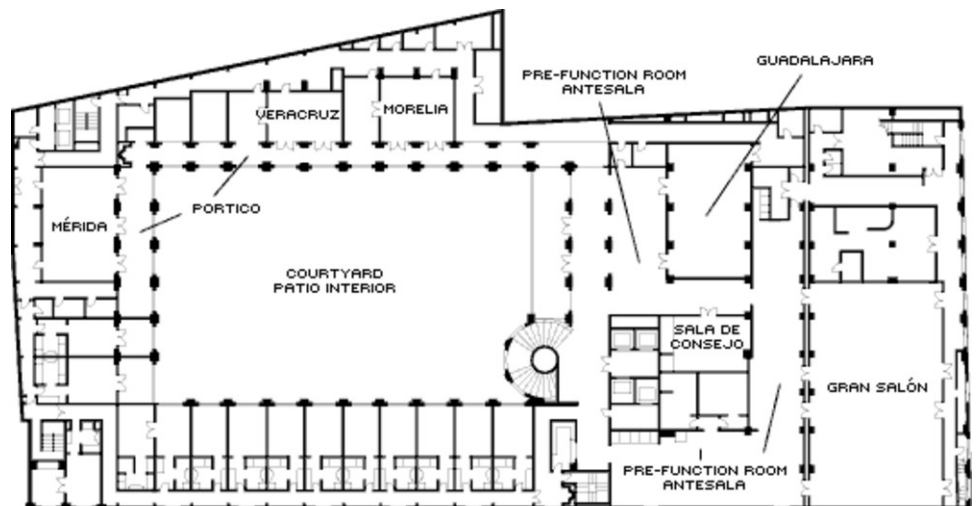

VERACRUZ

| | |
|------------|---------------------|
| Dimensions | 8.8 x 6 m |
| | 28.9 x 19.6 ft |
| Size | 52.8 m ² |
| | 568 sq.ft. |
| Height | 2.8 m |
| | 9.2 ft |

Capacities

| | |
|----------------|----|
| Classroom | 25 |
| Hollow square | 28 |
| U Shape | 20 |
| Theatre | 45 |
| Reception | 50 |
| Banquet Rounds | 40 |

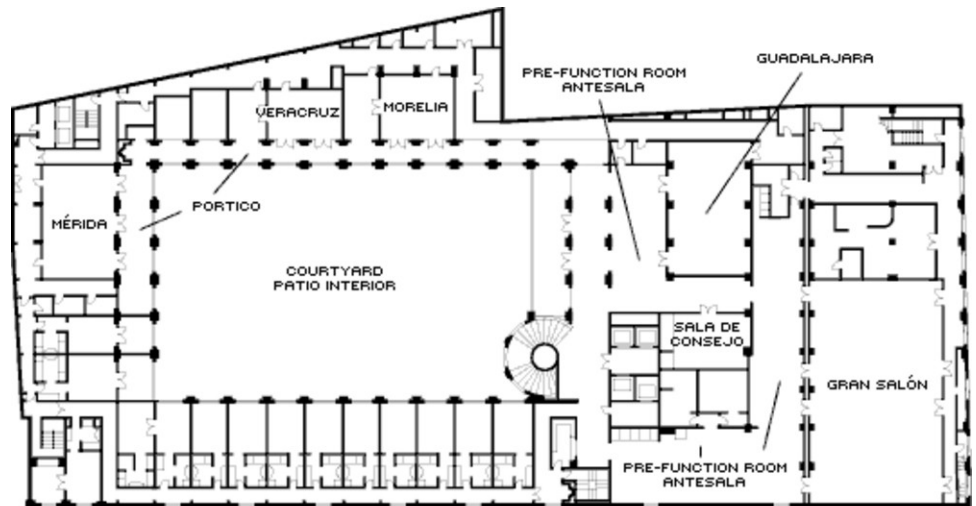

MÉRIDA

| | |
|------------|----------------------|
| Dimensions | 13.3 x 8.6 m |
| | 43.6 x 28.2 ft |
| Size | 114.4 m ² |
| | 1,231 sq.ft. |
| Height | 3.1 m |
| | 10.2 ft |

Capacities

| | |
|----------------|-----|
| Classroom | 50 |
| Hollow square | 45 |
| U Shape | 40 |
| Theatre | 80 |
| Reception | 100 |
| Banquet Rounds | 80 |

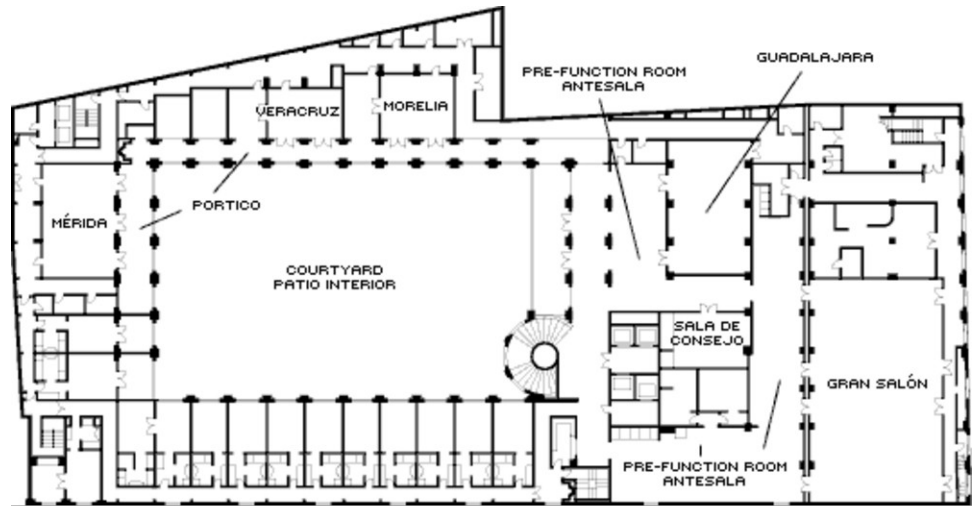

SALA DE CONSEJO

| | |
|------------|---------------------|
| Dimensions | 8.5 x 6.5 m |
| | 27.9 x 21.3 ft |
| Size | 55.2 m ² |
| | 594 sq.ft. |
| Height | 2.8 m |
| | 9.2 ft |

Capacities

| | |
|----------------|----|
| Classroom | 25 |
| Hollow square | 25 |
| U Shape | 16 |
| Theatre | 24 |
| Reception | 30 |
| Banquet Rounds | 30 |

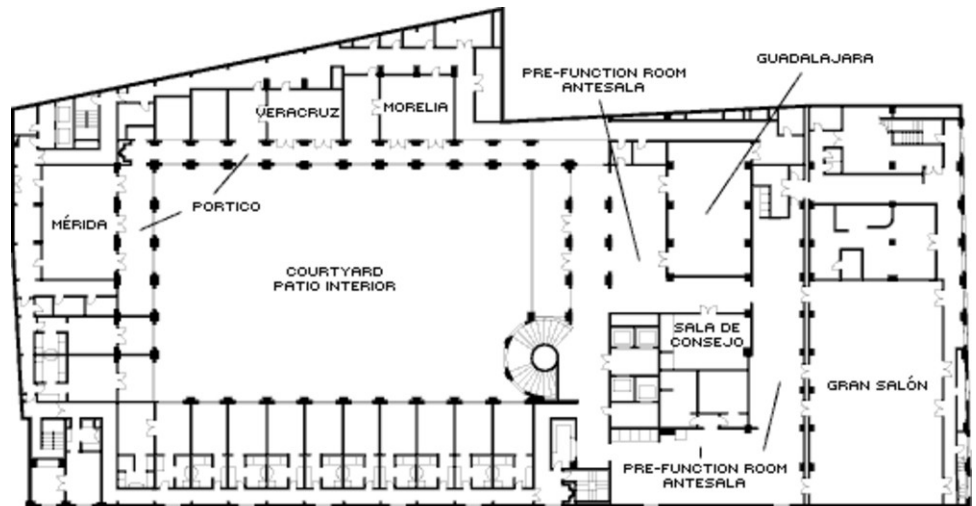

SALA LUNA

Dimensions 3.6 x 4.4 m
11.8 x 14.4 ft
Size 15.8 m²
170.1 sq.ft.
Height 2.2 m
7.2 ft

Capacities

Boardroom 5

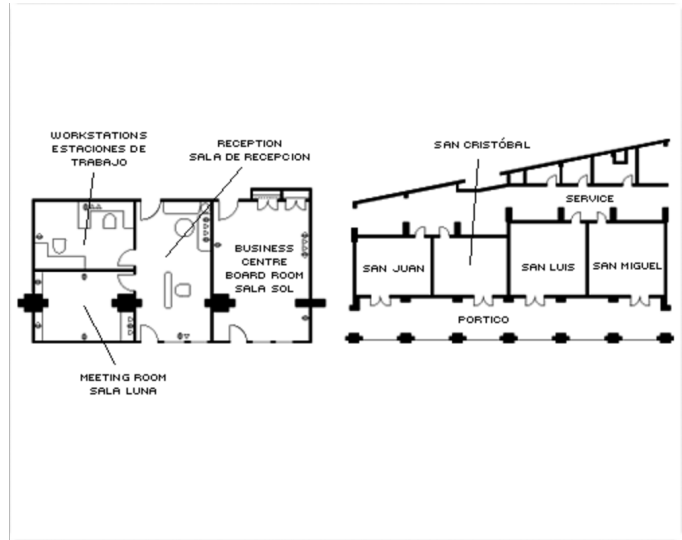

SALA SOL

Dimensions 4.35 x 6.6 m
14.3 x 21.7 ft
Size 28.7 m²
309 sq.ft.
Height 2.14 m
7 ft

Capacities

Boardroom 12

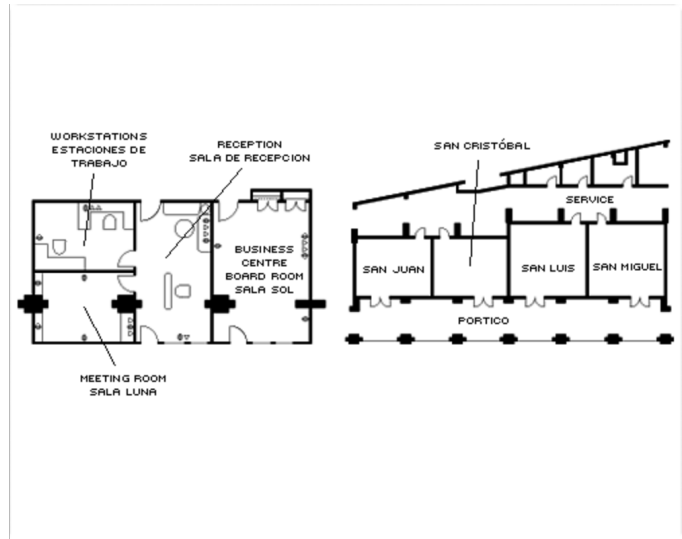

GUEST ROOMS, SUITES AND PRIVATE RESIDENCES OVERVIEW

Four Seasons Hotel México, D.F., offers 240 rooms, including 40 suites, surrounding a beautifully landscaped fountain courtyard near Chapultepec Park and the exclusive Polanco district in Mexico City. With views across the courtyard or of city avenues, accommodations are elegantly appointed.

Standard room features include LCD flat-screen televisions and wireless high-speed Internet access. Full marble bathrooms are designed with a deep soaking tub and a separate shower, as well as a WC in a private alcove.

| <i>Room Category</i> | <i>#</i> | <i>Beds</i> | <i>Size (m²)</i> | <i>View (sq ft)</i> | <i>View</i> |
|--|----------|------------------|---------------------------------|-------------------------|--|
| - Four Seasons Executive Suite – Courtyard View | 12 | 1 King | 71 | 766 | Courtyard |
| - Four Seasons Executive Suite – Reforma View | 12 | 1 King | 66 | 710 | Paseo de la Reforma |
| - Four Seasons Executive Suite – Burdeos View | 7 | 1 King | 66 | 710 | Burdeos Street |
| - Premier Terrace Room | 2 | 1 King | 68 | 730 | Courtyard |
| - Premier Room | 8 | 1 King | 50 | 537 | Courtyard |
| - Deluxe Room | 126 | 1 King or 2 twin | 56 | 602 | Courtyard |
| - Superior Room | 64 | 1 King or 2 twin | 50 | 537 | Paseo de la Reforma or inner courtyard |
| - Presidential Suite | 1 | 1 King | 207 | 2,228 | Paseo de la Reforma |
| - Master Suite Jardin One-Bedroom | 1 | 1 King | 142 | 1,529 | Courtyard |
| - Master Suite Reforma One-Bedroom | 1 | 1 King | 150 | 1,615 | Paseo de la Reforma |
| - One-Bedroom Suite | 6 | 1 King | 93 | 1,005 | Courtyard |

Guest Room Overview

Guest room choices begin with generously proportioned Superior Rooms with enhanced views of the city from the Hotel's upper floors, while more spacious Deluxe Rooms face the peaceful fountain courtyard. Premier Rooms step out onto the second-floor colonnade overlooking the courtyard, and larger Premier Terrace Rooms offer a private balcony. In the Courtyard, Reforma and Burdeos Four Seasons Executive Suites, named for their views, French doors seclude the sleeping quarters from the living room for greater privacy.

Suites Overview

One-Bedroom Suites offer beautiful views of the courtyard from the second-floor colonnade or from the Hotel's upper floors. On the Hotel's topmost floor, one-bedroom Master Suites welcome guests with their blend of ornate antique with contemporary urbane; the Jardin overlooks the courtyard, while the slightly larger Reforma offers views of the city's main avenue. The Presidential Suite accents contemporary elegance and Mexican antiques with flooring of black granite, dark walnut timber and hand-woven carpets. A gold-leafed screen separates the living and dining areas.

FOUR SEASONS EXECUTIVE SUITE –
COURTYARD VIEW

Number 12
Beds King bed
Size 71 m²
766 sq ft

Location
3rd to 8th floors
View
Courtyard

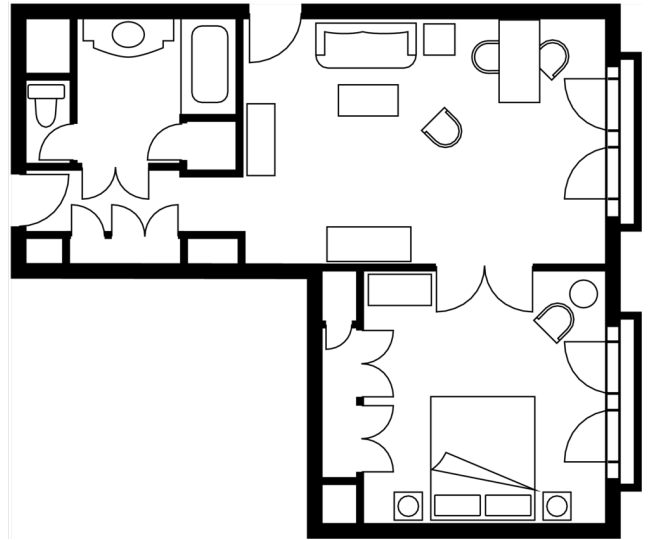

FOUR SEASONS EXECUTIVE SUITE –
REFORMA VIEW

Number 12
Beds King bed
Size 66 m²
710 sq ft

Location
5th to 7th floors
View
Paseo de la Reforma

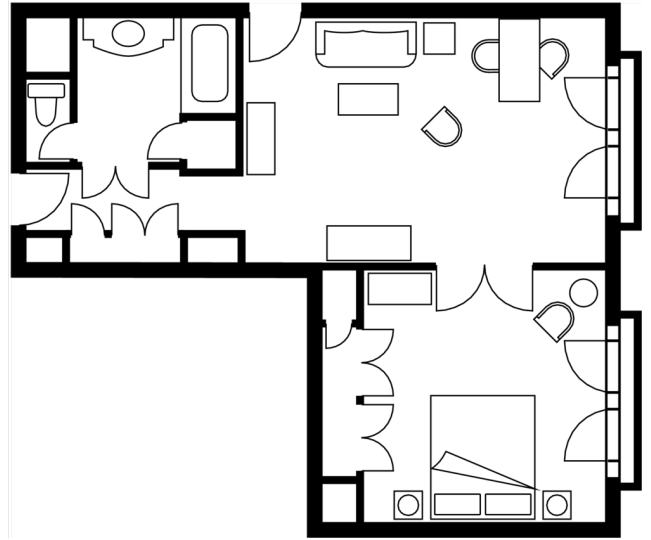

FOUR SEASONS EXECUTIVE SUITE –
BURDEOS VIEW

Number 7
Beds King bed
Size 66 m²
710 sq ft

Location
2nd to 8th floors
View
Burdeos Street

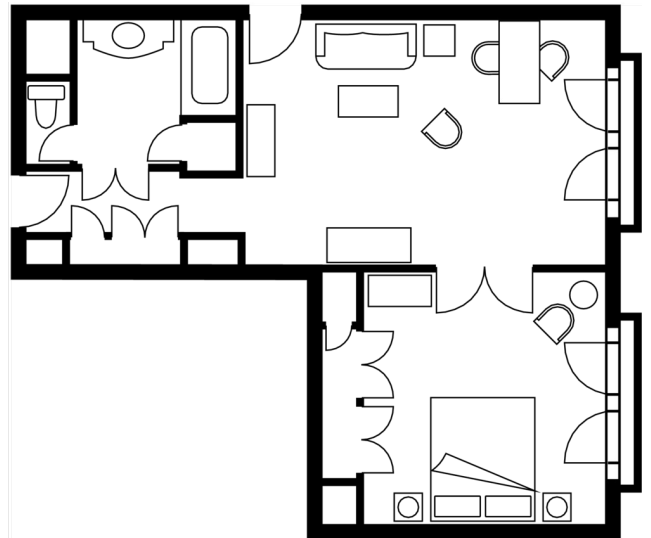

PREMIER ROOM

Number 8
Beds King bed
Size 50 m²
537 sq ft

Location
2nd floor
View
Courtyard

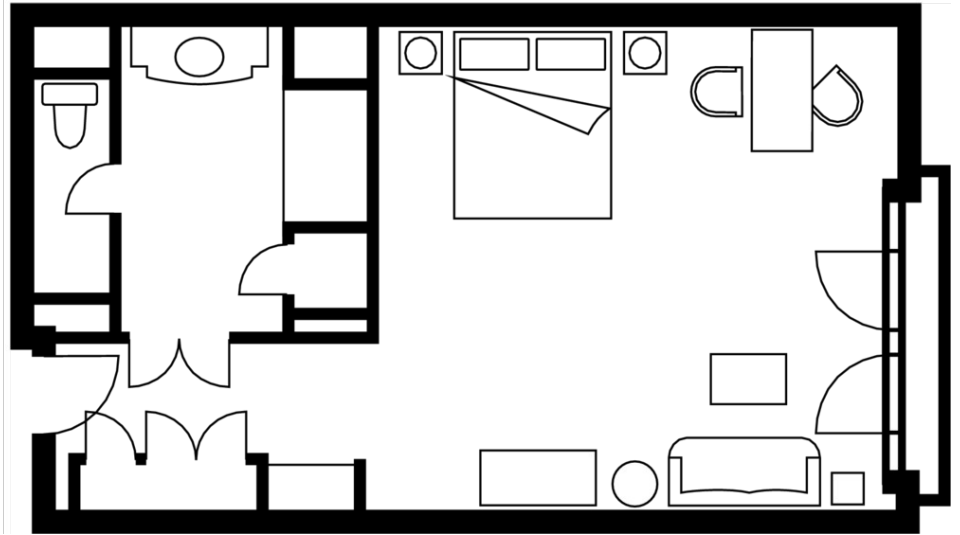

DELUXE ROOM

Number 126
Beds King or two twin beds
Size 56 m²
602 sq ft

Location
Throughout the Hotel
View
Courtyard

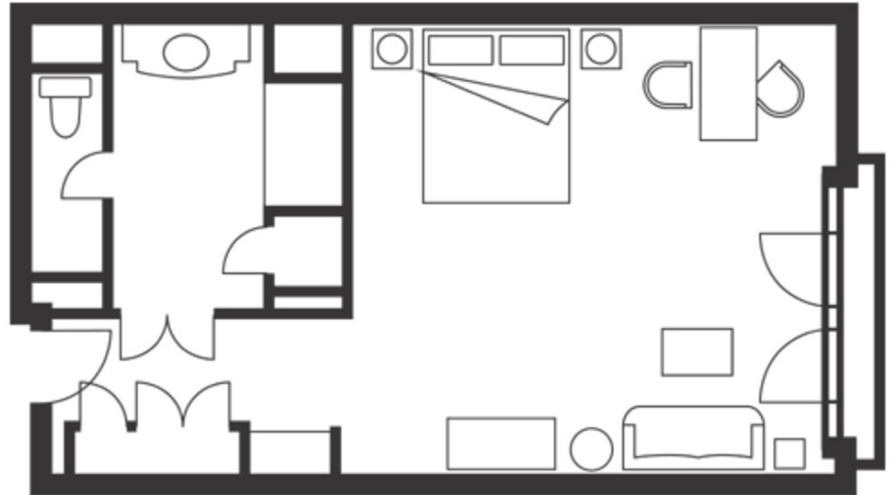

ONE-BEDROOM SUITE

Number 6
Beds King bed
Size 93 m²
1,005 sq ft

Location
4th to 8th floors
View
Courtyard

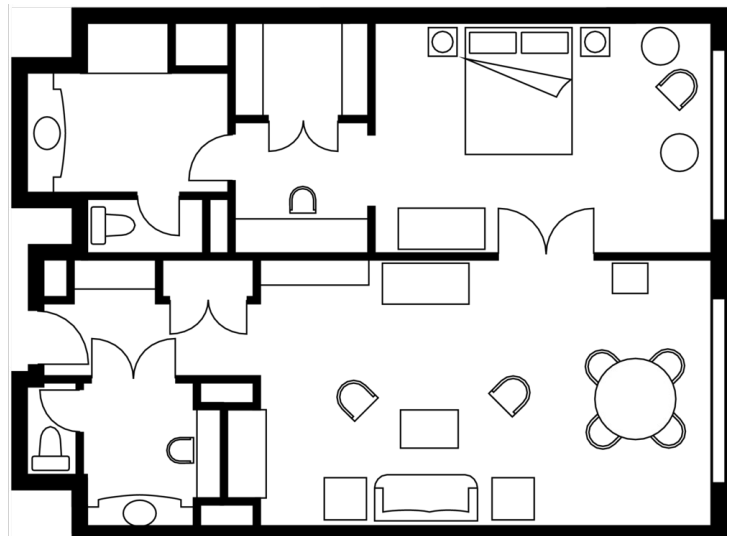

AMENITIES

- All news cable network
- CD player
- Alarm clock
- iPod docking station
- Complimentary newspaper
- Down pillows
- DVD player
- Fax machine on request
- Hair dryer
- Hypo-allergenic duvets on request
- Hypo-allergenic pillows on request
- In-room safe
- Multi-line telephone(s) with voicemail
- Plasma/LCD screen television
- Refrigerated private bar
- Thick terry bathrobes
- Slippers
- Twice-daily housekeeping service
- Web/interactive television
- Wired or wireless Internet access

GUEST SERVICES

- 24-hour In-Room Dining
- 24-hour laundry/dry-cleaning/pressing
- 24-hour multilingual Concierge
- Airport transfers
- Complimentary overnight shoeshine
- Non-smoking rooms
- One-hour pressing
- Private dining room
- Restaurant
- Services and amenities for younger guests
- Umbrellas
- Valet parking

VIP GIFTS AND WELCOME AMENITY

Special arrangements can be made for clients to purchase welcome amenities for their VIP guests, including a large selection of gold or silver jewellery, exquisite Mexican crafts and books on Mexico.

DINING HOURS OF OPERATION

Reforma 500

Breakfast

Monday to Friday 6:30 am - noon

Lunch

Monday to Friday noon - 6:00 pm

Champagne lunch

Sunday 12:30 pm - 4:30 pm

Dinner

Monday to Friday 6:00 pm - 11:00 pm

El Bar

Breakfast

Monday to Friday 7:00 am - noon

Sunday 7:00 am - 1:00 pm

Light fare – lunch and dinner

Monday to Friday noon - 11:00 pm

Sunday 1:00 pm - 11:00 pm

Cocktails and appetisers

Monday to Friday noon - 1:00 am

Sunday 1:00 pm - midnight

In-Room Dining

Breakfast

Every day 6:00 am - 11:00 am

All-day dining

Every day 11:00 am - 6:00 am

Late-night dining

Every day 11:00 pm - 6:00 pm

DINING

The classically landscaped courtyard with its central fountain offers a uniquely tranquil backdrop for dining at Four Seasons – whether Italian-inspired cuisine at Reforma 500 or an executive lunch or fine mezcals at El Bar.

RESTAURANTS

Reforma 500

Reforma 500 features contemporary Mediterranean cuisine in a fascinating setting – simple yet elegant, fun yet relaxed. The service is attentive, friendly and unobtrusive, with an emphasis on efficiency and style.

- Indoor seating: 132, with private dining for 8 or 12 guests
- Outdoor seating: 60

LOUNGES

El Bar

With large, comfortable sofas overlooking the interior courtyard, this refined, relaxed lounge offers the ambience of an English library. El Bar serves an American breakfast buffet and executive lunch (with a menu that changes daily). Light fare, Mexican hors d'oeuvres and appetisers are offered throughout the day. An impressive array of cocktails, fine tequilas and mezcals are yours for the savouring.

- Indoor seating: 45
- Outdoor seating: 23

RECREATION FACILITIES

Revive in the secret oasis of the pool. Relax with a tequila-and-sage massage in the Spa. Explore the Hotel's exclusive weekend cultural tours of historic sites and museums. Or call on resourceful assistance from the multilingual Four Seasons Concierge to create a personalised experience of Mexico's capital.

SPA SERVICES

Relaxing and rejuvenating, the Health Club at Four Seasons Hotel Mexico, D.F. offers the pampering skills of professional massage therapists to eliminate tension and discomfort. Skin and body treatments restore and refresh every inch of your body, from toe to fingertips.

- Number of treatment rooms: 2

FITNESS FACILITIES

The Health Club offers an extensive range of exercise machines and weight-training systems, including computerised Lifecycles and Technogym treadmills. Universal weight machines, incline and flat benches, free weights and colour television monitors with earphones are also available.

- Size: 180 m² / 1,938 sq ft

POOL

The sun deck and the outdoor pool, which is maintained at 27°C (80°F), are adjacent to and can be accessed from the Health Club.

GOLF

Club de Golf Bellavista

This beautiful club is located north of the city, and was designed by Percy Clifford in 1962. It offers golf, tennis, a swimming pool, a restaurant and rooms for events. Please contact the Concierge to make arrangements for the Golf Club one day in advance, before 5:00 pm.

| Rooms | Dimensions | | Size | | Height | | Classroom | Hollow square | U-shape | Theatre | Reception | Banquet rounds | Conference/ boardroom |
|-------------------|------------|--------------|-------------------|---------|--------|------|-----------|---------------|---------|---------|-----------|----------------|-----------------------|
| | (m) | (ft) | (m ²) | (sq ft) | (m) | (ft) | | | | | | | |
| - San Juan | 6.6 x 5.2 | 21.6 x 17 | 34.3 | 369 | 2.8 | 9.2 | 15 | 15 | 12 | 25 | 20 | 20 | 14 |
| - San Cristobal | 6.6 x 5.2 | 21.6 x 17 | 34.3 | 369 | 2.8 | 9.2 | 15 | 15 | 12 | 25 | 20 | 20 | 14 |
| - San Luis | 6.6 x 6.5 | 21.6 x 21.3 | 42.9 | 462 | 2.8 | 9.2 | 20 | 18 | 15 | 30 | 30 | 30 | 16 |
| - San Miguel | 6.6 x 6.5 | 21.6 x 21.3 | 42.9 | 462 | 2.8 | 9.2 | 20 | 18 | 15 | 30 | 30 | 30 | 16 |
| - Querétaro | 15 x 8.6 | 161.4 x 92.5 | 127.5 | 1,372 | 3 | 9.84 | 40 | 34 | 30 | 60 | 130 | 60 | 28 |
| - Gran Salón | 26.2 x 15 | 86 x 49.2 | 393 | 4,229 | 4.3 | 14 | 250 | 150 | 120 | 450 | 500 | 320 | 130 |
| - Gran Salón A | 13.1 x 15 | 43 x 49.2 | 196.5 | 2,115 | 4.3 | 14.1 | 120 | 60 | 50 | 210 | 180 | 160 | 65 |
| - Gran Salón B | 13.1 x 15 | 43 x 49.2 | 196.5 | 2,115 | 4.3 | 14.1 | 120 | 60 | 50 | 210 | 180 | 160 | 65 |
| - Guadalajara | 16.2 x 9.8 | 53 x 32 | 158.8 | 1,709 | 3.1 | 10.2 | 80 | 60 | 50 | 150 | 150 | 120 | 45 |
| - Morelia | 8.8 x 7.3 | 28.9 x 23.9 | 64.2 | 691 | 2.8 | 9.2 | 30 | 32 | 25 | 50 | 60 | 50 | 22 |
| - Veracruz | 8.8 x 6 | 28.9 x 19.6 | 52.8 | 568 | 2.8 | 9.2 | 25 | 28 | 20 | 45 | 50 | 40 | 20 |
| - Mérida | 13.3 x 8.6 | 43.6 x 28.2 | 114.4 | 1,231 | 3.1 | 10.2 | 50 | 45 | 40 | 80 | 100 | 80 | 34 |
| - Sala de Consejo | 8.5 x 6.5 | 27.9 x 21.3 | 55.2 | 594 | 2.8 | 9.2 | 25 | 25 | 16 | 24 | 30 | 30 | 16 |
| - Sala Luna | 3.6 x 4.4 | 11.8 x 14.4 | 15.8 | 170.1 | 2.2 | 7.2 | - | - | - | - | - | - | 5 |
| - Sala Sol | 4.35 x 6.6 | 14.3 x 21.7 | 28.7 | 309 | 2.14 | 7 | - | - | - | - | - | - | 12 |