



## Quick Reference Guide

---

Last updated May 3, 2012 | For additional information please contact the hotel directly

---

Four Seasons Hong Kong  
8 Finance Street, Central, Hong Kong, China  
Tel 852.3196.8888 | Fax 852.3196.8899

[www.fourseasons.com/hongkong](http://www.fourseasons.com/hongkong)



8 Finance Street  
Central, Hong Kong, China  
Tel 852.3196.8888  
Fax 852.3196.8899

#### AIRPORTS

- Hong Kong International Airport (HKG): 45 minutes (by car) 24 minutes by Airport Express (train) (40 kilometres/25 miles)
- Macau Ferry Terminal (Shun Tak building): 15 minutes' walk (1.2 kilometres/0.75 miles)
- Airport Express – Central: 9 minutes' walk (0.25 kilometres/0.15 miles)

#### TABLE OF CONTENTS

- 2 Introduction
- 4 Destination
- 10 Conference Facilities
- 19 Guest rooms, Suites and Private Residences
- 25 Dining
- 27 Recreational Facilities
- 30 Incentive Activities
- 32 Appendix: Conference Chart

The gateway to China and the Far East, Hong Kong is a fast-moving fusion of Eastern and Western cultures – and one of the world's most exciting cities. Perfectly placed within the prestigious International Finance Centre (IFC), overlooking Victoria Harbour, Four Seasons offers sleek sophistication and easy access to all that Hong Kong has to offer.



Four Seasons Hotel Hong Kong encompasses 399 spacious guest rooms and suites – all with sweeping views of Victoria Harbour and Kowloon or Victoria Peak and the city. On the 45th floor, premium privileges are offered in the welcoming environment of the Executive Club Lounge.

Culinary delights in five harbour-view dining options range from creative French fare at Caprice – awarded three Michelin stars – to modern Asian interpretations, as well as the first Chinese restaurant to receive three Michelin stars, Lung King Heen. Well-designed function space, including two majestic ballrooms, easily accommodates large gatherings. To unwind, work out in the 24-hour fitness centre or escape to the serenity of the pool terrace, where open-air pools – heated in winter – seem to pour into the harbour. In one of the region's most lavish spas, Asian-inspired treatments calm the senses. Housed in Hong Kong's most prominent landmark, Four Seasons Hotel Hong Kong provides an

instinctive choice for business and leisure guests.

#### TRANSPORTATION

Hong Kong International Airport at Chek Lap Kok on Lantau Island is one of the world's most advanced airports, offering a comprehensive range of facilities and services. As the world's fifth busiest international passenger airport and the most active air cargo operation worldwide, the airport services 85 airlines, linking Hong Kong with more than 150 locations around the world, including over 40 cities in mainland China.

The airport operates around the clock and is the primary hub for Cathay Pacific Airways, which provides service to the rest of Asia, Australia, New Zealand, the Middle East, Europe, South Africa and North America. Dragonair and a number of smaller airlines service the region, including mainland China.

The Airport Express train, which can be accessed directly from the airport terminal building, is one of the most convenient ways to arrive at the Hotel. The train departs every 12 minutes, and reaches Hong Kong Station in 24 minutes. The Hotel is a three-minute walk from the station, through the IFC mall.

Limousine service is available to and from the airport and may be arranged at the time of reservation or through the Concierge. Guests who book a limousine pick-up from the airport to the Hotel will be greeted by an airport representative as they leave the aircraft, and be escorted to the immigration counters. The representative will also assist them with baggage claim and accompany them to their waiting limousine.

Limousine service options include:

- Mercedes Benz S350/S320 – HKD 950.00 per vehicle, one way, maximum 3 passengers
- Bentley Arnage – HKD 2,000.00 per vehicle, one way, maximum 4 passengers
- Toyota Alphard MPV – HKD 1,100.00 per vehicle, one way, maximum 6 passengers
- Coach – HKD 1,550.00 per vehicle, one way, maximum 43 passengers

Limousine service is also available on an hourly basis in and around Hong Kong. Please contact the Concierge for details.

---

---

WEATHER CHART

---

Month	°C Highs/Lows	°F Highs/Lows
January	19 / 14	67 / 58
February	19 / 15	67 / 59
March	21 / 17	71 / 63
April	25 / 20	77 / 69
May	28 / 23	83 / 75
June	30 / 26	86 / 79
July	31 / 27	89 / 81
August	31 / 27	89 / 81
September	30 / 26	87 / 79
October	28 / 23	83 / 75
November	24 / 19	76 / 67
December	21 / 15	70 / 60

---

DESTINATION

Surrounded by the South China Sea, Hong Kong is the gateway to China and the Far East. Comprising Hong Kong Island, Kowloon, the New Territories and the 234 Outlying Islands, Hong Kong was first settled by the Han Chinese in the seventh century. It was ceded to Britain in 1842 and remained a British colony until 1997. After reverting to Chinese rule, Hong Kong became a Special Administrative Region and now has a great deal of autonomy.

With a population of almost seven million, Hong Kong is a fusion of Eastern and Western cultures. Cantonese and English are the official languages, although many people also speak Mandarin. The Asia-Pacific headquarters for banking, commerce, manufacturing and tourism, Hong Kong is renowned for its prime shopping, fine dining and dynamic nightlife.

In addition to being one of the world's most important business hubs, Hong Kong has a rich history and culture – and its rugged mountainous landscape offers many peaceful areas for hiking and camping. Four Seasons guests enjoy the combined advantage of staying at the city's most exclusive hotel while experiencing with ease all that Hong Kong has to offer.

WEATHER

Due to its subtropical location, Hong Kong's weather is generally mild in winter and hot and humid in summer, with an average annual rainfall of 226 centimetres (89 inches). Late September to early December is very pleasant with clear, sunny skies and lower humidity levels. January and February are the coldest months, yet it is still a pleasant time of year. In the spring, the temperatures and humidity start to rise. By summer, temperatures can reach the 30s (90s).

LOCAL ATTRACTIONS AND ACTIVITIES

At Four Seasons, guests enjoy a unique vantage point from which to explore all the surrounding sights, sounds and experiences. We hope the highlights of local attractions below help simplify your planning. Please let us know how else we can assist you.

*Within a few minutes walk of the Hotel*

Victoria Harbour:

- Victoria Harbour is one of the busiest and most impressive natural harbours in the world. The spectacular backdrop of the Hong Kong skyline becomes even more impressive as darkness falls and the dazzling neon lights make the city glitter. One of the best ways to experience it is on board the popular Star Ferry between Central and Tsim Sha Tsui. Cruises set sail from piers on either side of Victoria Harbour in the morning, afternoon, evening and at sunset.

International Finance Centre:

- The city's most prominent architectural landmark with its 88-storey tower, the IFC mall is accessible by elevator from the Hotel. The complex encompasses fashion boutiques selling the world's premium brands, specialty stores, excellent restaurants and a cinema.

*Within a 10-minute walk of the Hotel*

**Pedder Building:**

- This historic building has six storeys of shops, featuring factory outlets and Italian and French designer shops. Other specialty stores carry cashmere, silks, jewellery and embroidery.

**Lan Kwai Fong :**

- This upbeat neighbourhood has narrow streets lined with Western-style restaurants, nightclubs, and bars. Together with nearby lanes that are also lively with bistros and pubs, Lan Kwai Fong makes up Hong Kong's most fashionable nightlife area.

**SoHo :**

- SoHo, south of Hollywood Road, is a lively neighbourhood with many bars and fashionable restaurants serving cuisines from around the world. Hollywood Road and Upper Lascar Row are crammed with antique shops and open-air stalls offering everything from Ming furniture and lotus lamps to Mao badges and old snuff bottles. Above SoHo, Mid-Levels is an exclusive residential area on the lower slopes of Victoria Peak (usually known simply as The Peak). The Central-Mid-Levels Escalator, which is the longest covered outdoor escalator system in the world, provides easy access to and from the Central district, as well as an intriguing glimpse of the area's street life.

*Within a 10-minute drive of the Hotel*

**Causeway Bay:**

- Causeway Bay is one of Hong Kong's most popular shopping districts, with Japanese department stores, the trendy boutiques of Fashion Walk and the ultra-modern Times Square.

*Within a 15-minute drive of the Hotel*

**Happy Valley Racecourse:**

- Happy Valley Racecourse is an oasis of green in the middle of the city. Offering the only legal form of gambling in Hong Kong, the racecourse attracts large, enthusiastic crowds during the racing season, from September to late June.

*Within a 20-minute drive of the Hotel*

**Hong Kong Museum of Art:**

- The Hong Kong Museum of Art celebrates China's cultural heritage through an impressive collection of over 13,000 works of art including Chinese paintings and calligraphy works, antique Chinese treasures, historical paintings and creations by local artists.

**Hong Kong Science Museum:**

- Most of the 500-plus exhibits at the Hong Kong Science Museum are interactive, revealing the mysteries of a wide range of science-related subjects. The focus of the museum is the 20-metre (66-foot) Energy Machine. It produces spectacular audiovisual effects demonstrating various forms of energy.

**Hong Kong Museum of History:**

- One of the city's most recent additions, the Hong Kong Museum of History showcases 6,000 years of history focusing on the territory's archaeology, natural history, ethnography and local history.

Victoria Peak :

- Victoria Peak (often known simply as "The Peak") is Hong Kong's premier visitor attraction with one of the world's most stunning cityscapes. At 550 metres (1,805 feet) above sea level, it offers dazzling views of Hong Kong Island, the harbour, Kowloon and the hills beyond. At the top, in the Peak Tower, there are over 10,405 square metres (112,000 square feet) of shopping, dining and some of the city's best entertainment attractions. The wok-shaped building is a Hong Kong icon. Stroll through Ripley's Believe It or Not Odditorium, and Madame Tussauds – the famous wax museum from London. You can reach Victoria Peak via the Peak Tram and enjoy fabulous views on the way. The tram station is a short drive from the Hotel. Trams operate daily every 15 minutes.

Hong Kong Space Museum :

- One of the world's largest and most technically sophisticated planetariums, the Hong Kong Space Museum is enjoyed equally by children and adults. A prominent city landmark, its dome holds the Hall of Space Science, the Hall of Astronomy and the Space Theatre Planetarium. The wonders of space science and astronomy come alive, via the high-tech displays in two interactive exhibition halls. Thrilling wide-screen Omnimax and Sky Show movies play in the Space Theatre. Each presentation is shown in English; headphones for simultaneous translation in Cantonese, Mandarin and Japanese are available free of charge.

Avenue of Stars:

- At the southern tip of Kowloon, on the Tsim Sha Tsui promenade, the Avenue of Stars pays homage to the Hong Kong film industry and its stars, and also offers some of the best views of Victoria Harbour and Hong Kong Island. It is also the best place from which to view the Symphony of Lights laser light show, which starts at 8:00 pm nightly.

*Within a 25-minute drive of the Hotel*

Aberdeen:

- This bustling waterfront town is located on one of the southern tips of Hong Kong Island. Two centuries ago, Aberdeen was a pirates' den, and later it became a simple fishing village. Today, it is a modern, vibrant area of Hong Kong. Fishing life is still popular, and traditional boats are in abundance, acting as floating homes for thousands of people. Docked side by side in the harbour, they are a contrast to the modern high-rise communities visible on the hillside above. For a closer look at Aberdeen life, take a sampan ride, or head to a floating restaurant for a delicious seafood meal.

Repulse Bay:

- With its resort-like atmosphere and breathtaking views, Repulse Bay has one of the most popular beaches on Hong Kong Island. Around the bay are luxury apartment blocks, shops, restaurants, the famous Repulse Bay Hotel and an unusual shrine to Kwun Yam, the Goddess of Mercy.

*Within a 30-minute drive of the Hotel*

Ocean Park:

- Ocean Park is a huge oceanarium and theme park, with more than 40 major attractions – from roller coasters to an Atoll Reef and a giant panda habitat. A cable car connecting the lowland and headland sections of the park offers tremendous views of Hong Kong and the South China Sea.

Yuen Po Street Bird Garden :

- The popular Yuen Po Street Bird Garden is where locals go to show off their prized songbirds. Showcased in ornate cages, the birds are pampered and often fed honey nectar to sweeten their songs. There are about 70 stalls selling a wide range of bird paraphernalia, from cages to bird snacks.

*Within a 35-minute drive of the Hotel*

Wong Tai Sin Temple :

- Wong Tai Sin Temple is a large and vibrant Taoist temple. Dedicated to a god who is worshipped by business people, the sick and those trying to stay well, it is constantly abuzz with people praying and fortunetellers divining the future through chim (fortune sticks) or palm readings. The temple also has a lovely park called the Good Wish Gardens – a peaceful green spot with waterfalls tumbling over rocks.

Stanley Market and Murray House:

- Stanley's open-air markets are famous for their bargains in silk garments, sportswear, jewellery and crafts. The narrow streets are always crowded, and bargaining is de rigueur. After you've worked up an appetite, a variety of restaurants and bars awaits in nearby Stanley Main Street. Stanley is also home to waterfront restaurants beside the beach and historic (1842) Murray House – an elegant European-style building that was dismantled in 1982 to make way for another building, and eventually painstakingly reassembled at its present site.

*Within a 45-minute drive of the Hotel*

Hong Kong Heritage Museum:

- The award-winning Hong Kong Heritage Museum has magnificent displays on Cantonese opera, the cultural heritage of the New Territories, a Children's Discovery Centre, and an impressive art collection.

New Territories:

- The New Territories lie between the Kowloon hills and the boundary with mainland China. It is a fascinating area to visit, with temples, theme parks and Hong Kong's highest mountain peak, Tai Mo Shan.

*Within a 1-hour drive of the Hotel*

Hong Kong Disneyland:

- On Lantau Island, Hong Kong Disneyland is easily accessed and features the best rides, shows and attractions from Disney parks around the world.

Ngong Ping 360:

- The Ngong Ping 360 cable car is accessed from Tung Chung on Lantau Island. During the 5.7-kilometre (3.5-mile) cable car ride, visitors enjoy panoramic views of Lantau's mountainous terrain as they journey to a cultural themed village and Tian Tan Buddha, the world's largest seated outdoor bronze Buddha statue.

*Within a 1.5-hour drive of the Hotel*

Shenzhen:

- Once a simple fishing village, Shenzhen is a thriving metropolis of seven million on the Chinese mainland, boasting numerous historic sites as well as excellent shopping and bargain hunting. Take in one of Shenzhen's three theme parks – Splendid China, the China Folk Culture Village and Windows of the World, each with its own unique features. You can reach Shenzhen by bus or train to the boundary, where a bridge leads into Shenzhen City.

*Within a 30-minute boat ride of the Hotel*

Lamma Island:

- Lamma Island, also known as Po Liu Chau, is Hong Kong's third largest island and is enjoyed for its laidback lifestyle and natural beauty. The most popular area on the island is Yung Shue Wan, a pretty, tree-shaded village where the streets are lined with small restaurants, pubs and shops.

*Within a 1-hour boat ride of the Hotel*

Outlying Islands:

- The Outlying Islands showcase a way of life that has remained unchanged for decades, their countryside and fishing villages a marked change of pace from the hectic city. Cheung Chau is a densely populated island with a thriving fishing community, and is home to Hong Kong's famous Bun Festival. Just a short ferry ride away is Lantau Island, home to great beaches, spectacular mountain walks and the world's largest seated outdoor bronze Buddha. Peng Chau is a small, flat island with a floating community of fishermen.

Macau:

- Macau, on China's southeast coast, combines the cultures of East and West with colourful Chinese shops all vying for attention with distinctive colonial architecture. With a rich 400-year history of coexistence between Portugal and China, its fusion of Asian and Mediterranean cultures makes for a fascinating getaway. The historic centre of Macau is designated a World Heritage Site and the territory's casinos are also a major attraction for visitors from China and Hong Kong.

*Within a 1-hour boat ride and drive of the Hotel*

Tian Tan Buddha:

- One of Hong Kong's must-see attractions is the world's largest seated outdoor bronze statue of Buddha, the *Big Buddha*. Climb the 260 steps from Po Lin Monastery up to the majestic Buddha, which stands 26 metres (85 feet) high and took 10 years to complete. Weighing 220 tonnes (242 tons), it was unveiled in 1993 and, aside from attracting Buddhists from across Asia, the magnificent statue has transformed the

remote monastery into a popular tourist attraction.

CONFERENCE FACILITIES OVERVIEW

Total Space	2,000 m <sup>2</sup> 21,528 sq.ft.
Largest Ballroom	731 m <sup>2</sup> 7,865 sq.ft.
Meet and Feed (max. capacity)	360
Breakouts	7
Banquet (max. capacity)	456
Outdoor Banquet (max. capacity)	-
Private Dining (max. capacity)	12

CONFERENCE FACILITIES

Four Seasons Hotel Hong Kong provides a meeting place of remarkable convenience and prestige. Within a landmark setting overlooking Victoria Harbour, the Hotel's 2,000 square metres (21,528 square feet) of versatile function space is ideal for conferences, incentive events and galas for up to 800 people. Two ballrooms, designed in sleek contemporary style, both command breathtaking views of Victoria Harbour and the Kowloon peninsula, while eight well-designed meeting rooms can be adapted to suit a variety of gatherings for up to 80 guests – including three dedicated Boardrooms, and the sumptuous Peak Suite on the 45th floor. Experienced Four Seasons event coordinators supervise every detail to ensure a flawless gathering.

Fifth floor

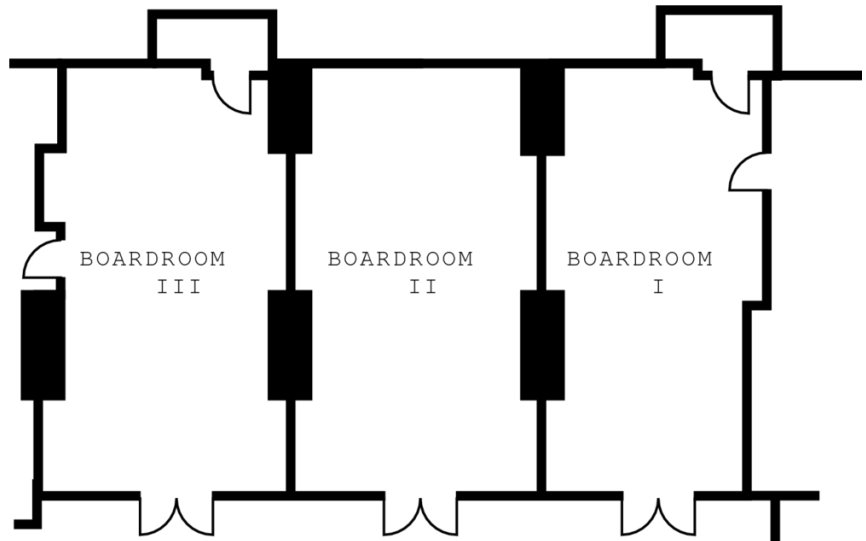

Fourth floor

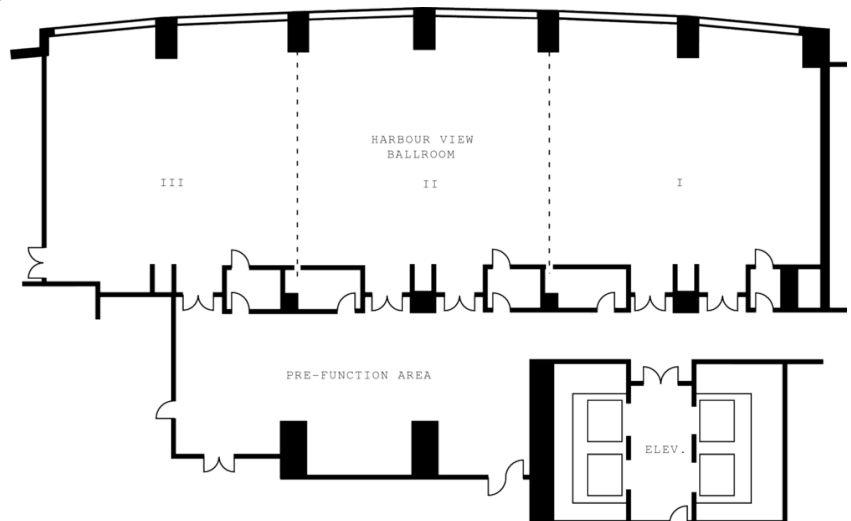

Second floor

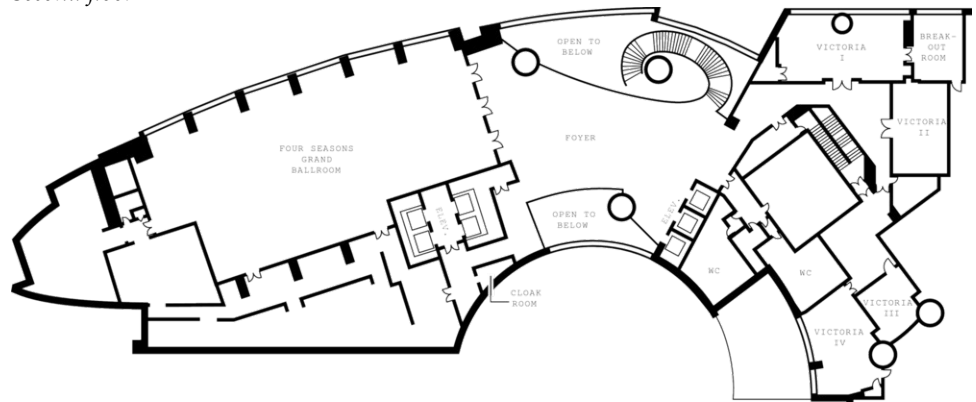

Peak Suite

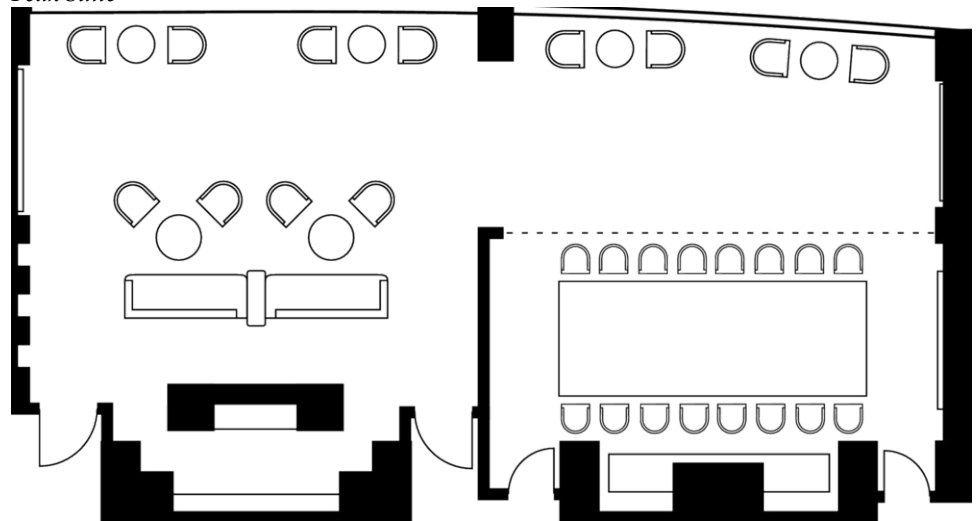

TECHNICAL ASSISTANCE

Set apart in a distraction-free environment, all meeting spaces at the Hotel are fully equipped to support the most technologically demanding presentations, with advanced lighting, audiovisual and staging capabilities. Telecommunications and electrical hook-ups are designed to meet or exceed industry standards. Voltage is 220.

State-of-the-art audiovisual equipment includes:

- Lecterns with light and sound controls
- Dedicated telephone lines available on request
- Motion picture projectors, slide projectors, overhead projectors
- Mono, stereo and multi-track tape recorders
- Video cameras, video projectors, video players
- Multi-image dissolve units and programmers
- Video/teleconferencing

- Personal computers
- Wired or wireless Internet access in meeting rooms

#### MUSIC AND ENTERTAINMENT

Our conference coordinators will be happy to assist with setting up any type of music or entertainment for your meetings.

#### RECEIVING AND MAINTENANCE

The Hotel features a full-service shipping and receiving office. All packages should be sent to the attention of your group's name and its Conference Service Manager. They will be stored in a separate conference storage area. Limited space is available for the storage of large items. Please time shipping to the dates of your arrival.

##### *Receiving dock*

Please contact your Conference Service Manager for special arrangements for delivery of oversized packages or environmentally sensitive equipment.

##### *Post-conference shipping*

Shipping of post-conference materials may be coordinated through your Conference Service Manager.

##### *Maintenance*

The Engineering Department is available 24 hours per day for general assistance with lighting, room temperature control and minor repairs.

#### DESTINATION MANAGEMENT

Our conference coordinators can help accommodate your group's special requests. For detailed information, please contact the Hotel directly. In addition, we recommend the following destination management companies:

##### *Pacific World Ltd.*

Suites 2603-05, 26th Floor Peninsular Tower  
538 Castle Peak Road  
Kowloon, Hong Kong  
Telephone: (852) 2370-1888  
Fax: (852) 2370-1777

##### *Abercrombie & Kent Hong Kong Ltd.*

19th Floor, Gitic Centre  
28 Queen's Road East  
Wan Chai, Hong Kong  
Telephone: (852) 2865-7818  
Fax: (852) 2866-0556

#### BUSINESS SERVICES

Around the clock, Four Seasons can assist you with business, entertainment or travel arrangements through the Business Centre and our resourceful, multilingual Concierge.

- 24-hour business centre
- Business equipment
- Computers

- Executive Club
- Meeting and function space
- Secretarial service
- Wired or wireless Internet access in meeting rooms

#### SPOUSE PROGRAMMES

The Hotel offers a variety of activities of interest to spouses of meeting participants. The Concierge will provide detailed information on specially tailored spouse programmes, including the following:

- A day at the Spa
- An escorted tour of Hong Kong's markets
- A shopping tour
- A day at the races
- A cruise to Aberdeen, including lunch on a floating restaurant
- Excursion to the New Territories, including the Ten Thousand Buddhas Monastery
- Hiking on Lantau
- A tour of Lamma Island
- A daytrip to Macau

#### CHILDRENS AND FAMILY PROGRAMMES

Four Seasons Hotel Hong Kong offers a perfect base for families visiting the area, and extends an especially warm welcome to its young guests by providing special amenities such as cookies and milk, smiley-face macaroons, homemade marshmallows and Japanese rice crackers. A wide selection of children's DVDs is available, as well as colouring books and crayons in the Hotel restaurants. Complimentary items include bottles and toiletries for infants, high chairs, kid-sized terry bathrobes, strollers and bottle warmers. Items to childproof guest rooms can also be provided. Babysitting services may be arranged through the Concierge.

Children's menus are available in the restaurants and through In-Room Dining, with careful attention paid to providing nutritionally balanced meals. Children under the age of 12 may enjoy the Hotel's infinity pool when accompanied by an adult. The Concierge will also advise on off-site activities to create special memories for the entire family. Possibilities include exploring the Peak, visits to Hong Kong Disneyland and numerous child-oriented museums, and lessons in kung fu and Chinese calligraphy.

**FOUR SEASONS GRAND BALLROOM**

Dimensions	19 x 37.3 m
	62.3 x 122.4 ft
Size	708 m <sup>2</sup>
	7,620 sq.ft.
Height	8 m
	27 ft

*Capacities*

Classroom	320
Hollow square	90
U Shape	90
Theatre	600
Reception	800
Banquet Rounds	456

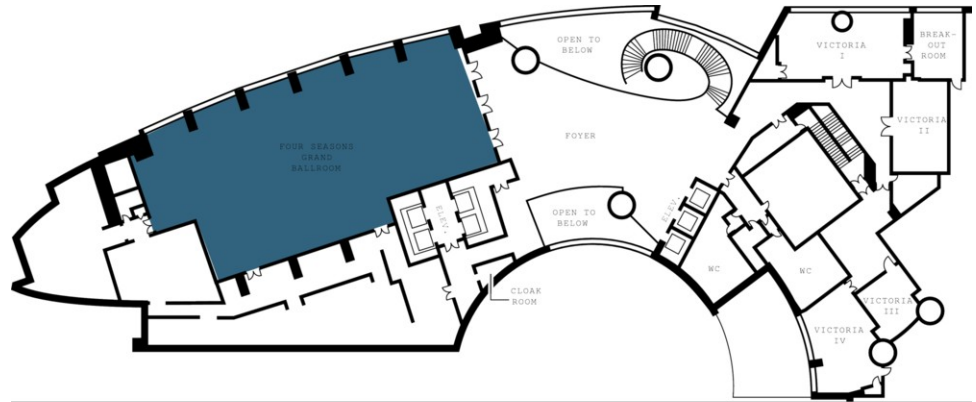

**FOUR SEASONS GRAND BALLROOM  
PRE-FUNCTION AREA**

Dimensions	10 x 25 m
	32.8 x 82 ft
Size	250 m <sup>2</sup>
	2,690 sq.ft.
Height	2.8 - 8 m
	9 - 26 ft

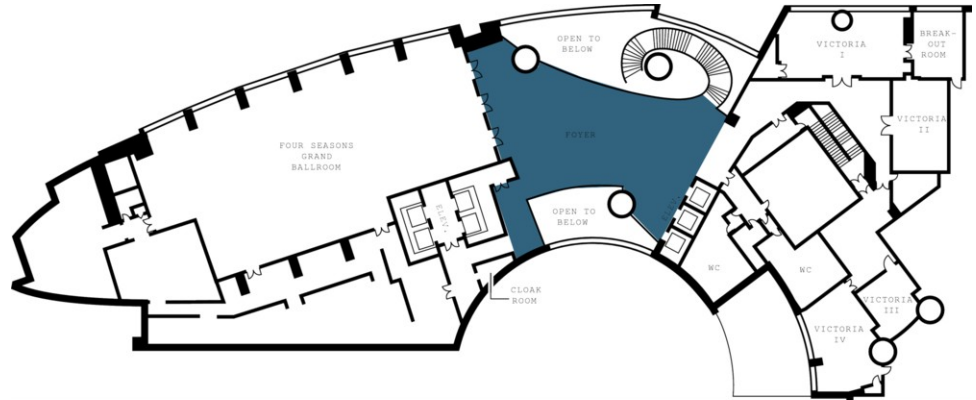

**VICTORIA I**

Dimensions	7.6 x 14 m
	24.9 x 45.9 ft
Size	106 m <sup>2</sup>
	1,140 sq.ft.
Height	3 m
	10 ft

*Capacities*

Classroom	36
Hollow square	30
U Shape	27
Theatre	80
Reception	80
Banquet Rounds	48

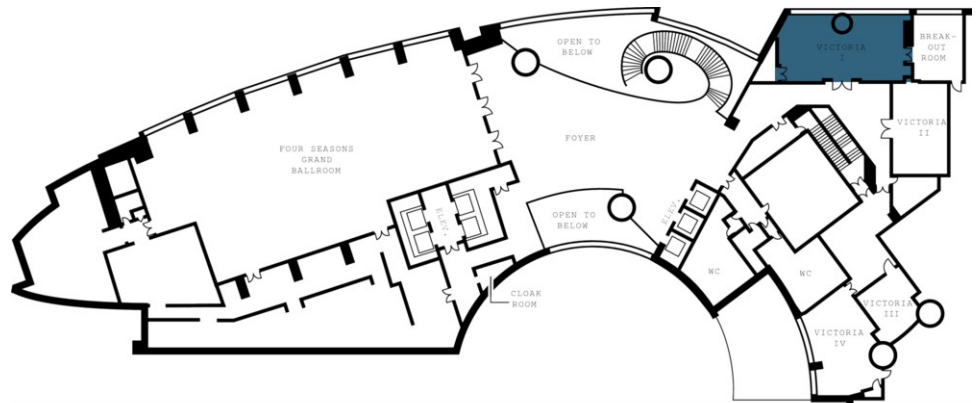

**VICTORIA II**

Dimensions	6 x 10 m 19.7 x 32.8 ft
Size	60 m <sup>2</sup> 645 sq.ft.
Height	3 m 10 ft

*Capacities*

Classroom	24
Hollow square	20
U Shape	16
Theatre	50
Reception	60
Banquet Rounds	24

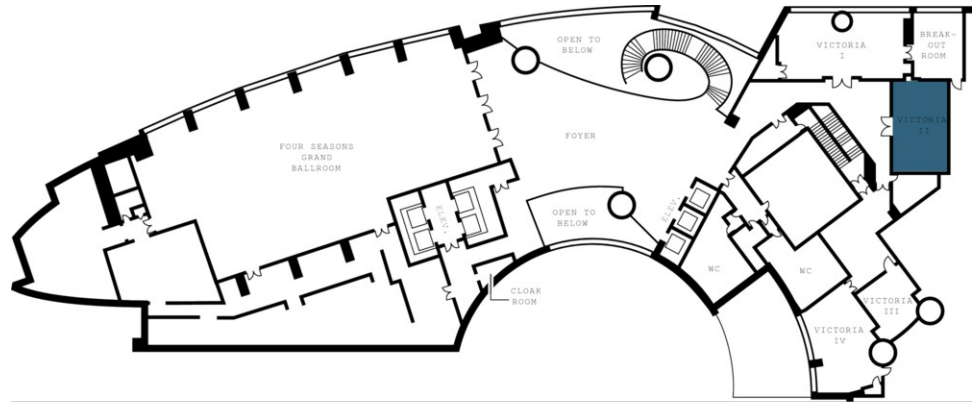

**VICTORIA III**

Dimensions	6 x 6 m 19.7 x 19.7 ft
Size	36 m <sup>2</sup> 387 sq.ft.
Height	3 m 10 ft

*Capacities*

Classroom	12
Theatre	30
Reception	30
Banquet Rounds	12
Boardroom	10

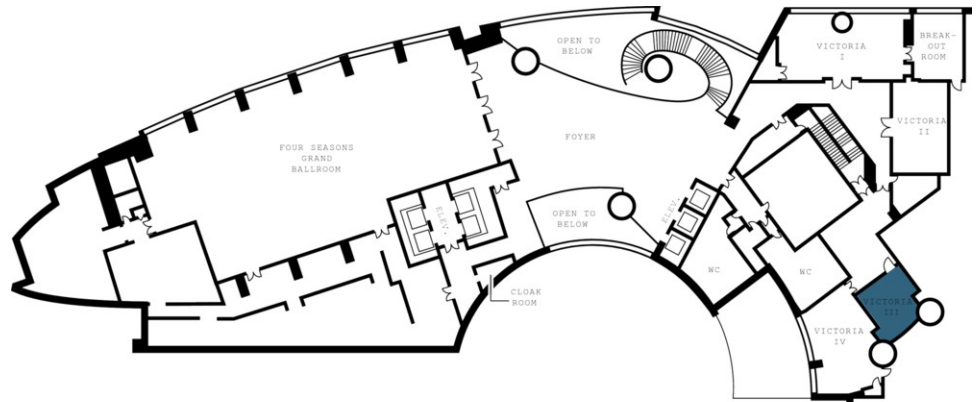

**VICTORIA IV**

Dimensions	7 x 10 m 23 x 32.8 ft
Size	70 m <sup>2</sup> 753 sq.ft.
Height	3 m 10 ft

*Capacities*

Classroom	30
Hollow square	20
U Shape	21
Theatre	60
Reception	70
Banquet Rounds	36

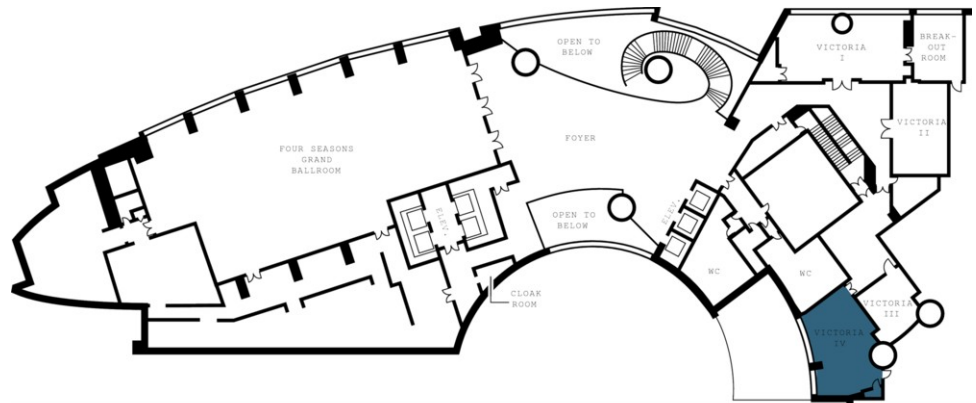

**HARBOUR VIEW BALLROOM**

Dimensions	12 x 38 m
	39.4 x 124.7 ft
Size	456 m <sup>2</sup>
	4,908 sq.ft.
Height	7 m
	23 ft

*Capacities*

Classroom	192
Hollow square	108
U Shape	96
Theatre	360
Reception	500
Banquet Rounds	264

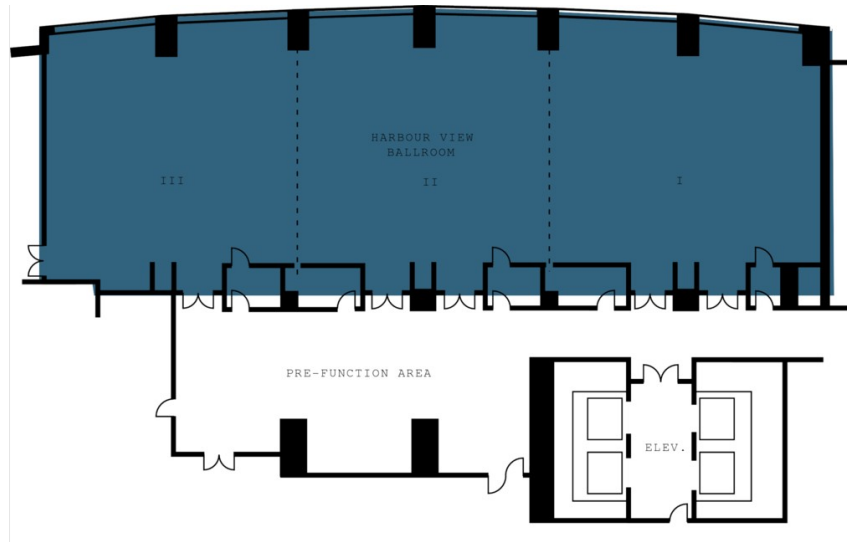

**HARBOUR VIEW BALLROOM PRE-FUNCTION AREA**

Dimensions	8 x 19 m
	26.3 x 62.3 ft
Size	152 m <sup>2</sup>
	1,636 sq.ft.
Height	3 m
	10 ft

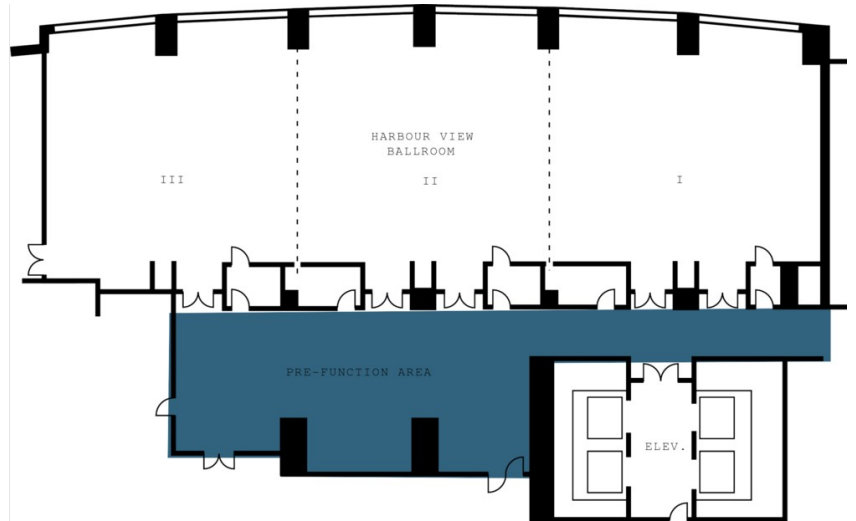

**HARBOUR VIEW BALLROOM I**

Dimensions	12 x 12.5 m
	39.4 x 41 ft
Size	150 m <sup>2</sup>
	1,614 sq.ft.
Height	7 m
	23 ft

*Capacities*

Classroom	72
Hollow square	48
U Shape	36
Theatre	120
Reception	150
Banquet Rounds	96

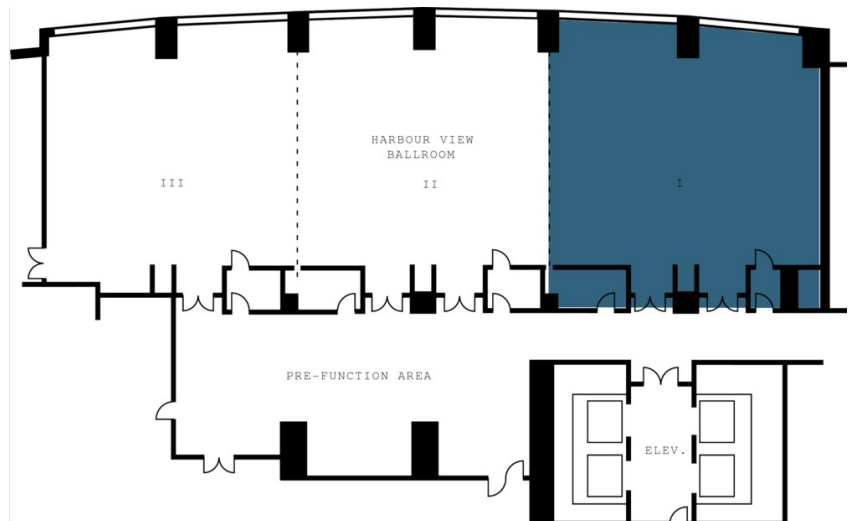

**HARBOUR VIEW BALLROOM II**

Dimensions	12 x 12.7 m 39.4 x 41.6 ft
Size	152 m <sup>2</sup> 1,636 sq.ft.
Height	7 m 23 ft

*Capacities*

Classroom	72
Hollow square	48
U Shape	36
Theatre	120
Reception	150
Banquet Rounds	96

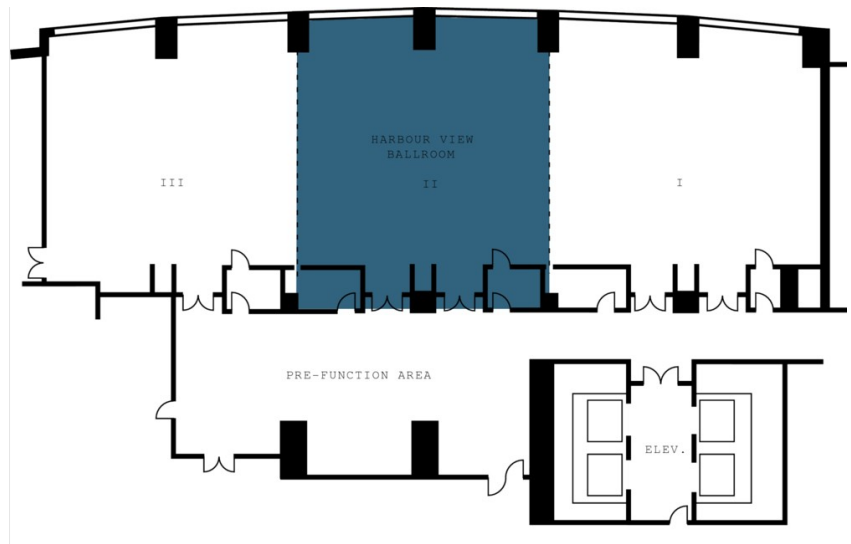

**HARBOUR VIEW BALLROOM III**

Dimensions	11.6 x 12 m 38.1 x 39.4 ft
Size	140 m <sup>2</sup> 1,507 sq.ft.
Height	7 m 23 ft

*Capacities*

Classroom	66
Hollow square	48
U Shape	36
Theatre	120
Reception	150
Banquet Rounds	96

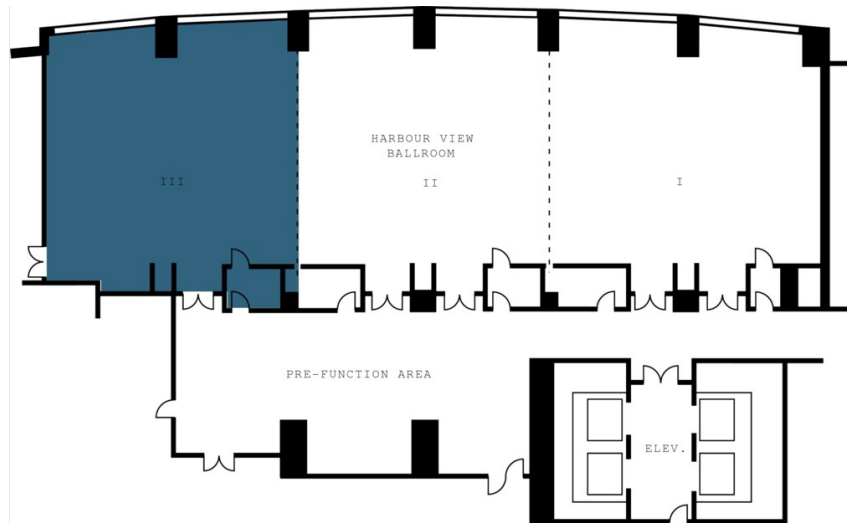

**BOARDROOM I**

Dimensions	4.5 x 10.5 m 14.8 x 34.5 ft
Size	47 m <sup>2</sup> 506 sq.ft.
Height	3 m 10 ft

*Capacities*

Classroom	30
Theatre	42
Reception	45
Banquet Rounds	24
Boardroom	24

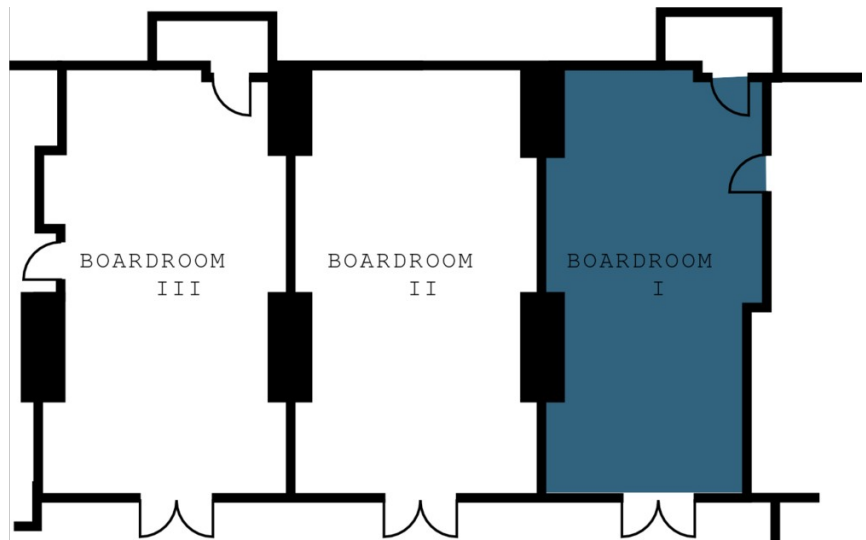

**BOARDROOM II**

Dimensions 5 x 10.5 m  
16.4 x 34.5 ft  
Size 52 m<sup>2</sup>  
560 sq.ft.  
Height 3 m  
10 ft

*Capacities*

Classroom 30  
U Shape 18  
Theatre 48  
Reception 50  
Banquet Rounds 24  
Boardroom 24

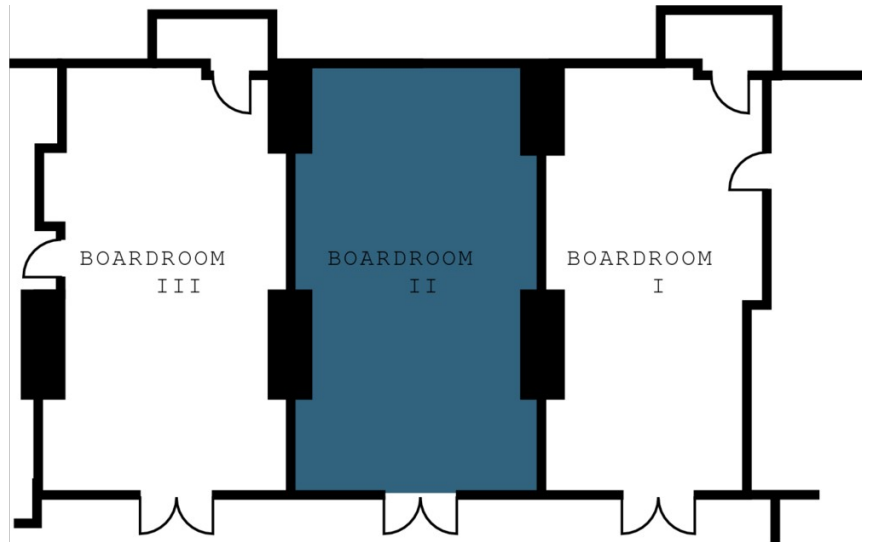

**BOARDROOM III**

Dimensions 5 x 10.5 m  
16.4 x 34.5 ft  
Size 52 m<sup>2</sup>  
560 sq.ft.  
Height 3 m  
10 ft

*Capacities*

Classroom 30  
U Shape 18  
Theatre 48  
Reception 50  
Banquet Rounds 24  
Boardroom 24

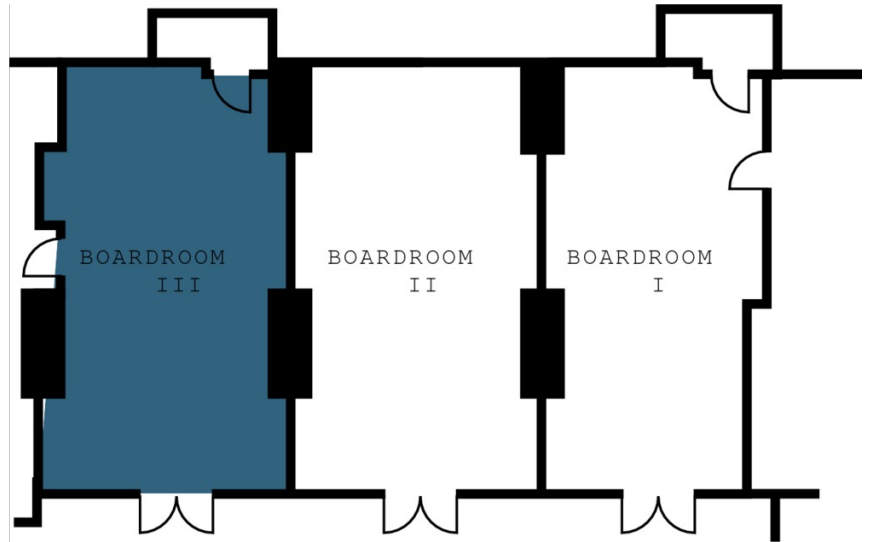

**PEAK SUITE**

Dimensions 8.9 x 18.6 m  
29.2 x 61 ft  
Size 165 m<sup>2</sup>  
1,776 sq.ft.  
Height 2.8 m  
9.2 ft

*Capacities*

Classroom 24  
Hollow square 30  
U Shape 24  
Theatre 50  
Reception 60  
Banquet Rounds 48

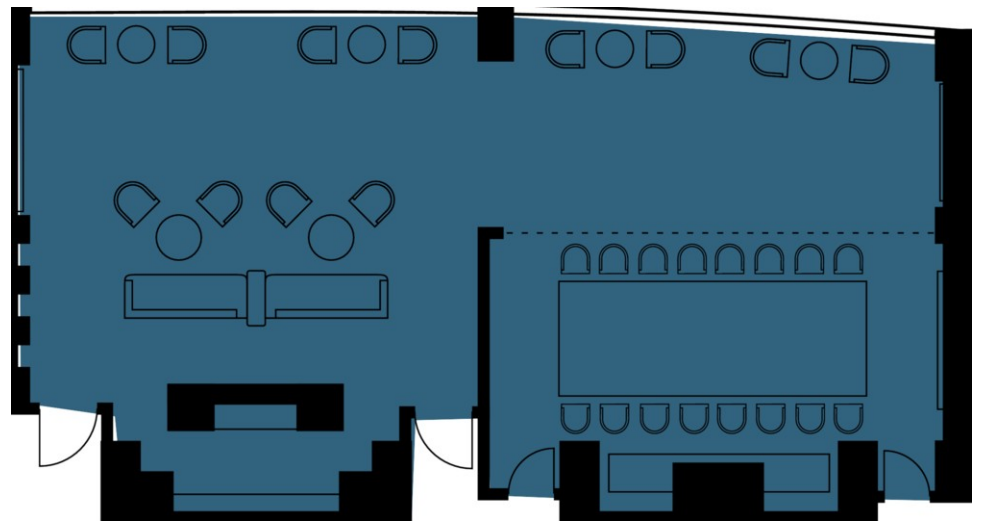

### GUEST ROOMS, SUITES AND PRIVATE RESIDENCES OVERVIEW

Located on floors 9 through 43, Four Seasons Hotel Hong Kong offers 399 guest rooms, including 54 suites. Wall-to-wall windows provide captivating vistas of the city, Victoria Harbour, Kowloon and the Peak. Sumptuously comfortable, accommodations are furnished in either sleek Western style, with silk-panelled walls and marble-floored entry foyers, or contemporary Chinese style, with sculpted furnishings, gold leaf and authentic ink paintings.

Each room is equipped with two direct-dial, dual-line speakerphones with voice mail, high-speed Internet access, a 106-centimetre (42-inch) plasma television and a DVD player. Standard amenities include comfortable Four Seasons beds, a built-in safe and a fully stocked bar. The ensuite marble bathroom features a deep-soaking tub, separate walk-in rain shower, separate WC with telephone, and a built-in LCD television with speakers.

<i>Room Category</i>	<i>#</i>	<i>Beds</i>	<i>Size</i> <i>(m<sup>2</sup>)</i>	<i>Size</i> <i>(sq ft)</i>	<i>View</i>
- Premier Deluxe Harbour-View Room	48	1 King, 2 double or 2 twin	45	484	Victoria Harbour and Kowloon
- Deluxe Harbour-View Room	173	1 King, 2 double or 2 twin	45	484	Victoria Harbour and Kowloon
- Deluxe Peak-View Room	124	1 King, 2 double or 2 twin	45	484	Victoria Peak and the city
- Presidential Suite	1	1 King	319	3,430	Panoramic views of Victoria Harbour and Kowloon
- Premier Suite	1	1 King	228	2,456	Panoramic views of Victoria Harbour and Kowloon
- Deluxe Suite	5	1 King	150	1,614	Victoria Harbour and Kowloon
- Harbour-View Suite	16	1 King or 2 double	91	981	Victoria Harbour and Kowloon
- Four Seasons Executive Suite	31	1 King	68	732	Panoramic views of Victoria Harbour and Kowloon

#### *Guest Room Overview*

Starting at 45 square metres (484 square feet), Four Seasons has some of the most spacious rooms in the city. With high ceilings and large windows, the Deluxe Peak-View Rooms look over Victoria Peak and the city, while views from the Deluxe Harbour-View Rooms take in Victoria Harbour and Kowloon. Premier Deluxe Harbour-View Rooms provide a more elevated perspective of the harbour and Kowloon.

#### *Suites Overview*

Four Seasons Hotel Hong Kong features 54 suites with fascinating views of Victoria Harbour. All have a fax/printer/copier/scanner, a guest powder room and, in the master bedroom, a 106-centimetre (42-inch) plasma satellite television and a walk-in closet. Select suites also include complimentary access to the exclusive Executive Club Lounge. Four Seasons Executive Suites are corner suites, filled with natural light from oversized windows. Perfect for privacy and relaxation, Harbour-View Suites offer an elegant living room separated by double doors from an exceptionally spacious bedroom. On higher floors of the Hotel, the elegant Deluxe Suites feature an extra-large living room

that provides the utmost in privacy for business, entertainment or relaxation. The décor of the 42nd-floor Premier Suite is an exotic blend of contemporary and Asian. The suite includes an expansive living room, a separate study, dining for eight guests, and a steam room in the spacious marble bathroom. On the 43rd floor, the magnificent Presidential Suite features a grand foyer, an extra-spacious living and entertainment area, a formal dining room for 14 guests, an adjacent pantry, a separate study for work or private meetings, a wellness room and an oversized master bedroom.

#### *Executive Club*

Enjoy added privileges in the light and airy environment of the Executive Club Lounge on the 45th floor. Around the clock, our attentive staff is available to provide personalised services from last-minute garment pressing to setting up an urgent business meeting. After a busy day in the city, the lounge is also the perfect place to relax and unwind with an evening cocktail and a light supper buffet, while admiring spectacular views of Victoria Harbour.

Guests are welcome to experience enhanced services in the Executive Club for a fee. Club access is included with the booking of selected suites.

Executive Club services feature:

- Express check-in and check-out
- Hot breakfast buffet, afternoon tea, all-day refreshments, a light supper buffet with a hot noodle station and cocktails in the Executive Club Lounge
- Garment pressing service (up to six garments per day)
- Complimentary in-room local calls
- Complimentary in-room high-speed Internet access
- 24-hour personalised business and concierge services
- Complimentary private use of the boardroom for one-hour per stay, based on availability

Rates for Executive Club enhanced services:

- HKD 1,200 per night for up to two people
- Children aged 11 and under to be accompanied by an adult – complimentary

FOUR SEASONS EXECUTIVE SUITE

Number 31  
Beds King bed  
Size 68 m<sup>2</sup>  
732 sq ft

Location

9th to 43rd floors

View

Panoramic views of Victoria Harbour  
and Kowloon

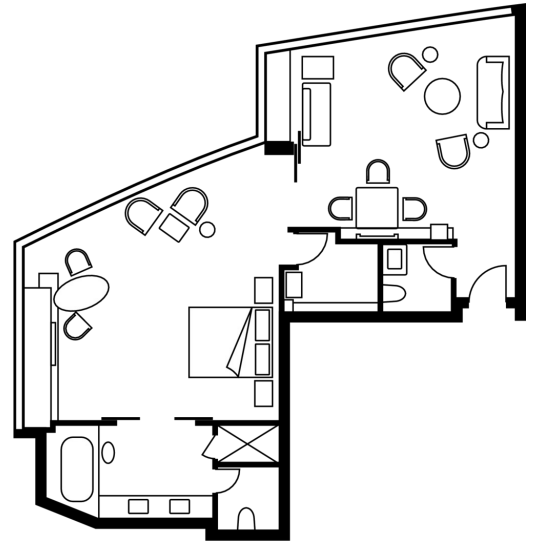

PREMIER DELUXE HARBOUR-VIEW  
ROOM

Number 48  
Beds One king, two double or  
two twin beds  
Size 45 m<sup>2</sup>  
484 sq ft

Location

33rd to 43rd floors

View

Victoria Harbour and Kowloon

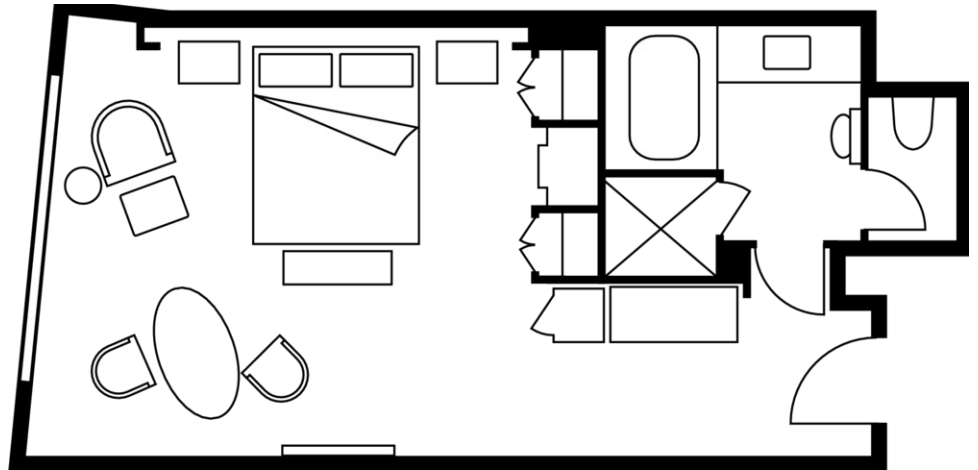

DELUXE HARBOUR-VIEW ROOM

Number 173  
Beds One king, two double or  
two twin beds  
Size 45 m<sup>2</sup>  
484 sq ft

Location

9th to 32nd floors

View

Victoria Harbour and Kowloon

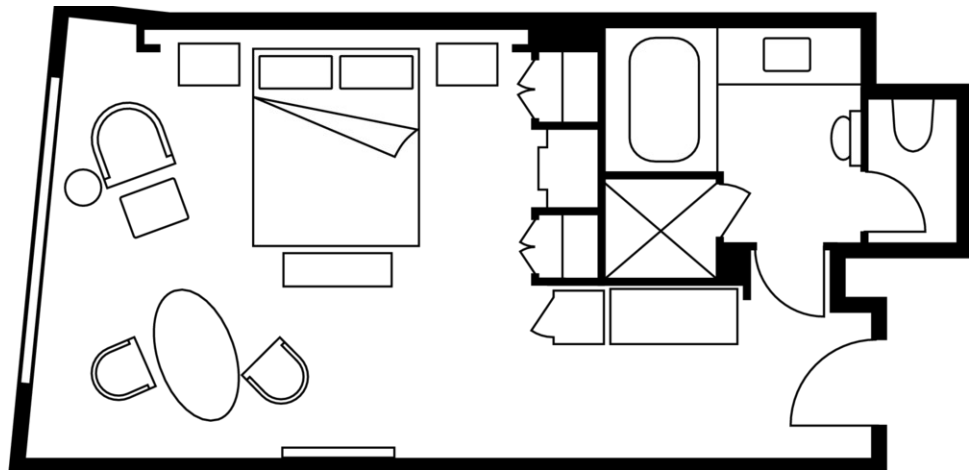

**DELUXE PEAK-VIEW ROOM**

Number 124  
Beds One king, two double or  
two twin beds  
Size 45 m<sup>2</sup>  
484 sq ft

*Location*

9th to 43rd floors

*View*

Victoria Peak and the city

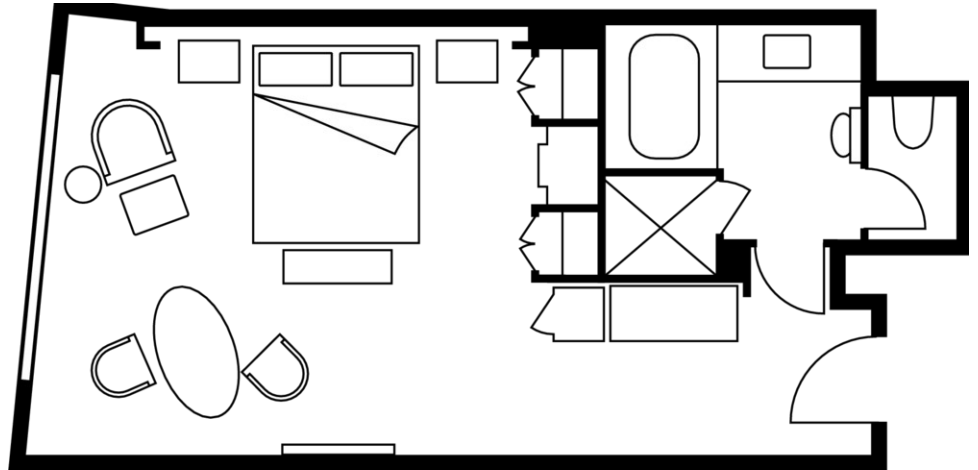

**PRESIDENTIAL SUITE**

Number 1  
Beds King bed  
Size 319 m<sup>2</sup>  
3,430 sq ft

*Location*

43rd floor

*View*

Panoramic views of Victoria Harbour  
and Kowloon

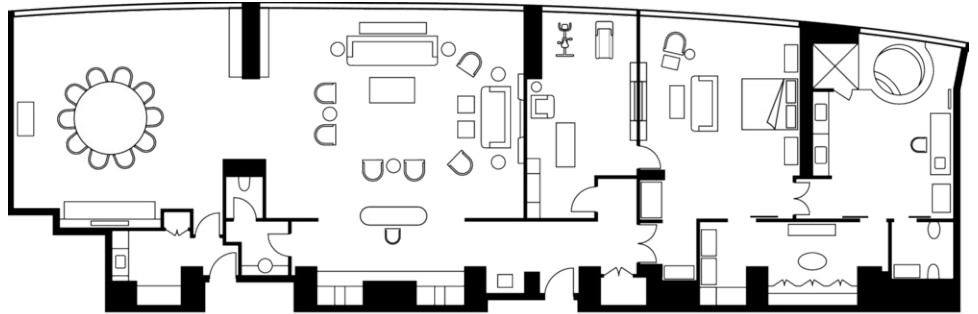

**PREMIER SUITE**

Number 1  
Beds King bed  
Size 228 m<sup>2</sup>  
2,456 sq ft

*Location*

42nd floor

*View*

Panoramic views of Victoria Harbour  
and Kowloon

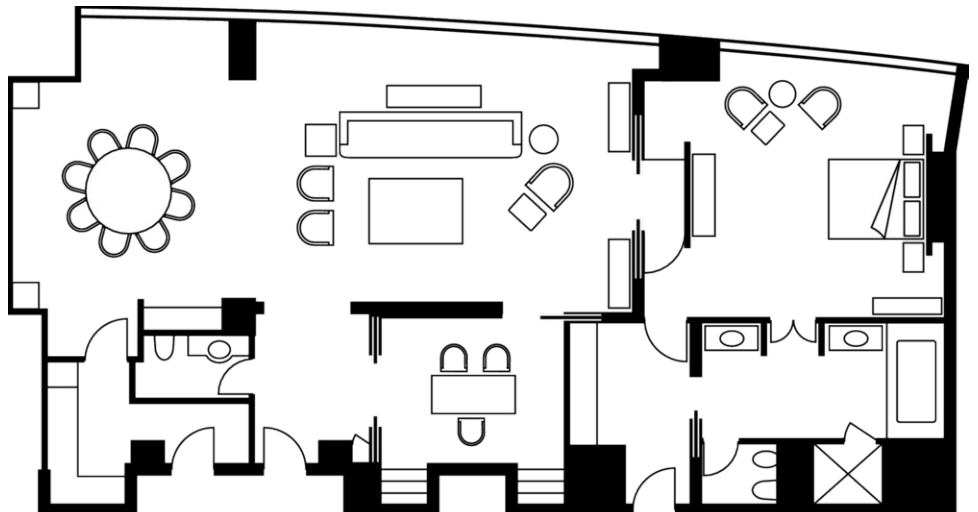

DELUXE SUITE

Number 5  
Beds King bed  
Size 150 m<sup>2</sup>  
1,614 sq ft

Location

37th to 41st floors

View

Victoria Harbour and Kowloon

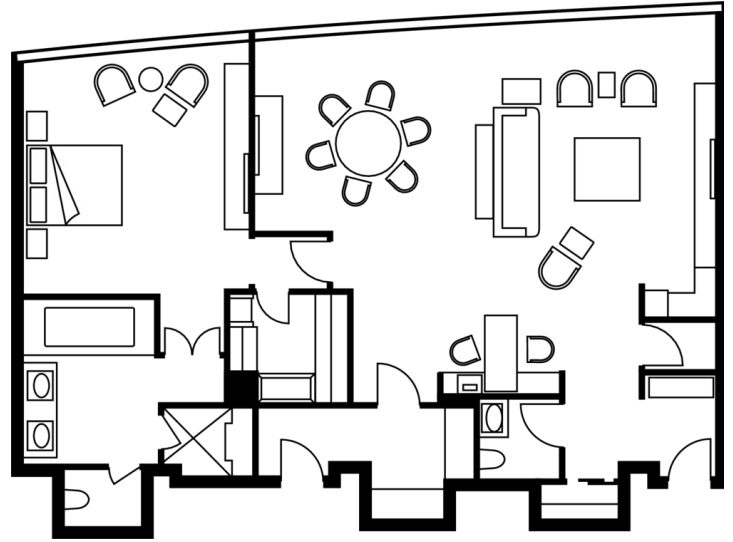

HARBOUR-VIEW SUITE

Number 16  
Beds King or two double beds  
Size 91 m<sup>2</sup>  
981 sq ft

Location

25th to 41st floors

View

Victoria Harbour and Kowloon

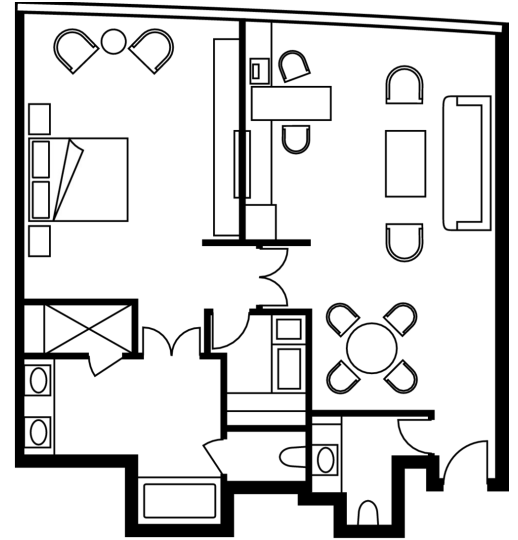

#### AMENITIES

- Cotton bathrobes
- DVD player
- Hair dryer
- In-room safe
- Interactive television
- Multi-line telephone(s) with voicemail
- Plasma/LCD screen television
- Satellite television
- Twice-daily housekeeping service
- Wired or wireless Internet access

#### GUEST SERVICES

- 24-hour In-Room Dining
- 24-hour laundry/dry-cleaning/pressing
- 24-hour multilingual Concierge
- International newspapers
- Limousine service
- One-hour pressing
- Restaurant
- Services and amenities for younger guests

#### VIP GIFTS AND WELCOME AMENITY

Special arrangements can be made for clients to purchase welcome amenities for their VIP guests. The Concierge will be happy to assist with these arrangements. Possibilities range from bottles of fine wine and champagne to deluxe fruit baskets, fresh flowers, gourmet chocolates or a Four Seasons Hotel Hong Kong spa treatment.

---

---

DINING HOURS OF OPERATION

*Caprice*

Lunch	noon - 2:30 pm
Dinner	6:00 pm - 10:30 pm

*Lung King Heen*

*Lunch*

Sundays and public holidays	11:30 am - 3:00 pm
Monday to Saturday	noon - 2:30 pm

*Dinner*

Every day	6:00 pm - 10:30 pm
-----------	--------------------

*The Lounge*

January 20 - 28 and from April 1, 2012

Breakfast	6:30 am - 11:00 am
All-day dining	11:00 am - 11:30 pm
Afternoon tea	3:00 pm - 5:30 pm
Drinks	11:00 am - midnight

January 3 - 19 and January 29 - March 30, 2012

Breakfast (Monday to Friday)	7:30 am - 11:00 am
(Saturday and Sunday)	6:30 am - 11:00 am
All day menu (Sunday to Thursday)	11:00 am - 10:30 pm (last order 9:45 pm)
(Friday and Saturday)	11:00 am - 11:30 pm
Afternoon tea	3:00 pm - 5:30 pm
Drinks (Sunday to Thursday)	11:00 am - 10:00 pm
(Friday and Saturday)	11:00 am - midnight

*Pool Terrace*

Breakfast (weekends during the warmer months)	7:00 am - 11:00 am
Lunch	11:00 am - 6:00 pm
Beverages	10:00 am - 9:30 pm

*Inagiku at ifc*

Lunch	11:30 am - 3:00 pm
Dinner	6:00 pm - 11:00 pm

*Blue Bar*

*Breakfast*

Monday to Friday	7:00 am - 10:00 am
Saturday, Sunday and public holidays	7:00 am - 11:00 am

*Lunch*

Every day	noon - 2:30 pm
-----------	----------------

[www.fourseasons.com/hongkong](http://www.fourseasons.com/hongkong)

DINING

From its extraordinary waterfront location, Four Seasons Hotel Hong Kong offers some of the city's most sought-after dining experiences with internationally recognised standards for service and cuisine. The classically elegant Caprice, with three Michelin stars, offers authentic French cuisine in an open-kitchen setting. The restaurant boasts three private dining rooms with seating for up to 16 guests, and the Caprice cellar offers exclusive wine and cheese tastings. Contemporary Cantonese fare prepared from fresh local delicacies is served at Lung King Heen, with three Michelin stars, and features silver and glass accents to reflect Hong Kong's glittering skyline, and a private dining room for 14.

Adjacent to the lobby's six-storey glass-walled atrium, natural light streams into The Lounge, an intimate space for small business and social occasions. An ultra chic meeting spot on the lobby level, Blue Bar is the place to unwind. At Inagiku at ifc, located adjacent to the Hotel and independently operated, every dish is prepared in the traditional Japanese way. Dine in one of the four private dining rooms, each with its own Teppanyaki counter, or at the separate sushi, Teppanyaki and Tempura bars, where watching the chefs prepare these delectable dishes is part of the enjoyment. Guests can also enjoy In-Room Dining, 24 hours a day.

RESTAURANTS

*Caprice*

With superb views over Victoria Harbour and the Kowloon Peninsula from its location on the sixth floor, Caprice's stunning surroundings feature Chinese-inspired Czech crystal chandeliers. With an open kitchen that provides a show of chefs at work, the restaurant offers contemporary French cuisine accompanied by the finest French wines, as well as other European and New World wines from renowned vineyards. Another highlight is the exclusive Caprice cellar, with Hong Kong's widest selection of artisanal French cheeses. Caprice also offers an adjoining bar and lounge area for cocktails, and three private dining rooms with seating for up to 12 guests.

- Cuisine: French
- Special features: The first French restaurant in Hong Kong to receive three prestigious Michelin stars
- Indoor seating: 108

*Lung King Heen*

Lung King Heen – View of the Dragon – commands spectacular harbour views from its fourth-floor location, and offers contemporary Cantonese cuisine at its best – created from the freshest local ingredients by a team of regionally renowned chefs. Enhancing the dining experience, silver and glass accents – including an undulating silver-leaf ceiling – reflect Hong Kong's glittering skyline and harbour lights. A private dining room for 14 offers the perfect setting for business entertainment or special family celebrations.

Michelin three-star Chinese restaurant, Lung King Heen, is led by Executive Chef Chan Yan Tak. As the first Chinese chef to receive three Michelin stars, Chef Chan is the master behind the intricately designed menu at Lung King Heen. Chef Chan combines textures and flavours coupled with inventive presentation to excite the taste buds and satisfy the most demanding epicure.

- Cuisine: Cantonese
- Special features: Lung King Heen is the first Chinese restaurant in the world to receive

three Michelin stars.

- Indoor seating: 128

#### *The Lounge*

Adjacent to the dramatic glass-walled atrium of the Hotel lobby, The Lounge is filled with natural light that streams through large floor-to-ceiling windows. Echoing the lobby's design – with curving planes, luminescent metallic rays and contrasting timber panelling – The Lounge offers an intimate space for small business and social occasions. *Allium*, a sculpture by English artist Ruth Moilliet, provides a focal point, and is one of many unique art pieces in the Hotel's extensive collection. This all-day venue offers a menu of Western and Asian favourites, afternoon tea and pastries, and premium snack items in the evening, all accompanied by piano music during the day and a jazz trio at night.

- Indoor seating: 84

#### *Pool Terrace*

The Pool Terrace provides a welcome oasis for Hotel guests, with its resort-like atmosphere and spectacular views of Victoria Harbour. Light meals and snacks can be enjoyed, as well as healthy smoothies and frozen cocktails.

- Outdoor seating: 72

#### *Inagiku at ifc*

Located adjacent to the Hotel and independently operated, Inagiku at ifc in Hong Kong is inspired by the cuisine of Executive Chef Shigeru Tanigawa. Inagiku at ifc displays the refined elegance of Japanese culture in every dish, from the restaurant's famous tempura to other classic favourites including kaiseki, sashimi, sushi and teppanyaki. The restaurant offers four private dining rooms, each with its own teppanyaki counter. Or guests can dine at the separate sushi, teppanyaki and tempura bars, where watching the chefs prepare these delectable dishes is part of the enjoyment.

- Cuisine: Japanese
- Indoor seating: 160, including 50 in the private dining rooms

### LOUNGES

#### *Blue Bar*

An ultra-chic meeting spot on the lobby level, Blue Bar offers wines, cocktails and views of Victoria Harbour. It features a wide selection of premium liquors and champagnes, fine wines served by the glass, and an extensive array of classic and contemporary cocktails. Breakfast and lunch are also available at Blue Bar.

- Indoor seating: 54, with 8 at the bar

## RECREATION FACILITIES

Four Seasons Hotel Hong Kong is the perfect urban refuge to call home while enjoying one of the world's most dynamic cities. The 24-hour fitness centre offers the latest in cardiovascular equipment and unsurpassed views over Victoria Harbour. With 16 luxurious treatment rooms, the spa provides the ultimate in pampering, while the open-air pool terrace is a tranquil oasis with its free-form infinity-edge pool, lap pool, plunge pool and whirlpool. For off-site activities, from a game of golf or tennis to a mountain hike, the Four Seasons Concierge can take care of all the arrangements.

### *Executive Club*

Enjoy added privileges in the light and airy environment of the Executive Club Lounge on the 45th floor. Around the clock, our attentive staff is available to provide personalised services from last-minute garment pressing to setting up an urgent business meeting. After a busy day in the city, the lounge is also the perfect place to relax and unwind with an evening cocktail and a light supper buffet, while admiring spectacular views of Victoria Harbour.

Guests are welcome to experience enhanced services in the Executive Club for a fee. Club access is included with the booking of selected suites.

Executive Club services feature:

- Express check-in and check-out
- Hot breakfast buffet, afternoon tea, all-day refreshments, a light supper buffet with a hot noodle station and cocktails in the Executive Club Lounge
- Garment pressing service (up to six garments per day)
- Complimentary in-room local calls
- Complimentary in-room high-speed Internet access
- 24-hour personalised business and concierge services
- Complimentary private use of the boardroom for one-hour per stay, based on availability

Rates for Executive Club enhanced services:

- HKD 1,200 per night for up to two people
- Children aged 11 and under to be accompanied by an adult – complimentary

### SPA SERVICES

The Spa at Four Seasons redefines relaxation and rejuvenation in a bright, contemporary environment perfected by signature Four Seasons service. This luxurious urban sanctuary comprises 17 treatment rooms, including two lavish spa suites, Aqua and Crystal. Each spa suite features a vitality pool for two, a daybed, an LCD television and a private bar. A private bathroom and rain shower are available in the spa suites and most of the treatment rooms.

Upon arrival, retreat to your individual spa room or choose from a unique blend of aquatic experiences in the Vitality Lounge, including a Finnish sauna and steam in the men's area, a soft sauna, crystal steam and rhassoul chamber in the women's area, or an indoor vitality pool. Specially designed pedicure lounges have built-in foot baths and a selection of music and television channels on a private television set for your added

enjoyment.

- Size: 2,044 m<sup>2</sup> / 22,000 sq ft
- Number of treatment rooms: 17

#### FITNESS FACILITIES

The 24-hour Fitness Centre overlooks spectacular Victoria Harbour from floor-to-ceiling windows. It offers the latest in cardiovascular equipment – with each machine featuring an individual LCD touch-screen television and headphones – as well as an extensive selection of weight-training machines and free weights.

Tai chi classes are also available. Please enquire at the Fitness Centre for details.

- Size: 500 m<sup>2</sup> / 5,382 sq ft

#### POOL

Providing a calm oasis from the bustling activities of the city are the Hotel's pools. Enjoy a leisurely swim in the free-form infinity-edge pool, exercise in the lap pool and then take a cool dip in the plunge pool – or simply take in the magnificent harbour views from the whirlpool. The infinity-edge pool, heated in winter, and lap pool are equipped with speakers so swimmers can enjoy music underwater.

Drinks and light snacks are served on the open-air Pool Terrace, which offers guests a resort-like setting to relax and enjoy the expansive views of Victoria Harbour. For added convenience, the pool is equipped with telephones and wireless Internet access.

#### GOLF

##### *The Hong Kong Golf Club at Deep Water Bay and Fanling*

The Hong Kong Golf Club, opened in 1889, is recognised as one of the world's most exclusive golf clubs, and has hosted a long list of international and Asian tournaments. The Club has a 9-hole course in Deep Water Bay on Hong Kong Island and three 18-hole golf courses in Fanling, New Territories. Visitors are welcome from Monday to Friday (except public holidays). Advance booking is recommended.

##### *The Jockey Club Kau Sai Chau Public Golf Club*

Guests may play golf at the Kau Sai Chau Public Golf Club in Sai Kung, New territories. The club has three 18-hole courses, over 60 driving range bays lit for night play, putting green, chipping and bunker areas. Visitors are welcome from Monday to Friday. Advance booking is recommended.

#### TENNIS

##### *Victoria Park Tennis Centre*

Victoria Park in Causeway Bay is the largest park on Hong Kong island, with six standard tennis courts available for rent to the public. The Tennis Centre Court, with a spectator seating capacity of 3,611, has been host to numerous international tournaments since 1981.

##### *Hong Kong Tennis Centre*

The Hong Kong Tennis Centre in Happy Valley welcomes visitors to use their six public courts. Reservations are recommended.

#### JOGGING

For those keen on keeping fit, the island offers jogging paths. Enjoy the outdoors and a relaxed environment, right in the city. If you go for an early morning run, you'll likely encounter locals, young and old, practising the Chinese martial art of tai chi.

*Hong Kong Park*

Located behind Pacific Place shopping complex near Central District, this 8-hectare (19.8-acre) park has paths for early morning walking or jogging. Along the way you'll have views of a pond with colourful goldfish, landscaped gardens, an aviary and waterfalls.

*The Peak Circle Walk*

This path, high above the harbour, is a great way to combine a workout with sightseeing. Starting from The Peak Tower, the path takes you along the mountainside, overlooking Kowloon peninsula, Victoria Harbour and the skyscrapers of Central. As you progress, the view changes from cityscape to the verdant valleys and the reservoir of island south. In the distance are outlying islands and the South China Sea. After 3.5 kilometres (2.2 miles), you are back at your starting point.

## INCENTIVE ACTIVITIES

Four Seasons is pleased to help customise itineraries for your group or party. Experience the vibrancy of Hong Kong's sights and sounds, or simply savour its spectacular harbour views. Following is a sample group itinerary. We invite you to discuss your needs with us.

### *Sample Itinerary*

---

#### Day 1

##### Arrival at Hotel

After arrival, relax and refresh:

- Work out in the fitness centre.
- Enjoy a massage or rejuvenating body treatment in the Spa.
- Savour dim sum in Lung King Heen restaurant.

##### Afternoon

Choose from:

- Shopping in the adjacent IFC Mall
- An appointment with a local tailor to order custom-made suits and shirts

##### Evening

Join us at a "Welcome to Hong Kong" reception in the Peak Suite; savour the Suite's sweeping views over the city and Victoria Peak.

---

#### Day 2

##### Morning

Breakfast at leisure, then choose from:

- Tour Hong Kong Island – discover its fascinating history, today's cosmopolitan way of life and its exciting future.
- Visit Hong Kong's highlights – the Peak, Repulse Bay, Stanley Market and Aberdeen Fishing Village.
- Lunch – enjoy the views from Café Deco at the Peak, or the delights of a local restaurant.

##### Afternoon

Choose from:

- At leisure in the Hotel – lounge beside the pool, work out in the fitness centre or receive a pampering treatment in the spa.
- Go on a self-guided tour of Hong Kong.

##### Evening

Savour an elegant dinner at the Michelin three star Caprice or the Michelin three star Lung King Heen, two of the most popular restaurants in Hong Kong.

---

#### Day 3

##### Day

Breakfast at leisure, then choose from:

- Take a full day off the beaten track in Kowloon – visit the Flower Market, Jade Market, Ladies' Market, Bird Garden and Wong Tai Sin Temple.
- Explore Wetland Park, a world-class eco-tourism attraction.
- Visit the Ngong Ping 360 cable car on Lantau Island.

- Spend the day hiking in the outlying islands or along part of the Hong Kong Trail.

Evening

An evening at Happy Valley – enjoy a fun-filled night at one of Asia's most sophisticated racetracks.

---

Day 4

Day

Breakfast at leisure, then choose from:

- Enjoy a breathtaking helicopter tour of Hong Kong.
- Visit Macau, only 55 minutes away by jetfoil, or 20 minutes by helicopter.
- Tour the New Territories for a full day, with stops in rural villages and Po Lin monastery, home of the world's largest seated bronze statue of Buddha.
- Enjoy a day of golf.
- Take advantage of the Hotel's recreational facilities – the Spa, the pools or the fitness centre.

Evening

Bid farewell to Hong Kong at a gala dinner in the elegant Four Seasons Grand Ballroom. Enjoy either imaginatively prepared contemporary Western cuisine or a spectacular 12-course Chinese banquet.

---

Day 5

Morning

Breakfast at leisure, then choose from:

- Last-minute shopping
  - Spending the day at leisure until departure
-

Rooms	Dimensions		Size (m <sup>2</sup> )	Size (sq ft)	Height		Classroom	Hollow square	U-shape	Theatre	Reception	Banquet rounds	Conference/ boardroom
	(m)	(ft)			(m)	(ft)							
- Four Seasons Grand Ballroom	19 x 37.3	62.3 x 122.4	708	7,620	8	27	320	90	90	600	800	456	90
- Four Seasons Grand Ballroom Pre-function	10 x 25	32.8 x 82	250	2,690	2.8 - 8	9 - 26	-	-	-	-	-	-	-
- Victoria I	7.6 x 14	24.9 x 45.9	106	1,140	3	10	36	30	27	80	80	48	32
- Victoria II	6 x 10	19.7 x 32.8	60	645	3	10	24	20	16	50	60	24	18
- Victoria III	6 x 6	19.7 x 19.7	36	387	3	10	12	-	-	30	30	12	10
- Victoria IV	7 x 10	23 x 32.8	70	753	3	10	30	20	21	60	70	36	20
- Harbour View Ballroom	12 x 38	39.4 x 124.7	456	4,908	7	23	192	108	96	360	500	264	100
- Harbour View Ballroom Pre-function Area	8 x 19	26.3 x 62.3	152	1,636	3	10	-	-	-	-	-	-	-
- Harbour View Ballroom I	12 x 12.5	39.4 x 41	150	1,614	7	23	72	48	36	120	150	96	30
- Harbour View Ballroom II	12 x 12.7	39.4 x 41.6	152	1,636	7	23	72	48	36	120	150	96	30
- Harbour View Ballroom III	11.6 x 12	38.1 x 39.4	140	1,507	7	23	66	48	36	120	150	96	30
- Boardroom I	4.5 x 10.5	14.8 x 34.5	47	506	3	10	30	-	-	42	45	24	24
- Boardroom II	5 x 10.5	16.4 x 34.5	52	560	3	10	30	-	18	48	50	24	24
- Boardroom III	5 x 10.5	16.4 x 34.5	52	560	3	10	30	-	18	48	50	24	24
- Peak Suite	8.9 x 18.6	29.2 x 61	165	1,776	2.8	9.2	24	30	24	50	60	48	22